

Excellent Integrated System Limited

Stocking Distributor

Click to view price, real time Inventory, Delivery & Lifecycle Information:

[Molex Connector Corporation](#)
[0460550007](#)

For any questions, you can email us directly:
sales@integrated-circuit.com

NOTES:

1. MATERIAL: HIGH PERFORMANCE COPPER ALLOY
2. FINISH:
222 - OVERALL TIN: 100 MI MIN OVER NICKEL
228 - SELECT GOLD: 30 MI MIN
SELECT TIN: 100 MI MIN OVER NICKEL
3. PRODUCT SPECIFICATION: PS-46064-001
4. PACKAGING: REEL PACK PER: PK-46055-002
LOOSE PACK PER: PK-5556-003
5. TERMINAL TO BE USED WITH ASSY NUMBER: 46064
6. WIRE SPECIFICATION: SEE CHART.
7. WHEN USING OVERALL TIN PLATED TERMINALS: FOR APPLICATIONS INVOLVING VIBRATION AND/OR THERMAL CYCLING, MOLEX STRONGLY RECOMMENDS THE USE OF NYE LUBRICANT, NYE 760G, ON THE MATING END OF THE TERMINAL. LUBRICANT SHOULD BE APPLIED PRIOR TO INSERTION INTO THE HOUSING.

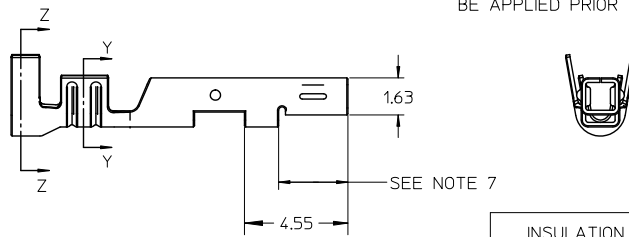
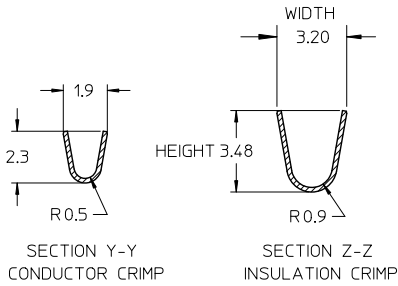
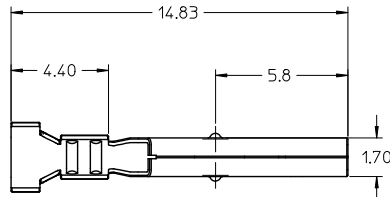
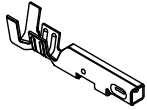

LOOSE PACKAGED MATERIAL NUMBER	REEL PACKAGED MATERIAL NUMBER	FINISH	WIRE SPEC	INSULATION DIA	INSULATION (CRIMPED)		CONDUCTOR (CRIMPED)					
					HEIGHT MIN	WIDTH MIN	HEIGHT MAX	WIDTH MAX	HEIGHT MIN	WIDTH MIN	HEIGHT MAX	WIDTH MAX
46055-0007	46055-0005	222 - TIN	UL1015 18/20 AWG	2.52 / 2.81	N/A	3.20	2.70	2.90	1.05	1.15	1.50	1.70
46055-0008	46055-0006	228 - SELECT GOLD	UL1015 18/20 AWG	2.52 / 2.81	N/A	3.20	2.70	2.90	1.05	1.15	1.50	1.70

UPDATE NOTE 4 EC NO: UCP2011-1228 DRWN: J JAGUILAR 2010/10/29 CHKD: APPR: FSMITH 2010/11/09 DESCRIPTION REV D2	QUALITY SYMBOLS	GENERAL TOLERANCES (UNLESS SPECIFIED)	DIMENSION STYLE MM ONLY	SCALE 4:1	DESIGN UNITS METRIC	THIRD ANGLE PROJECTION
	▽=0	4 PLACES ± --- ± ---	DRAWN BY KSAMIEC	DATE 2007/03/22	TITLE SEALED MINIFIT H20 RECEPTACLE TERMINAL	
	▽=0	3 PLACES ± --- ± ---	CHECKED BY	DATE		
	▽=0	2 PLACES ± 0.25 ± ---	APPROVED BY FSMITH	DATE 2010/11/09	MOLEX INCORPORATED	
	1 PLACE ± 0.38 ± ---	ANGULAR ± 3 °	MATERIAL NO.	DOCUMENT NO.	SHEET NO. 1 OF 1	
DRAFT WHERE APPLICABLE MUST REMAIN WITHIN DIMENSIONS		SEE CHART		SD-46055-001		