

Excellent Integrated System Limited

Stocking Distributor

Click to view price, real time Inventory, Delivery & Lifecycle Information:

[Hirose Electric Co Ltd](#)
[BM10NB\(0.8\)-20DS-0.4V\(75\)](#)

For any questions, you can email us directly:

sales@integrated-circuit.com

2010/01/12 08:11:26 CAROL TRIBBLE

DRAWING FOR REFERENCE: This is subject to change without notice

APPLICABLE STANDARD					
RATING	OPERATING TEMPERATURE RANGE	-35°C TO 85°C (NOTES 1)	STORAGE TEMPERATURE RANGE	-10°C TO 60°C	
	VOLTAGE	30V AC	APPLICABLE CONNECTOR	BM10*(0.8)-20DP-0.4V(**)	
	CURRENT	0.3A			
SPECIFICATIONS					
ITEM	TEST METHOD		REQUIREMENTS	QT	AT
CONSTRUCTION					
GENERAL EXAMINATION	CONFIRMED VISUALLY AND BY MEASURING INSTRUMENT.		ACCORDING TO DRAWING.	X	X
MARKING	CONFIRMED VISUALLY.			X	X
ELECTRIC CHARACTERISTICS					
CONTACT RESISTANCE	20mV AC OR LESS 1kHz,1mA .		100mΩ MAX.	X	-
INSULATION RESISTANCE	100V DC.		50MΩ MIN.	X	-
VOLTAGE PROOF	100V AC FOR 1 min.		NO FLASHOVER OR BREAKDOWN.	X	-
MECHANICAL CHARACTERISTICS					
INSERTION AND WITHDRAWAL FORCES	MEASURED BY APPLICABLE CONNECTOR.		①INSERTION FORCE :24.3 (N)MAX ②WITHDRAWAL FORCE :4.4 (N)MIN	X	-
MECHANICAL OPERATION	10TIMES INSERTIONS AND WITHDRAWALS.		①CONTACT RESISTANCE: 100mΩ MAX. ②NO DAMAGE, CRACK OR LOOSENESS OF PARTS.	X	-
VIBRATION	FREQUENCY 10 TO 55 TO 10 Hz,APPROX 5min, SINGLE AMPLITUDE 0.75 mm,10CYCLES, FOR 3 DIRECTIONS.		①NO ELECTRICAL DISCONTINUITY OF 1 μs. ②NO DAMAGE, CRACK OR LOOSENESS OF PARTS.	X	-
SHOCK	490 m/s ² DURATION OF PULSE 11 ms AT 3 TIMES FOR 3 DIRECTIONS.		①NO ELECTRICAL DISCONTINUITY OF 1 μs. ②NO DAMAGE, CRACK OR LOOSENESS OF PARTS.	X	-
ENVIRONMENTAL CHARACTERISTICS					
RAPID CHANGE OF TEMPERATURE	TEMPERATURE -55 → 85 °C TIME 30 → 30 min UNDER 5 CYCLES. (RELOCATION TIME TO CHAMBER: WITHIN 2 ~3 MIN)		①CONTACT RESISTANCE: 100mΩ MAX. ②INSULATION RESISTANCE: 50MΩ MIN. ③NO DAMAGE, CRACK OR LOOSENESS OF PARTS.	X	-
DAMP HEAT (STEADY STATE)	EXPOSED AT 40 ± 2 °C, 90 TO 95 %, 96 h.		①CONTACT RESISTANCE: 100mΩ MAX. ②INSULATION RESISTANCE: 25MΩ MIN. ③NO DAMAGE, CRACK OR LOOSENESS OF PARTS.	X	-
SULPHUR DIOXIDE	EXPOSED IN 25 PPM FOR 96h,25°C,75%. (REFER TO JIS C 60068)		①CONTACT RESISTANCE: 100mΩ MAX. ②NO DAMAGE, CRACK OR LOOSENESS OF PARTS.	X	-
	COUNT	DESCRIPTION OF REVISIONS	DESIGNED	CHECKED	DATE
REMARKS			APPROVED	KH. IKEDA	09.09.03
NOTE1: INCLUDE THE TEMPERATURE RISING BY CURRENT			CHECKED	TS. MIYAZAKI	09.09.03
Unless otherwise specified, refer to JIS C 5402 and IEC 60512			DESIGNED	SH. HOSODA	09.09.02
			DRAWN	SH. HOSODA	09.05.09
Note QT:Qualification Test AT:Assurance Test X:Applicable Test			DRAWING NO.		ELC4-318216-75
	SPECIFICATION SHEET		PART NO.	BM10NB(0.8)-20DS-0.4V(75)	
	HIROSE ELECTRIC CO., LTD.		CODE NO.	CL684-6105-4-75	1/1

DRAWING FOR REFERENCE: This is subject to change without notice

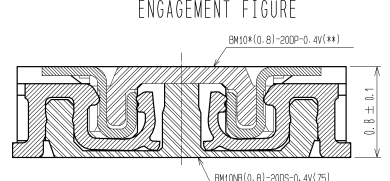
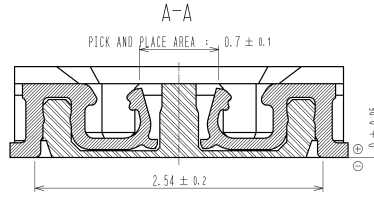
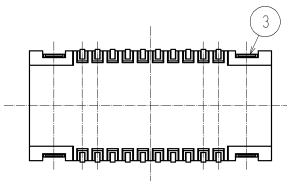
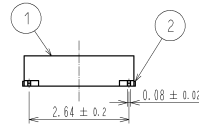
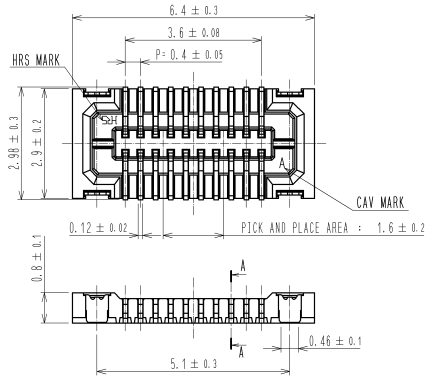

RECOMMENDED PATTERN

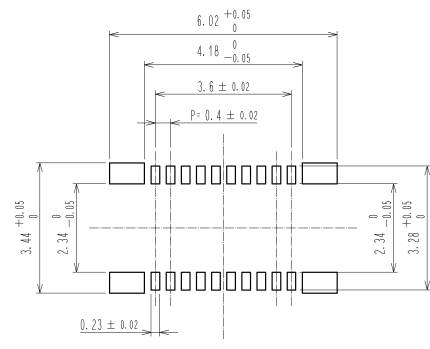

RECOMMENDED SOLDER PASTE: THICKNESS 120µm

- NOTE 1. ALL LEADS CO-PLANARITY SHALL BE 0.1 MAX.
 2. PER REEL : 8000 CONNECTORS.
 3. AT THE BEGINNING OF THE REEL, 100 mm AT MIN SHALL BE EMPTY POCKETS.
 AT THE END OF THE REEL, 160 mm AT MIN SHALL BE EMPTY.
 4. CONTACT PLATING SPECIFICATIONS.
 CONTACT AREA : GOLD 0.1µm MIN.
 SMT LEAD : GOLD 0.05µm MIN.
 UNDERPLATING : NICKEL 1µm MIN.
 (SURFACE : SEALING)
 5. METAL HOLD DOWN PLATING SPECIFICATIONS.
 MOUNTING AREA: GOLD 0.05µm MIN.
 UNDERPLATING : NICKEL 1µm MIN.
 6. PEEL FORCE OF COVER TAPE REFERS TO JIS C 0806.

3	PHOSPHOR BRONZE	5	PS	PLASTIC REEL (BLACK)			
2	PHOSPHOR BRONZE	4	5	POLYESTER CLEAR (COVER TAPE)			
1	LCP	UL94V-0, BLACK	4	PS CLEAR (EMBOSSED CARRIER TAPE)			
NO.	MATERIAL	FINISH, REMARKS	NO.	MATERIAL	FINISH, REMARKS		
UNITS	mm	SCALE FREE	COUNT	DESCRIPTION OF REVISIONS	DESIGNED	CHECKED	DATE
HIROSE ELECTRIC CO., LTD.		APPROVED: KH. IKEDA 09.08.03	DRAWING NO.	EDC3-318216-75			
		CHECKED: +S. MIYAZAKI 09.08.03	PART NO.	BM10NB(0.8)-20DS-0.4V(75)			
		DESIGNED: +SH. HOSODA 09.08.31	CODE NO.	CL684-6105-4-75			
		DRAWN: +SH. HOSODA 09.05.09					

2010/01/12 08:11:28 CAROL.TRI@BLE

DRAWING FOR REFERENCE: This is subject to change without notice

