

Excellent Integrated System Limited

Stocking Distributor

Click to view price, real time Inventory, Delivery & Lifecycle Information:

[Bel Fuse Inc.](#)
[943-SP-370808SM2-A467](#)

For any questions, you can email us directly:
sales@integrated-circuit.com

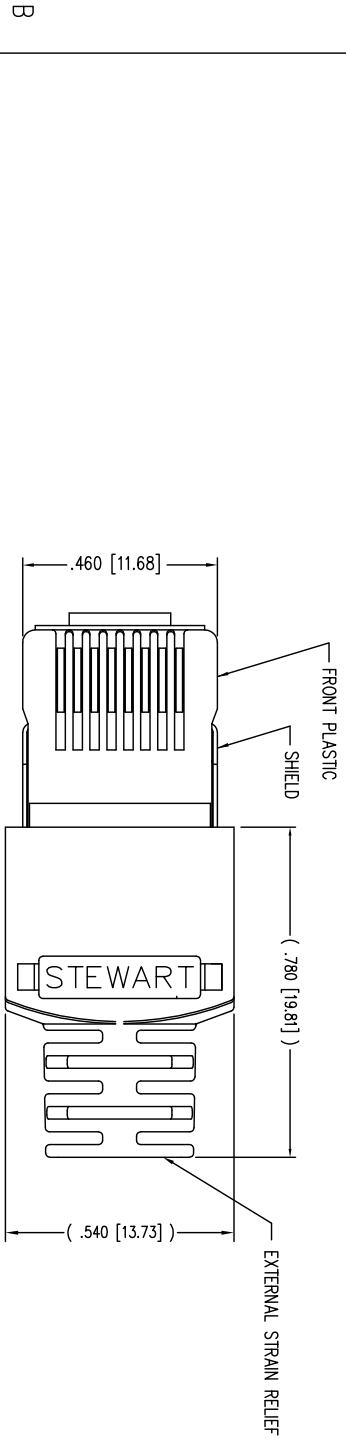

(SHOWN ASSEMBLED)

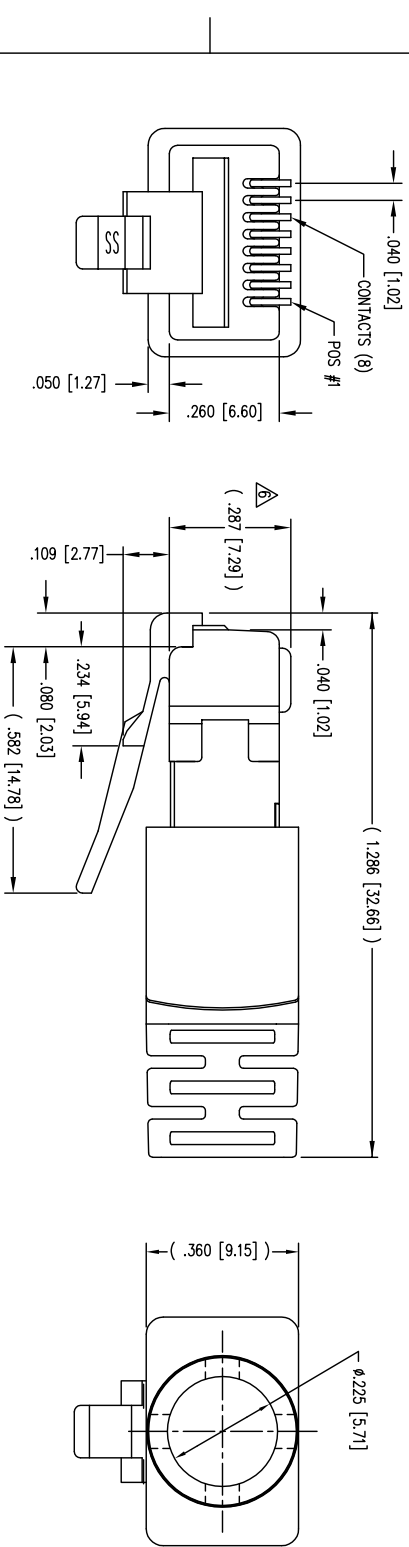

- NOTES:
- 1- PLUG KIT CONSISTS OF :
 PRE-INSERTED PLUG HOUSING & SHIELD
 MANAGEMENT BAR
 FERRULE
 HOUSING
 - 2- MATERIALS :
 FRONT HOUSING PLASTIC : CLEAR POLYCARBONATE
 MANAGEMENT BAR : CLEAR POLYCARBONATE
 SHIELD : TIN PLATED BRASS
 CONTACTS : PHOSPHOR BRONZE, SELECTIVE
 FERRULE : NICKEL OR TIN PLATED BRASS
 - 3- CONTACTS TERMINATE STRANDED & SOLID 0 TO .042 [1.07] OUTSIDE DIAMETER OF INSUL
 - 4- FOR PRODUCT SPECIFICATION SEE PRO26-0
 - 5- DIMENSIONS AND TOLERANCES COMPLY WITH
 Δ TERMINATED PLUG HEIGHT : .237 [6.02] ±.4
 - 7- DESIGNED FOR CATEGORY 5/5e APPLICATION

A

B

REV. 7/3/03

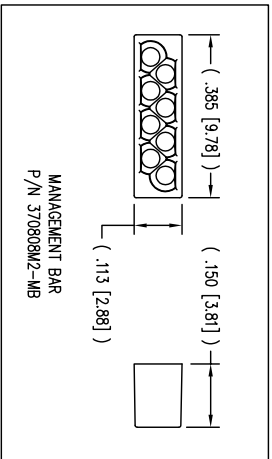
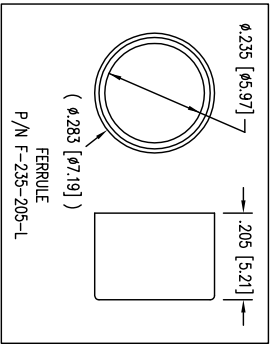

BULK	50 MICRO-INCHES [1.27um]	943-SP-370
PACKAGE	CONTACT PLATING IN MATING AREA	PART N

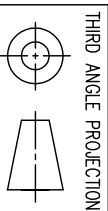

THIRD ANGLE PROJECTION
 DO NOT SCALE DRAWING
 DRAWING IS SUBJECT TO
 CHANGE WITHOUT NOTICE
 DIMENSIONS: INCHES [METRIC]

UNLESS OTHERWISE SPECIFIED
 TOLERANCES ARE ±.005 [0.13]
 ANGLES ARE ± 1°

SHEET NO. 1 OF 1

Bel Stewart Conn
 11118 Susquehanna Trail South
 Glen Rock, PA 17327-9199
 (717) 235-7512 Fax: (717) 235-7954 http://www.
 SHIELDED CAT 5 PLUG

THIS DRAWING AND THE SUBJECT MATTER SHOWN THEREON ARE
 CONFIDENTIAL AND THE PROPRIETARY PROPERTY OF BEL STEWART CONNECTOR
 AND SHALL NOT BE REPRODUCED, COPIED, OR USED IN ANY MANNER WITHOUT
 PRIOR WRITTEN CONSENT OF BEL STEWART CONNECTOR. THIS PRODUCT
 MAY BE PROTECTED BY ONE OR MORE OF THE FOLLOWING US PATENTS:
 5628647 7753717 8035853
 OTHER PATENTS MAY BE PENDING.

DRN BY:	D
APP'D BY:	D
DWG NO.:	C

DATE	RE
1/31/06	B
8/20/10	B
2-14-11	B
5-23-12	B