

## Excellent Integrated System Limited

Stocking Distributor

Click to view price, real time Inventory, Delivery & Lifecycle Information:

[FCI](#)  
[20020618-M021A01LF](#)

For any questions, you can email us directly:  
[sales@integrated-circuit.com](mailto:sales@integrated-circuit.com)



1 | 2

FCIconnect.com

3 |

4

PRODUCT NUMBER  
 20020618-MXXXXXL

20020618 — □ □ □ □ A 0 □ L F

PITCH  
 M: 7.62 mm

POLES  
 02: 2 POLES  
 03: 3 POLES  
 04: 4 POLES  
 16: 16 POLES

LF : DENOTED RoHS COMPATIBLE  
 1 : STANDARD PRODUCT  
 W/ BOX PACKING

HOUSING CODE		
CODE	COLOR	AVAILABILITY
1	GREEN(RAL 6018/T)	STANDARD
2	BLACK	ON REQUEST ONLY
3	GREY(RAL 7004/P)	ON REQUEST ONLY
4	BLUE(RAL 5015/A)	ON REQUEST ONLY

PROPERTY TABLE	
FCI SERIES NAME	07-762
PITCH (mm)	7.62
VOLTAGE RATING (VAC)	300
CURRENT RATING (A)	32
WITHSTANDING VOLTAGE (kV)	1.6
OPERATING TEMP. (°C)	-40~+115
SOLDERING TEMP. (°C)	250±10 (5 sec.)
POLES AVAILABLE	02~16
SAFETY CERTIFICATE	

NOTES:

- MATERIALS  
 1-1 HOUSING: THERMALPLASTIC RESIN, UL 94V-0 RATED.  
 1-2 TERMINAL: COPPER ALLOY, TIN PLATED.
2. PRODUCTION SPECIFICATION REFER TO FCI GS-12-625.
3. BOXED PACKAGING.  
 DETAILED PRODUCT PACKING SPECIFICATION REFER TO FCI GS-14-1394.
4. FCI, SAFETY CERTIFICATE LOGO AND SERIES NAME TO BE SHOWN ON PRODUCT SURFACE.
5. THE PRODUCTS WHERE THE PART NUMBER END IN "LF" MEET THE EUROPEAN UNION DIRECTIVE AND OTHER COUNTRY REGULATIONS AS DESCRIBED IN GS-22-008.
6. RECOMMENDED SOLDERING PROCESS BY WAVE SOLDER.

mat'l. code	surface ASME Y14.5	tolerance ASME Y14.5	projection	product family
A 0609-0203 BF 062509	tolerances unless otherwise specified	X.±0.5[.020]	MM	TERMINAL BLOCK
B T09-1148 BF 111709	angles	X.X±0.3[.012]	[INCH]	TERMINAL BLOCK
C T10-0042 WL 030310	X'±1'	X.XX±0.1[.004]	scale	PLUGGABLE SOCKET, RIGHT ANGLE
D T10-0159 WL 100410	dr	BEER FU 062509		sheet 1 of 2 size
E T10-0187 WL 121410	enr	BEER FU 062509		dwg no 20020618
F T-004746 WL 072211	chr	GARY HSIEH 062509		A4
	appd	JOSEPH HSIA 062509		type CUSTOMER Drawing
sheet index	revision sheet	F 1 2		

PRODUCT NUMBER	SERIES NAME	PITCH
20020618-MXXXXXXLF	07-762	7.62 mm

N = NUMBER OF POLES  
Dim A =  $N \times 7.62$  [.300]  
Dim B =  $(N-1) \times 7.62$  [.300]

Poles	Tol.	Dim A	Dim B
2-5p		$\pm 0.20$ [.008]	
6-10p		$\pm 0.30$ [.012]	
11-13p		$\pm 0.35$ [.014]	
14-16p		$\pm 0.40$ [.016]	

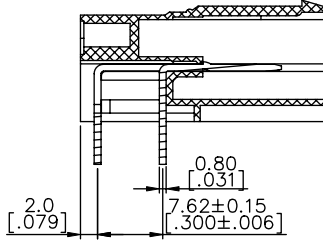
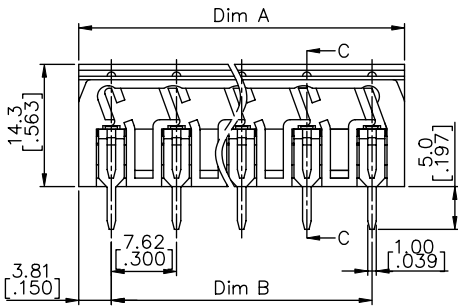
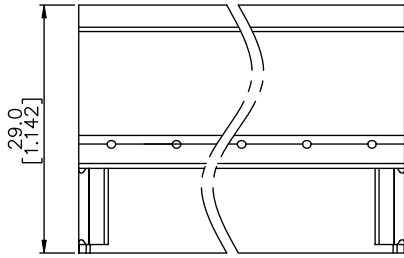

SECTION C-C

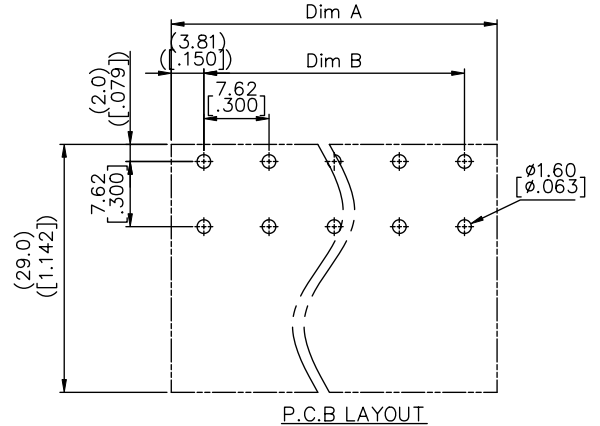

P.C.B LAYOUT

mat'l. code	surface ASME Y14.5	tolerance ASME Y14.5	projection	product family TERMINAL BLOCK
ltr	ecn	no	dr	date
tolerances unless otherwise specified				
angles	X	±0.5	[.020]	MM
LE	X.X	±0.3	[.012]	[INCH]
X'±1'	X.XX	±0.1	[.004]	scale
dr	BEER FU	062509	<b>FCI</b>	title TERMINAL BLOCK PLUGABLE, SOCKET, POWER, R/A
enr	BEER FU	062509		dwg no 20020618
chr	GARY HSIEH	062509		sheet 2 of 2
appd	JOSEPH HSIA	062509		size A4
sheet	revision			type CUSTOMER Drawing
index	sheet			