

Excellent Integrated System Limited

Stocking Distributor

Click to view price, real time Inventory, Delivery & Lifecycle Information:

[Harwin Inc.](#)
[S1711-46R](#)

For any questions, you can email us directly:
sales@integrated-circuit.com

Customer Information Sheet

DRAWING No.: S1711-XX SHEET 2 OF 2 IF IN DOUBT - ASK (C) NOT TO SCALE THIRD ANGLE PROJECTION ALL DIMENSIONS IN mm

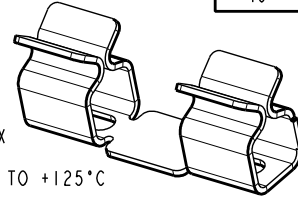
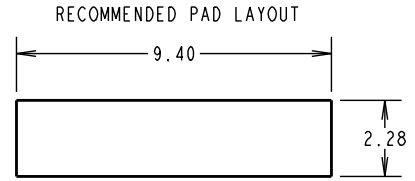
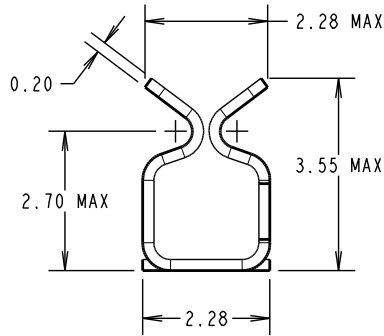
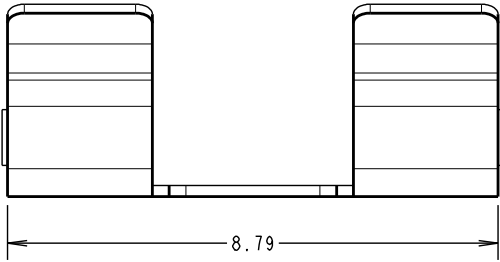

ORDER CODE:
S1711-XX
FINISH: _____
06 = TIN/LEAD
46 = 100% TIN OVER NICKEL

SPECIFICATION:
MATERIAL = BERYLLIUM COPPER
FINISH:
 06 = 3µ 90/10 TIN/LEAD
 46 = 3µ 100% TIN
ELECTRICAL:
 CONTACT RESISTANCE = 20mΩ MAX
ENVIRONMENTAL:
 OPERATING TEMPERATURE = -40°C TO +125°C
MECHANICAL:
 INSERTION FORCE (AFTER CONDITIONING) = 4N MAX
 WITHDRAWAL FORCE = 0.5N MIN
 DURABILITY = 20 INSERTIONS MINIMUM
 SHIELD THICKNESS = 0.17mm - 0.30mm

MSP	7	16.10.15	13113
NAME	ISS.	DATE	C/NOTE
APPROVED: M.PERREN			
CHECKED: S.BENNETT			
DRAWN: J.ENRIGHT			
CUSTOMER REF.:			
ASSEMBLY DRG:			

NOTES:
 1. FOR TAPE AND REELED VERSION, SEE DRAWING S1711-XXR.
 2. SUPPLIED IN A STRIP OF 100, PACKED IN A BAG.

HARWIN

www.harwin.com
technical@harwin.com

THIS DRAWING AND ANY INFORMATION OR DESCRIPTIVE MATTER SET OUT HEREON ARE CONFIDENTIAL AND COPYRIGHT PROPERTY OF THE HARWIN GROUP AND MUST NOT BE DISCLOSED, LOANED, COPIED OR USED FOR MANUFACTURING, TENDERING OR FOR ANY OTHER PURPOSE WITHOUT THEIR WRITTEN PERMISSION.

TOLERANCES
 X. = ±1mm
 X.X = ±0.50mm
 X.XX = ±0.10mm
 X.XXX = ±0.01mm
 ANGLES = ±5°
 UNLESS STATED

MATERIAL: SEE ABOVE
FINISH: SEE ABOVE
S/AREA: mm²

TITLE: SMT RFI SHIELD CLIP (LOOSE)
DRAWING NUMBER: S1711-XX
 SHT 2 OF 2