

Excellent Integrated System Limited

Stocking Distributor

Click to view price, real time Inventory, Delivery & Lifecycle Information:

[Laird Technologies - Engineered Thermal Solutions](#)
[LL-210-24-00-00-00](#)

For any questions, you can email us directly:

sales@integrated-circuit.com

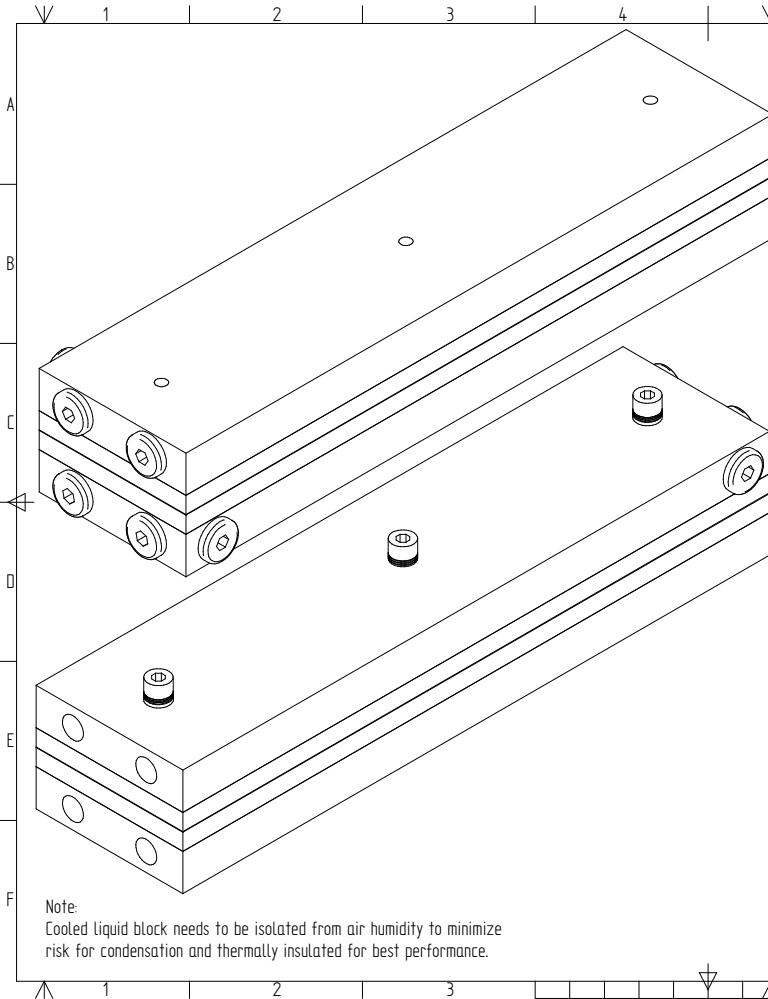

Specification (Ta=32°C)	Code	Description
Heat transfer, cold side	L	Liquid
Heat transfer, warm side	L	Liquid
Cascade	-	
Cooling power: (W)	210	Calculated 266 W at $\Delta T=0^\circ\text{C}$. Tolerance $\pm 10\%$.
Voltage, nominal: (VDC)	24	24 VDC
TEM Voltage (VDC)		Nominal: 24 VDC, Max: 30 VDC
TEM Current (A)		Nominal: 9.4 A, Infrd: 10.4 A, All at $\Delta T=0^\circ\text{C}$. Tolerance $\pm 10\%$.
Fan(s), cold side	0	None
Fan(s), warm side	0	None
Temperature controller: sensor	0	None
Temperature control: settings, trim options	0	-
Additional controller information		
Temperature control position	0	-
Options	0	-
Overheating thermostat		75°C/45°C on hot side heat sink surface. Not wired in series with TEMs. Use it to control a relay.
Operating temperature		Max: 62°C at nominal voltage.
TE-Module(s) temperature specification		Max: surface temperature: 80°C.
Enclosed		Turbulators fitted in liquid channels. 4xL-FNPP-6-18
Packing		Individual cardboard box

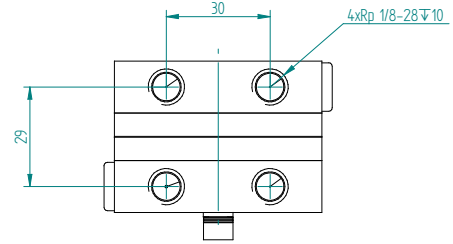

For overheating protection the cooler is equipped with a bimetal thermostat. The maximum rating for the thermostat is 8 A DC. For systems with 8 A or less the thermostat can be connected directly in series with the ThermoElectric Modules (TEMs). Otherwise connect the TEMs to the power source through a relay of suitable rating which state is controlled with the bimetal thermostat.

General tolerances:	First angle projection:	Dimension units:
SS-ISO 2768-1 v		Metric (mm)

Comment / Deviations					
Hi-Pot tested 750VDC					
Designed by	Checked by	Approved by	Release date	Project	Customer:
M. Nyman	E. Johansson	E. Johansson	2011-10-21	Standard	
Laird Technologies S-4353 Molndal, Sweden tfn: +46 31 420530, fax: +46 31 247909 e-mail: info@lairdtech.com web: www.lairdtech.com			Title		
TE ASSEMBLY 24 VDC LIQUID - LIQUID			Part no		
LL-210-24-00-00-00			Rev	Version	Scale
			05	-	1:1
			Size, sheet	A3, 1/41	

Note:
Cooled liquid block needs to be isolated from air humidity to minimize risk for condensation and thermally insulated for best performance.

