

Excellent Integrated System Limited

Stocking Distributor

Click to view price, real time Inventory, Delivery & Lifecycle Information:

[Apem Inc.](#)
[MJTPSMWA](#)

For any questions, you can email us directly:
sales@integrated-circuit.com

MJTP SERIES 6MM & 4MM SMD TACT SWITCHES

FEATURES

- Numerous single pole-single throw momentary configurations.
- Excellent tactile feed-back (Snap dome).
- Ultra-compact size.
- Long operating life for high reliability.
- Molded-in terminals minimize wicking of flux or solder.

MATERIALS

Case: High temperature 4/6 nylon.
 Actuator: High temperature 4/6 nylon.
 Cover/Bracket: PET film, tin plated brass or stainless steel.
 Terminals: Silver plated brass.
 Shorting Contact: Phosphor bronze or stainless steel with silver plating.
 L.E.D. rating: Forward voltage- 2.1 V (3.0 V Max.). Cont. fwd. current 20mA max. @ 25°C.

Gold plating available on contacts & terminals
 - consult factory.

SPECIFICATIONS SUBJECT TO CHANGE WITHOUT NOTICE.

GENERAL SPECIFICATIONS

ELECTRICALS

Contact rating: 50 mA @ 12 VDC
 Insulation resistance: 100 megohms min. (100 VDC)
 Dielectric withstanding voltage: 250 VAC for 1 minute
 Contact resistance: 100 milliohms max. @ 5 VDC, 10 mA
 Electrical life: 100,000 cycles min. (1,000,000 cycles available - consult factory)
 Contact bounce: less than 10 msec.

MECHANICALS, THERMALS, ENVIRONMENTALS

Plunger travel: .010"+ .008", - .004" (0,25 +0,2, -0,1 mm)
 Actuation force: 160 grams ±30 grams
 Operating temperature range: -20°C to +70°C
 Storage temperature range: -30°C to +80°C for 96 hours
 Shock resistance: 30G per method 213, MIL-STD-202
 Vibration resistance: passes method 201, MIL-STD-202

SOLDERING (note - non-washable except for models indicated as 'process compatible').

IR reflow soldering: 240°C max. for 20 seconds max.
 Wave soldering: 255°C max. for 5 seconds max.
 Hand soldering: 320°C max. for 3.5 seconds max. (40 watt iron max.)

US # MJTP1106S

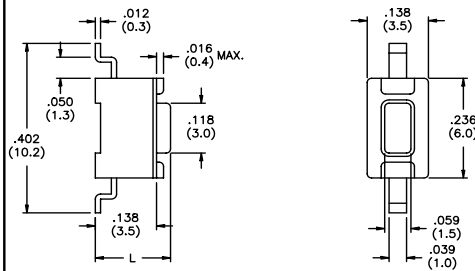

US Model No.	Dim. L (in./mm)
MJTP1106S	.169 (4,3)
MJTP1106SA	.197 (5,0)

Bulk packaged.



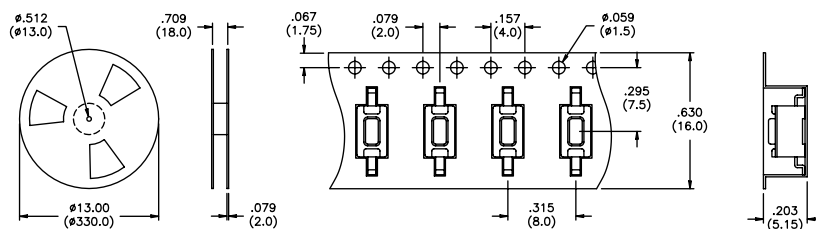

US # MJTP1106SATR

Same as above, except supplied on tape and reel as shown.

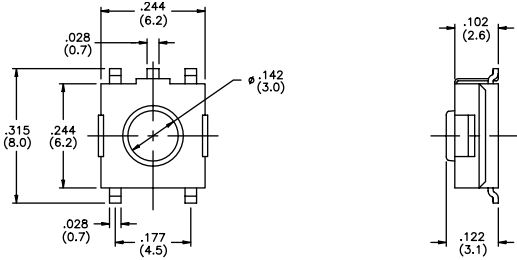

Tape & reel packaging - quantity 1800 per reel.

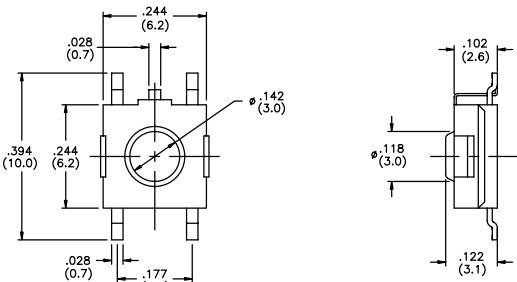

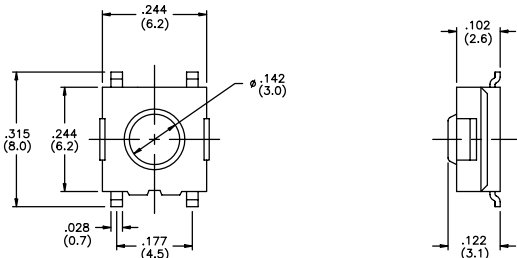
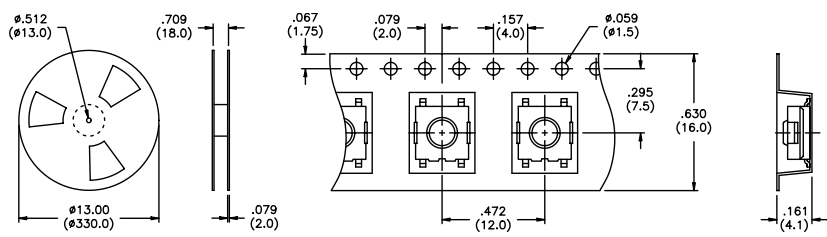
<p>US # MJTP1122 Grounding</p> 	 <p>Bulk packaged.</p>
<p>US # MJTP1122A Grounding</p> 	 <p>Bulk packaged.</p>
<p>US # MJTP1122B EU # PHAP3374</p> 	 <p>Bulk packaged.</p>
<p>US # MJTP1122TR, MJTP1122BTR & MJTP3374TR EU # PHAP3374R</p> <p>Same as above, except supplied on tape & reel as shown. Note - MJTP1122A not available on tape & reel.</p>	 <p>Tape & reel packaging - quantity 1500 per reel.</p>

SPECIFICATIONS SUBJECT TO CHANGE WITHOUT NOTICE.

M

SPECIFICATIONS SUBJECT TO CHANGE WITHOUT NOTICE.

US # MJTP1125B



New!

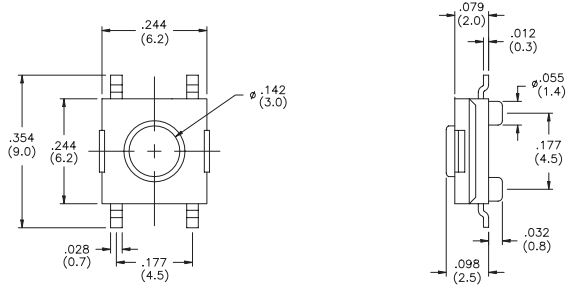





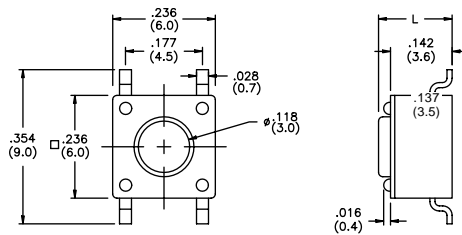

Bulk packaged.

US # MJTP1138
EU # PHAP3368

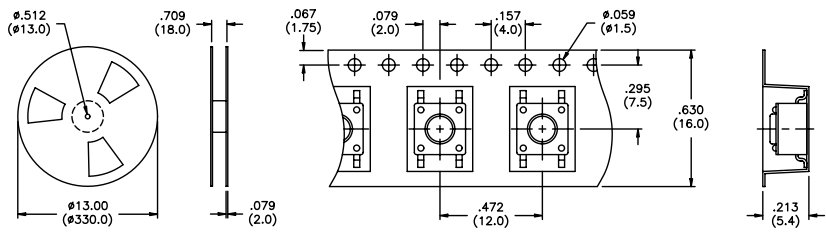

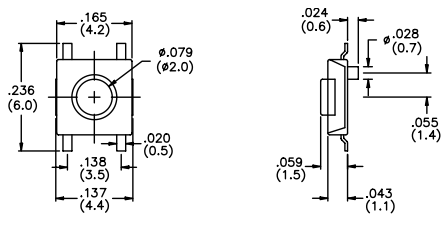
Bulk packaged. Tubes available for some models consult factory.

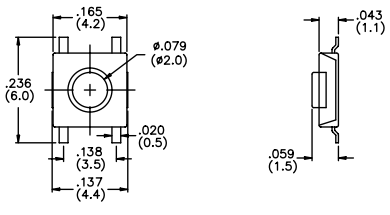
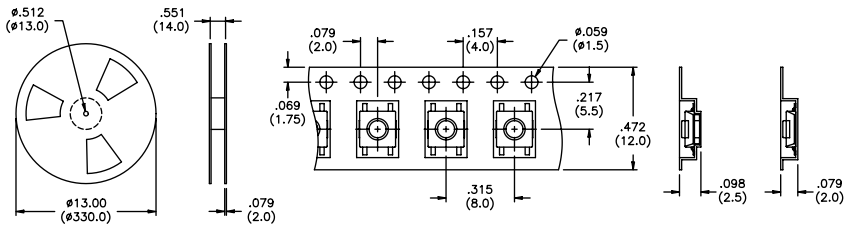
US Model No.	Dim. L (in./mm)	EU Model No.
MJTP1138	.170 (4,3)	PHAP3368
MJTP1138A	.197 (5,0)	PHAP3368A
MJTP1138B	.374 (9,5)	PHAP3368B
MJTP1138C	.315 (8,0)	PHAP3368C
MJTP1138D	.512 (13,0)	PHAP3368D
MJTP1138E	.287 (7,3)	PHAP3368E
MJTP1138F	.335 (8,5)	PHAP3368F
MJTP1138G	.275 (7,0)	N/A

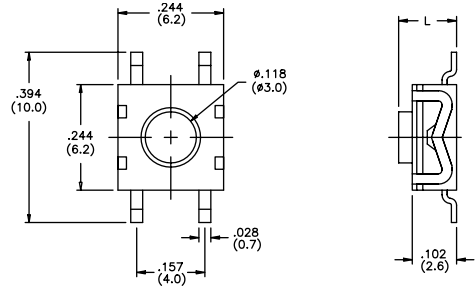
<p>US # MJTP1138TR & MJTP1138ATR</p> <p>Same as above except supplied on tape & reel as shown.</p>	 <p>Tape & reel packaging - quantity 1200 per reel.</p>									
<p>US # MJTP1140 EU # PHAP3390</p> <p>4mm x 4mm</p> 	 <p>Bulk packaged.</p>									
<p>US # MJTP1140A EU # PHAP3391</p> 	 <p>Bulk packaged.</p>									
<p>US # MJTP1140TR & MJTP1140ATR EU # PHAP3390R & PHAP3391R</p> <p>Same as above, except supplied on tape & reel as shown.</p>	 <p>Tape & reel packaging - quantity 3400 per reel.</p>									
<p>US # MJTP1162 EU # PHAP3371</p> 	 <table border="1" data-bbox="981 1724 1404 1870"> <thead> <tr> <th>US Model No.</th> <th>Dim. L (in./mm)</th> <th>EU Model No.</th> </tr> </thead> <tbody> <tr> <td>MJTP1162</td> <td>.102 (2,6)</td> <td>PHAP3371</td> </tr> <tr> <td>MJTP1162A</td> <td>.134 (3,4)</td> <td>PHAP3371A</td> </tr> </tbody> </table> <p>Bulk packaged.</p>	US Model No.	Dim. L (in./mm)	EU Model No.	MJTP1162	.102 (2,6)	PHAP3371	MJTP1162A	.134 (3,4)	PHAP3371A
US Model No.	Dim. L (in./mm)	EU Model No.								
MJTP1162	.102 (2,6)	PHAP3371								
MJTP1162A	.134 (3,4)	PHAP3371A								

SPECIFICATIONS SUBJECT TO CHANGE WITHOUT NOTICE.

US # MJTP1162TR & MJTP1162ATR
EU # PHAP3371R & PHAP3371AR
 Same as above except supplied on tape & reel as shown.

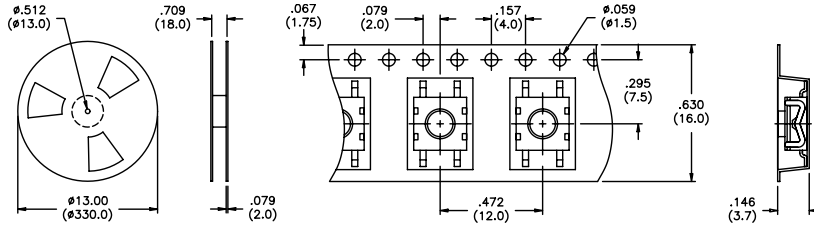

Tape & reel packaging - quantity 1600 per reel.

US # MJTPSJW66N
 Process compatible



New!

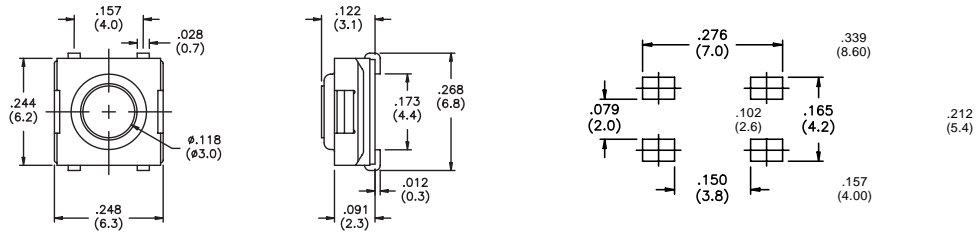

Bulk packaged.

US # MJTPSJW69N
 Process compatible



New!

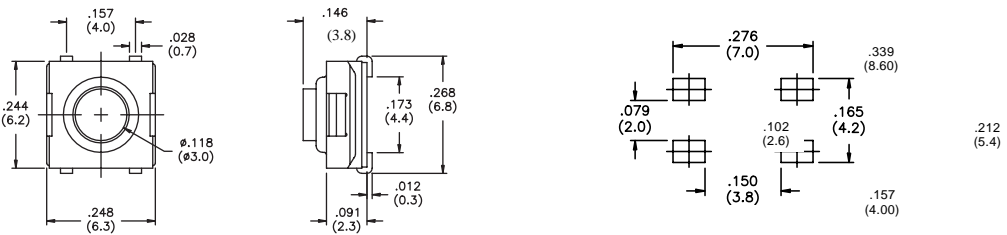

Bulk packaged.

US # MJTPSMW
 Process compatible

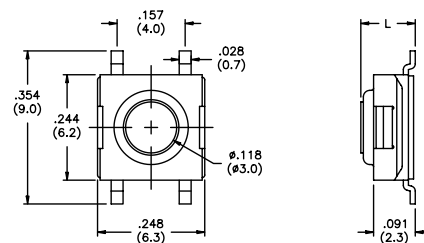

US Model No.	Dim. L (in./mm)
MJTPSMW	.122 (3,1)
MJTPSMWA	.091 (2,3)
MJTPSMWB	.146 (3,8)

Bulk packaged.

M

US # MJTPSMWTR & MJTPSMWATR, MJTPSMWBTR
 Same as above except supplied on tape & reel as shown.

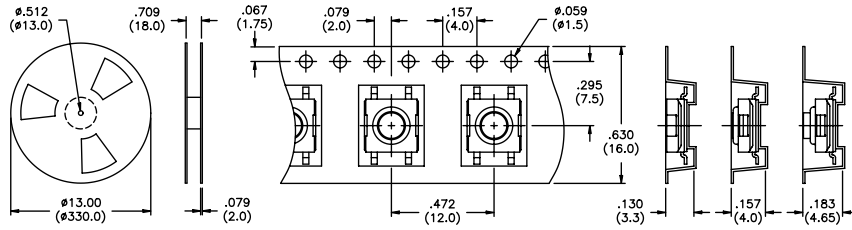

Tape & reel packaging - quantity 'MWTR' & 'MWATR' 2000 per reel, 'MWBTR' 1900 per reel.

SCHEMATICS

MJTP1122
 MJTP1125
 MJTP1137
 MJTP1138
 MJTP1140
 MJTP1162
 MJTPSJW66N
 MJTPSJW69N
 MJTPSMW

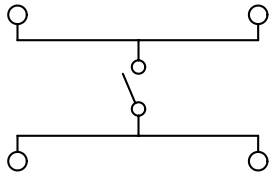

MJTP1106

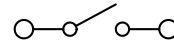

PRINTED CIRCUIT BOARD LAYOUTS

Layout tolerances; Linear: $\pm .004"$ ($\pm 0,1MM$) Holes: $\pm .002"$ ($\pm 0,05MM$) Pads: $\pm .008"$ ($\pm 0,2MM$)

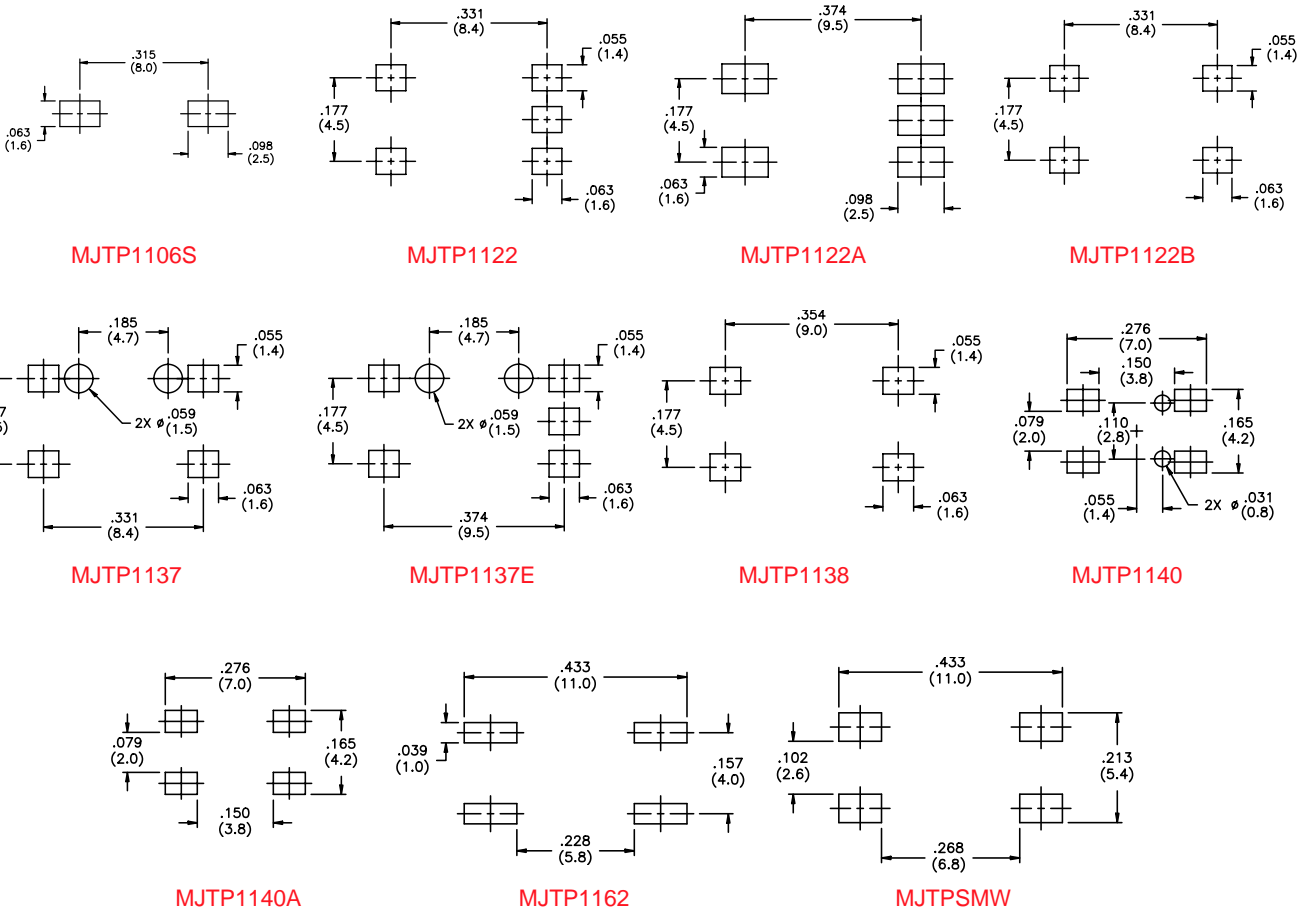

SPECIFICATIONS SUBJECT TO CHANGE WITHOUT NOTICE.

M