



Distributor of Molex Connector Corporation: Excellent Integrated System Limited
Datasheet of 0357252610 - Connector Quick Connect Receptacle 12-18 AWG 0.250"
(6.35mm) Crimp

Contact us: sales@integrated-circuit.com Website: www.integrated-circuit.com

Excellent Integrated System Limited

Stocking Distributor

Click to view price, real time Inventory, Delivery & Lifecycle Information:

[Molex Connector Corporation](#)
[0357252610](#)

For any questions, you can email us directly:
sales@integrated-circuit.com

Contact us: sales@integrated-circuit.com Website: www.integrated-circuit.com

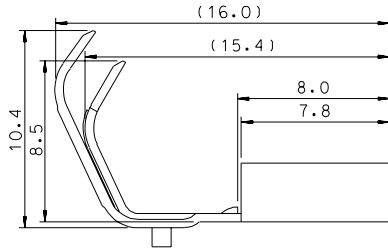
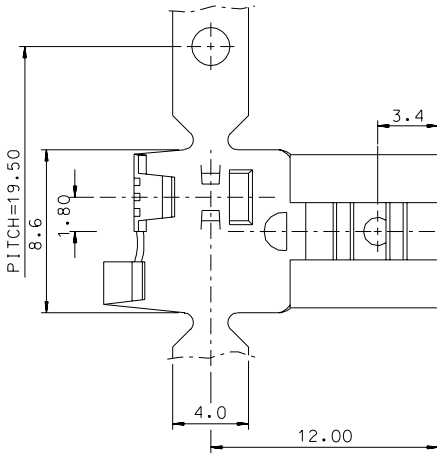

↑ "D"

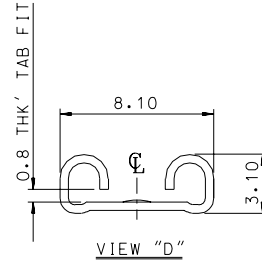

NOTES

1. MATERIAL : BRASS, 0.45mmThk'
2. FINISH : POST-TIN PLATED

MATERIAL NO.	ENG NO.	FINISH
357252600	35725-2600	UNPLATED
357252610	35725-2610	POST TIN PLATED

3. MATING TAB THICKNESS: 0.8mmThk'
4. APPLICABLE WIRERANE : AWG#18 - #12
5. RECOMMENDED LENGTH OF WIRE STRIP IS 4.8mm - 5.3mm

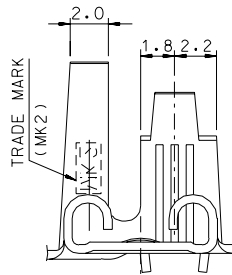

REVISED EC NO. KOR2004-0148 DRAWN: C.B.CHIN 04/06/22 CHK: W.Y.YANG APPR: C.W.LEE	QUALITY SYMBOLS MAJOR = 0 CRITICAL = 0 MINOR = 0	GENERAL TOLERANCES: (UNLESS SPECIFIED)		SCALE 5:1	DESIGN UNITS <input checked="" type="checkbox"/> MM <input type="checkbox"/> INCH	THIRD ANGLE PROJECTION <input checked="" type="checkbox"/> THIRD ANGLE <input type="checkbox"/> FIRST ANGLE	DIMENSIONS: <input type="checkbox"/> INCH <input type="checkbox"/> MM <input checked="" type="checkbox"/> MM ONLY	SHT REV
		4 PLACES ±0. ±. 3 PLACES ±0. ±. 2 PLACES ±0.30 ±. 1 PLACE ±0.30 ±.	DRAWN BY & DATE W.Y.YANG 93/07/21 CHECKED BY & DATE B.K.CHOI 93/07/21 APPROVED BY & DATE C.W.LEE 93/07/21	TITLE: .250 FLAG REC' TERMINAL		CAD FILENAME S7252610AA.DGN	MATERIAL NO. SEE NOTES	DRAWING NO. SD-35725-26*0
DRAFT WHERE APPLICABLE MUST REMAIN WITHIN DIMENSIONS		THIS DRAWING CONTAINS INFORMATION THAT IS PROPRIETARY TO MOLEX INCORPORATED AND SHOULD NOT BE USED WITHOUT WRITTEN PERMISSION.						

DO NOT SCALE DRAWING DIMENSION IN METRIC