



Distributor of Molex Connector Corporation: Excellent Integrated System Limited
Datasheet of 0901471110 - Connector Receptacle 10 Position 0.100" (2.54mm) Tin Through Hole

Contact us: sales@integrated-circuit.com Website: www.integrated-circuit.com

Excellent Integrated System Limited

Stocking Distributor

Click to view price, real time Inventory, Delivery & Lifecycle Information:

[Molex Connector Corporation](#)
[0901471110](#)

For any questions, you can email us directly:
sales@integrated-circuit.com

Contact us: sales@integrated-circuit.com Website: www.integrated-circuit.com

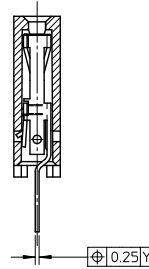
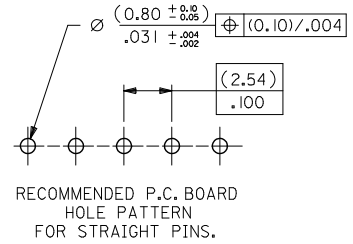
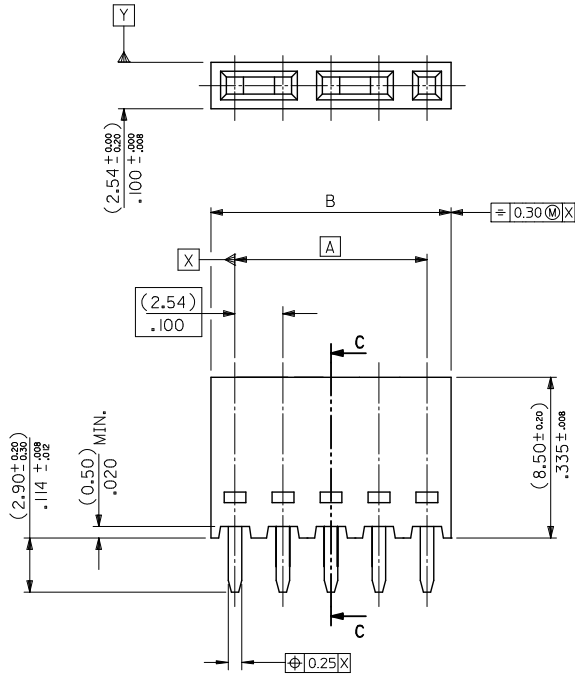

SECTION C-C SHOWING STRAIGHT PINS.

NOTES:

- 1) CONTACT-PLATED PHOSPHOR BRONZE.
- 2) HOUSING-15% GLASS FILLED POLYESTER. COLOUR: BLACK.
- 3) FOR (0.635)/.025 SQ. MALE PINS THE LENGTH MUST BE (5.65)/.222 MIN & (7.00)/.276 MAX. TO ENSURE GOOD CONNECTION WITH CONTACT.
- 4) PRODUCT SPECIFICATION: PS-99020-0001.
- 5) PCB THICKNESS 1.6MM

UPDATE FEATURE CONTROL REF. NO. S2013-0792 DRAWN BY DRWINATSEE 2013/05/09 CHECKED BY CHK-SKANG 2013/05/15 APPR. BY LONG 2013/05/16 REV. AD	QUALITY SYMBOLS	GENERAL TOLERANCES (UNLESS SPECIFIED)	DIMENSION STYLE	SCALE	DESIGN UNITS	THIRD ANGLE PROJECTION
	√=0 √=0 √=0	mm INCH 4 PLACES ± --- ± --- 3 PLACES ± --- ± --- 2 PLACES ± --- ± --- 1 PLACE ± --- ± --- 0 PLACE ± ±	MM/IN	NTS	METRIC	THIRD ANGLE PROJECTION C-GRID III, SINGLE ROW VERTICAL P.C. BOARD CONNECTOR ASSEMBLY.
	ANGULAR ± 2 ° DRAFT WHERE APPLICABLE MUST REMAIN WITHIN DIMENSIONS	DRAWN BY DB 1987/07/14 CHECKED BY JDENNEHY 2005/07/07 APPROVED BY JDENNEHY 2005/07/07	MATERIAL NO. SEE TABLE	DOCUMENT NO. SDA-90147	SHEET NO. 1 OF 1	
	THIS DRAWING CONTAINS INFORMATION THAT IS PROPRIETARY TO MOLEX INCORPORATED AND SHOULD NOT BE USED WITHOUT WRITTEN PERMISSION					

Contact us: sales@integrated-circuit.com Website: www.integrated-circuit.com

PART NO'S - STRAIGHT PINS		NO. OF CKTS	DIM. "A"	DIM. "B" (*0.00) (*0.00)	QTY. PER TUBE
STANDARD	CUSTOMER SPECIFIC				
90147-1X02		2	(2.54) .100	(5.08) .200	105
03		3	(5.08) .200	(7.62) .300	72
04		4	(7.62) .300	(10.16) .400	52
05	90147-9105	5	(10.16) .400	(12.70) .500	44
06		6	(12.70) .500	(15.24) .600	36
07		7	(15.24) .600	(17.78) .700	30
08		8	(17.78) .700	(20.32) .800	26
09		9	(20.32) .800	(22.86) .900	22
10		10	(22.86) .900	(25.40) 1.000	22
11		11	(25.40) 1.000	(27.94) 1.100	20
12		12	(27.94) 1.100	(30.48) 1.200	18
13		13	(30.48) 1.200	(33.02) 1.300	16
14		14	(33.02) 1.300	(35.56) 1.400	14
15		15	(35.56) 1.400	(38.10) 1.500	14
16		16	(38.10) 1.500	(40.64) 1.600	13
17		17	(40.64) 1.600	(43.18) 1.700	13
18		18	(43.18) 1.700	(45.72) 1.800	12
19		19	(45.72) 1.800	(48.26) 1.900	12
20		20	(48.26) 1.900	(50.80) 2.000	11
21		21	(50.80) 2.000	(53.34) 2.100	11
22		22	(53.34) 2.100	(55.88) 2.200	10
23		23	(55.88) 2.200	(58.42) 2.300	9
24		24	(58.42) 2.300	(60.96) 2.400	9
25		25	(60.96) 2.400	(63.50) 2.500	8
26		26	(63.50) 2.500	(66.04) 2.600	8
27		27	(66.04) 2.600	(68.58) 2.700	8
28		28	(68.58) 2.700	(71.12) 2.800	7
29		29	(71.12) 2.800	(73.66) 2.900	7
30		30	(73.66) 2.900	(76.20) 3.000	7
31		31	(76.20) 3.000	(78.74) 3.100	7
90147-1X32		32	(78.74) 3.100	(81.28) 3.200	6

PLATING VERSION A

PRE-PLATED HOT DIP TIN
 1.0 TO 2.5 um (.000040" TO .000100").

PLATING VERSION E

1.27 TO 1.78 um (.000050" TO .000070") NICKEL
 OVERALL, 0.38 TO 0.64 um (.000015" TO .000025")
 GOLD ON CONTACT AREA (OVER NICKEL).
 3 TO 5 um (.000120" TO .000200") TIN
 ON SOLDER TAILS (OVER NICKEL).

PLATING VERSION F.

1.27 TO 1.78 um (.000050" TO .000070") NICKEL
 OVERALL, 0.76 TO 1.0 um (.000030" TO .000040")
 GOLD ON CONTACT AREA (OVER NICKEL).
 3 TO 5 um (.000120" TO .000200") TIN
 ON SOLDER TAILS (OVER NICKEL).

90147-XXYY

INDICATES NO. OF CIRCUITS.

PLATING CODE.
 1 = VERSION A.
 2 = VERSION E.
 3 = VERSION F.
 SEE CHART.

STANDARD PRODUCTS

UPDATE REVISION EC No. S2013-0792 DRAWN BY: 2013/05/13 CHKO:SKANG 2013/05/15 APPR:HLONG 2013/05/16 AC	QUALITY SYMBOLS √=0 ∇=0 ∇=0	GENERAL TOLERANCES (UNLESS SPECIFIED)		DIMENSION STYLE		SCALE	DESIGN UNITS	THIRD ANGLE PROJECTION	
		mm	INCH	MM/IN	NTS	METRIC			
		4 PLACES ±---	±---	DRAWN BY: DB	DATE: 1986/12/28	TITLE: C-GRID III SINGLE ROW VERTICAL P.C. BOARD CONNECTOR			
		3 PLACES ±---	±---	CHECKED BY: JDENNEHY	DATE: 2005/07/07				
2 PLACES ±---	±---	APPROVED BY: JDENNEHY	DATE: 2005/07/07						
1 PLACE ±---	±---	ANGULAR ± 2 °		MATERIAL NO.	DOCUMENT NO.	SHEET NO.			
0 PLACE ±	±	DRAFT WHERE APPLICABLE MUST REMAIN WITHIN DIMENSIONS		SEE TABLE	SDA-90147	1 OF 1			