

## Excellent Integrated System Limited

Stocking Distributor

Click to view price, real time Inventory, Delivery & Lifecycle Information:

[Molex Connector Corporation](#)  
[0511030200](#)

For any questions, you can email us directly:

[sales@integrated-circuit.com](mailto:sales@integrated-circuit.com)

DWG. NO. SD-51103-020

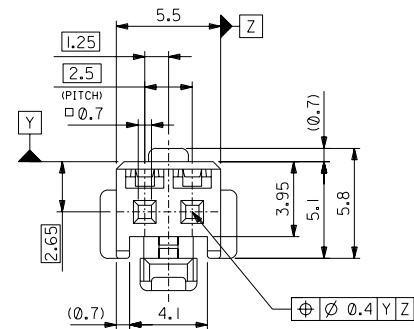
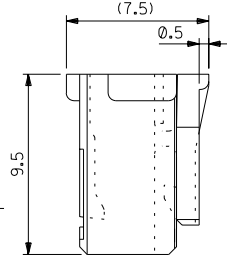
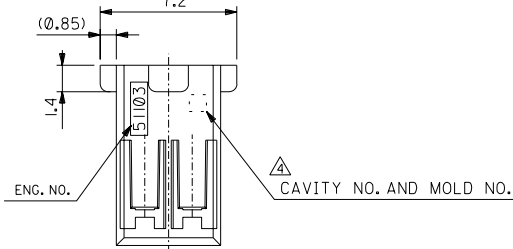
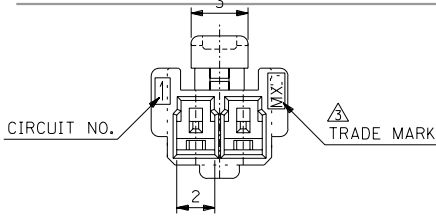

注記 NOTES

1. 適合ターミナル: 50351-8\*00  
APPLICABLE TERMINAL : 50351-8\*00
2. 嵌合相手: 53464 シリーズ  
MATE WITH : 53464 SERIES.
3. MX Jと表示。  
INDICATE MXJ.
4. キャビティー番号: 1桁~2桁の数字  
金型番号: アルファベット1文字にて構成。(例, 1A, 10B)  
FORMED BY 1 DIGIT TO 2 DIGIT NUMBERS (TO CAVITY NO.)  
AND BY 1 LETTER OF ALPHABET (TO MOLD NO.).  
(e.g., 1A, 10B)
5. 製品番号の末尾は製品の色を示す  
LAST NUMBER OF DWG.NO. MEANS PART COLLER.

51103-\*\*25  
色番号 COLLER CODE  
5 蛍光灰色 GRAY

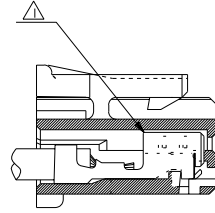

ターミナル装着状態図  
TERMINAL ASSEMBLY DRAWING

51103-0225	2
MATERIAL NO.	NO. OF CIRCUIT

DO NOT SCALE DRAWING

8	7	6	5	4	3	2	1
ENG. NO. DRAWN: CHK'G: APPR:	ENG. NO. DRAWN: CHK'G: APPR:	ENG. NO. DRAWN: CHK'G: APPR:	ENG. NO. DRAWN: CHK'G: APPR:	ENG. NO. DRAWN: CHK'G: APPR:	ENG. NO. DRAWN: CHK'G: APPR:	ENG. NO. DRAWN: CHK'G: APPR:	ENG. NO. DRAWN: CHK'G: APPR:

MATERIAL 材料 POLYBUTYLENE TEREPHTHALATE UL94V-0	FINISH 仕上り	WIRE RANGE 適用電線範囲	INS. RANGE 被覆外径
RELEASED '02/11/22 DRAWN: N.ITO CHK'G: K.SAKAWA APPR: T.YAMAGUCHI			

GENERAL TOLERANCES: (UNLESS SPECIFIED) 一般公差	SCALE 5 : 1	DESIGN UNITS mm INCH
10 UNDER 未満	+0.2	
10 OVER 以上	+0.25	
30 OVER 以上	+0.3	
ANGLE 角度	+3°	

DRAWN BY & DATE N.ITO '02/11/22	CHECKED BY & DATE K.SAKAWA '02/11/22	APPROVED BY & DATE T.YAMAGUCHI '02/11/22
TITLE: 2.5 WIRE TO BOARD CONN. HOUSING (POSITIVE LOCK)		
MATERIAL NO. SEE CHART		
DRAWING NO. SD-51103-020		

DIMENSIONS: mm INCH		SHT CAD ONLY	
PROJECTION		REV	
MOLEX INCORPORATED		SIZE B	
MATERIAL NO. SEE CHART		SHEET NO. 1 OF 1	
DRAWING NO. SD-51103-020		EN-02J(097) MXJ-54	

A

10 9 8 7 6 5 4 3 2 1

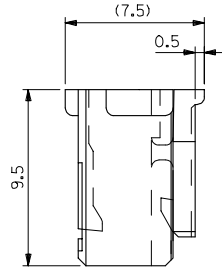
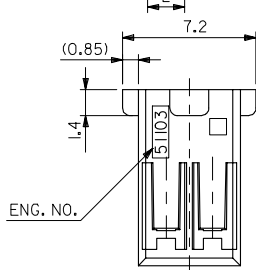
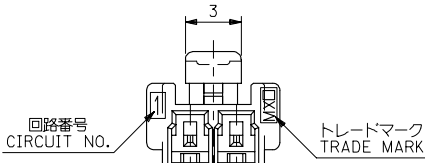

注記 NOTES

- △ 適合ターミナル : 5035I-8\*00  
APPLICABLE TERMINAL : 5035I-8\*00
2. 嵌合相手 : 53375,53426 シリーズ  
MATE WITH : 53375,53426 SERIES
- △ 偶数極の製品に適用。  
APPLY EVEN CIRCUIT PRODUCTS.
4. 製品型番の下1桁は色を表す。  
LAST DIGIT OF PART NUMBER INDICATES COLOR.  
0 : 白 WHITE    1 : 黒 BLACK    2 : 赤 RED  
3 : 黄 YELLOW    4 : 青 BLUE

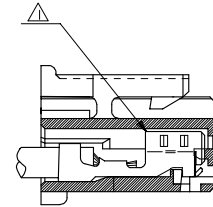

ターミナル装着状態図  
TERMINAL ASSEMBLY DRAWING

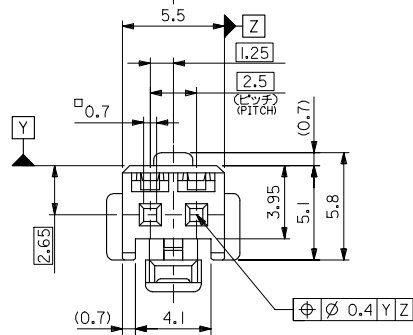

2極に適用  
FOR 2 CKTS.

51103-020*	2
MATERIAL NO.	CIRCUIT
◎ THIRD ANGLE PROJECTION	

RELEASED EC NO. : J2005-2009 DRAWN BY M.UMEDA 2005/02/02 CHECKED BY K.TOYODA 2005/02/04 APPROVED BY N.UKITA 2005/02/14 REV:	GENERAL TOLERANCES (UNLESS SPECIFIED)		DIMENSION STYLE MM ONLY	SCALE ---	DESIGN UNITS METRIC	2.5 W/B CONN. HOUSING (POSITIVE LOCK)
	10 UNDER	± 0.2	DRAWN BY DATE M.UMEDA 2005/01/14	TITLE		
	10 OVER 30 UNDER	± 0.25	CHECKED BY DATE K.TOYODA 2005/01/14	MATERIAL NO.		MOLEX INCORPORATED SHEET NO. 1 OF 2
	30 OVER	± 0.3	APPROVED BY DATE N.UKITA 2005/01/14	DOCUMENT NO.		
	ANGULAR ± 3 °	DRAFT WHERE APPLICABLE MUST REMAIN WITHIN DIMENSIONS	MATERIAL NO. SEE CHART	SD-51103-021		
			SIZE A3	THIS DRAWING CONTAINS INFORMATION THAT IS PROPRIETARY TO MOLEX INCORPORATED AND SHOULD NOT BE USED WITHOUT WRITTEN PERMISSION		

9 8 7 6 5 4 3 2 1 EN-02JA(021)

10 9 8 7 6 5 4 3 2 1

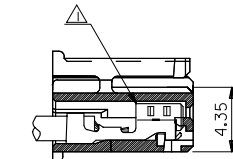
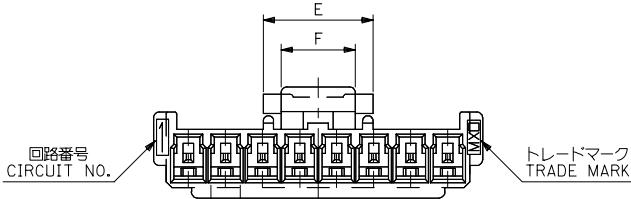

ターミナル装着状態図  
TERMINAL ASSEMBLY DRAWING

注記 NOTES

- △ 適合ターミナル : 50351-8\*00  
APPLICABLE TERMINAL : 50351-8\*00
- 嵌合相手 : 53375,53426 シリーズ  
MATE WITH : 53375,53426 SERIES
- △ 偶数極の製品に適用。  
APPLY EVEN CIRCUIT PRODUCTS.
- 製品型番の下1桁は色を表す。  
LAST DIGIT OF PART NUMBER INDICATES COLOR.  
0 : 白 WHITE    1 : 黒 BLACK    2 : 赤 RED  
3 : 黄 YELLOW    4 : 青 BLUE

3-15 極に適用  
FOR 3-15 CKTS.

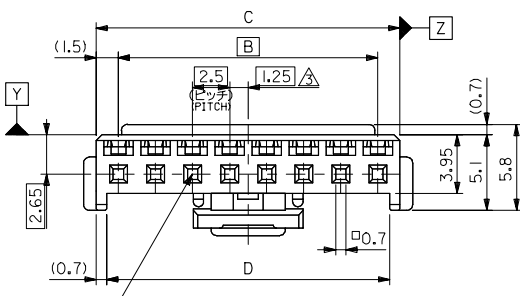
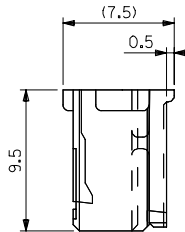
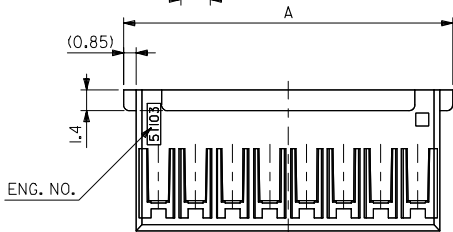

5	7.4	36.6	38	35	39.7	51103-150*	15
↑	↑	34.1	35.5	32.5	37.2	↑ -140*	14
		31.6	33	30	34.7	↑ -130*	13
		29.1	30.5	27.5	32.2	↑ -120*	12
		26.6	28	25	29.7	↑ -110*	11
		24.1	25.5	22.5	27.2	↑ -100*	10
		21.6	23	20	24.7	↑ -090*	9
		19.1	20.5	17.5	22.2	↑ -080*	8
		16.6	18	15	19.7	↑ -070*	7
		14.1	15.5	12.5	17.2	↑ -060*	6
		11.6	13	10	14.7	↑ -050*	5
5	7.4	9.1	10.5	7.5	12.2	↓ -040*	4
3	5	6.6	8	5	9.7	51103-030*	3
F	E	D	C	B	A	MATERIAL NO.	CIRCUIT

RELEASED EC NO: J2005-2009 DRAWN BY: M.UMEDA CHECKED BY: CHIKAKIYOYODA APPROVED BY: N. UKITA DATE: 2005/02/02 DATE: 2005/02/04 DATE: 2005/02/14	GENERAL TOLERANCES (UNLESS SPECIFIED)		DIMENSION STYLE	SCALE	DESIGN UNITS	THIRD ANGLE PROJECTION	
			MM ONLY	---	METRIC		
	10 UNDER	± 0.2	DRAWN BY	DATE	TITLE		
	10 OVER 30 UNDER	± 0.25	M.UMEDA	2005/01/14	2.5 W/B CONN. HOUSING (POSITIVE LOCK)		
30 OVER	± 0.3	CHECKED BY	DATE	MOLEX INCORPORATED			
ANGULAR	± 3 °	KTOYODA	2005/01/14				
DRAFT WHERE APPLICABLE MUST REMAIN WITHIN DIMENSIONS		APPROVED BY	DATE	DOCUMENT NO.		SHEET NO.	
		N. UKITA	2005/01/14	SD-51103-021		2 OF 2	
		MATERIAL NO.	SEE CHART	THIS DRAWING CONTAINS INFORMATION THAT IS PROPRIETARY TO MOLEX INCORPORATED AND SHOULD NOT BE USED WITHOUT WRITTEN PERMISSION			