

## Excellent Integrated System Limited

Stocking Distributor

Click to view price, real time Inventory, Delivery & Lifecycle Information:

[Molex Connector Corporation](#)  
[0511030400](#)

For any questions, you can email us directly:  
[sales@integrated-circuit.com](mailto:sales@integrated-circuit.com)

DWG. NO. SD-51103-020

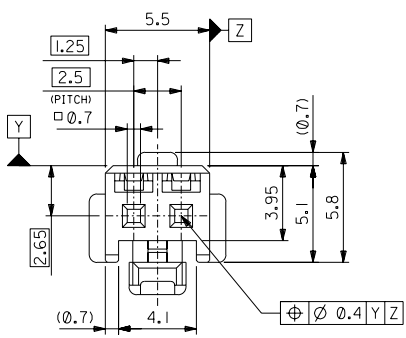
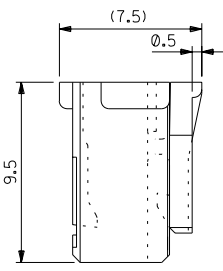
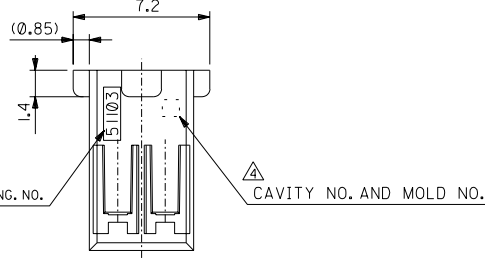
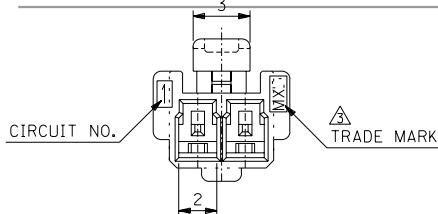

**注記 NOTES**

1. 適合ターミナル: 50351-8\*00  
APPLICABLE TERMINAL: 50351-8\*00
2. 嵌合相手: 53464 シリーズ  
MATE WITH: 53464 SERIES.
3. MXJと表示。  
INDICATE MXJ.
4. キャビティー番号: 1桁~2桁の数字  
金型番号: アルファベット1文字にて構成。(例, 1A, 10B)  
FORMED BY: 1 DIGIT TO 2 DIGIT NUMBERS (TO CAVITY NO.)  
AND BY 1 LETTER OF ALPHABET (TO MOLD NO.).  
(e.g., 1A, 10B)
5. 製品番号の末尾は製品の色を示す  
LAST NUMBER OF DWG.NO. MEANS PART COLLER.

51103-\*\*25  
色番号 COLLER CODE  
5 蛍光灰色 GRAY

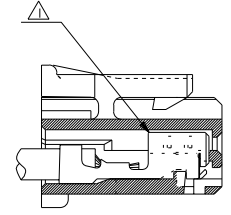

ターミナル装着状態図  
TERMINAL ASSEMBLY DRAWING

51103-0225	2
MATERIAL NO.	NO. OF CIRCUIT

DO NOT SCALE DRAWING

E84NO. DRWN: CHK: APPR:		E83NO. DRWN: CHK: APPR:		E82NO. DRWN: CHK: APPR:		E81NO. DRWN: CHK: APPR:		RELEASED '02/11/22 E80NO. J2003-1451 DRWN: N.ITO CHK: K.SAKAWA APPR: T.YAMAGUCHI		MATERIAL 材料 POLYBUTYLENE TEREPHTHALATE UL94V-0		GENERAL TOLERANCES: (UNLESS SPECIFIED) 一般公差		SCALE 5 : 1 DESIGN UNITS <input checked="" type="checkbox"/> mm <input type="checkbox"/> INCH		DRAWN BY & DATE N.ITO '02/11/22 CHECKED BY & DATE K.SAKAWA '02/11/22 APPROVED BY & DATE T.YAMAGUCHI '02/11/22		TITLE: 2.5 WIRE TO BOARD CONN. HOUSING (POSITIVE LOCK)		DIMENSIONS: <input type="checkbox"/> mm <input type="checkbox"/> INCH <input checked="" type="checkbox"/> mm ONLY <input checked="" type="checkbox"/> mm ONLY		SHT 1 REV 1 OTHERWISE ON CAD ONLY	
E84NO. DRWN: CHK: APPR:		E83NO. DRWN: CHK: APPR:		E82NO. DRWN: CHK: APPR:		E81NO. DRWN: CHK: APPR:		FINISH 仕上り #		WIRE RANGE 適用電線範囲 #		ANGLE 角度 ±3°		CAD FILENAME SD-51103-020.S01		MATERIAL NO. SEE CHART		DRAWING NO. SD-51103-020		SHEET NO. 1 OF 1			
E84NO. DRWN: CHK: APPR:		E83NO. DRWN: CHK: APPR:		E82NO. DRWN: CHK: APPR:		E81NO. DRWN: CHK: APPR:		INS. RANGE 接覆外径 #		#		#		#		#		#		#			

10 9 8 7 6 5 4 3 2 1

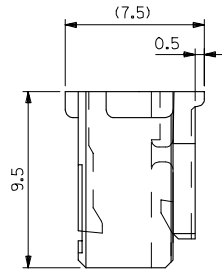
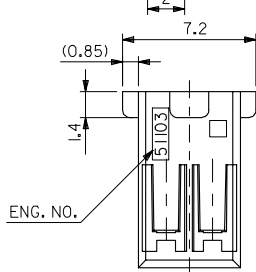
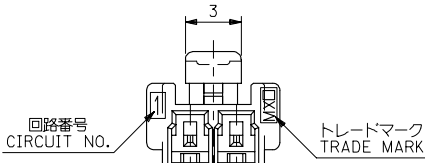

注記 NOTES

- △ 適合ターミナル : 50351-8\*00  
APPLICABLE TERMINAL : 50351-8\*00
2. 嵌合相手 : 53375,53426 シリーズ  
MATE WITH : 53375,53426 SERIES
- △ 偶数極の製品に適用。  
APPLY EVEN CIRCUIT PRODUCTS.
4. 製品型番の下1桁は色を表す。  
LAST DIGIT OF PART NUMBER INDICATES COLOR.  
0 : 白 WHITE    1 : 黒 BLACK    2 : 赤 RED  
3 : 黄 YELLOW    4 : 青 BLUE

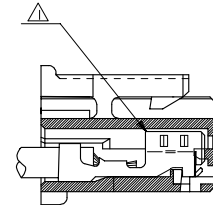

ターミナル装着状態図  
TERMINAL ASSEMBLY DRAWING

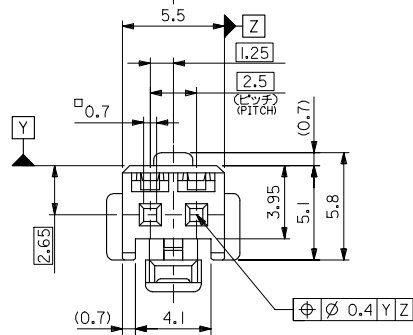

2極に適用  
FOR 2 CKTS.

51103-020*	2
MATERIAL NO.	CIRCUIT
◎ THIRDS ANGLE PROJECTION	

RELEASED EC NO. : J2005-2009 DRAWN BY M.UMEDA 2005/02/02 CHECKED BY K.TOYODA 2005/02/04 APPROVED BY N.UKITA 2005/02/14 REV:	GENERAL TOLERANCES (UNLESS SPECIFIED)		DIMENSION STYLE MM ONLY	SCALE ---	DESIGN UNITS METRIC	TITLE 2.5 W/B CONN. HOUSING (POSITIVE LOCK)
	10 UNDER	± 0.2	DRAWN BY M.UMEDA	DATE 2005/01/14	MOLEX INCORPORATED	
	10 OVER 30 UNDER	± 0.25	CHECKED BY K.TOYODA	DATE 2005/01/14		
	30 OVER	± 0.3	APPROVED BY N.UKITA	DATE 2005/01/14		
ANGULAR ± 3 °		MATERIAL NO.	DOCUMENT NO.	SHEET NO.		
DRAFT WHERE APPLICABLE MUST REMAIN WITHIN DIMENSIONS		SEE CHART	SD-51103-021	1 OF 2		
SIZE A3 THIS DRAWING CONTAINS INFORMATION THAT IS PROPRIETARY TO MOLEX INCORPORATED AND SHOULD NOT BE USED WITHOUT WRITTEN PERMISSION						

9 8 7 6 5 4 3 2 1 EN-02JA(021)

10 9 8 7 6 5 4 3 2 1

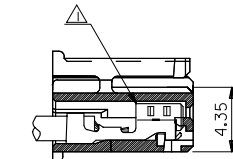
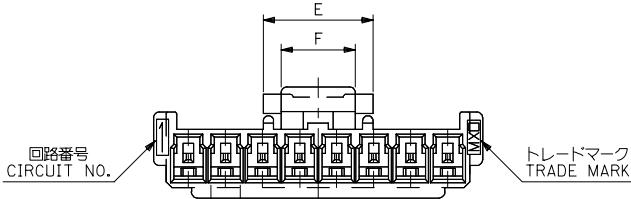

ターミナル装着状態図  
TERMINAL ASSEMBLY DRAWING

注記 NOTES

- △ 適合ターミナル: 50351-8\*00  
APPLICABLE TERMINAL: 50351-8\*00
2. 嵌合相手: 53375,53426 シリーズ  
MATE WITH: 53375,53426 SERIES
- △ 偶数極の製品に適用。  
APPLY EVEN CIRCUIT PRODUCTS.
4. 製品型番の下1桁は色を表す。  
LAST DIGIT OF PART NUMBER INDICATES COLOR.  
0:白 WHITE 1:黒 BLACK 2:赤 RED  
3:黄 YELLOW 4:青 BLUE

3-15 極に適用  
FOR 3-15 CKTS.

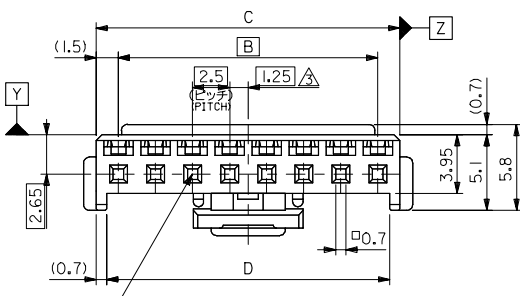
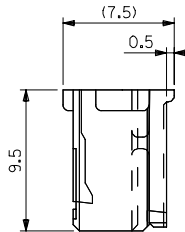
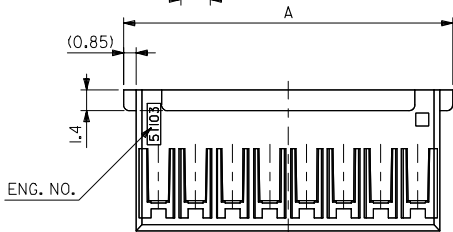

5	7.4	36.6	38	35	39.7	51103-150*	15
↑	↑	34.1	35.5	32.5	37.2	↑ -140*	14
		31.6	33	30	34.7	↑ -130*	13
		29.1	30.5	27.5	32.2	↑ -120*	12
		26.6	28	25	29.7	↑ -110*	11
		24.1	25.5	22.5	27.2	↑ -100*	10
		21.6	23	20	24.7	↑ -090*	9
		19.1	20.5	17.5	22.2	↑ -080*	8
		16.6	18	15	19.7	↑ -070*	7
		14.1	15.5	12.5	17.2	↑ -060*	6
		11.6	13	10	14.7	↑ -050*	5
5	7.4	9.1	10.5	7.5	12.2	↓ -040*	4
3	5	6.6	8	5	9.7	51103-030*	3
F	E	D	C	B	A	MATERIAL NO.	CIRCUIT

RELEASED EC NO: J2005-2009 DRAWN BY: M.UMEDA CHECKED BY: CHIKAKIYOYODA APPROVED BY: N.UKITA DATE: 2005/02/02 DATE: 2005/02/04 DATE: 2005/02/14	GENERAL TOLERANCES (UNLESS SPECIFIED)		DIMENSION STYLE	SCALE	DESIGN UNITS	THIRD ANGLE PROJECTION	
			MM ONLY	---	METRIC	☉	
	10 UNDER	± 0.2	DRAWN BY	DATE	TITLE		
	10 OVER 30 UNDER	± 0.25	M.UMEDA	2005/01/14	2.5 W/B CONN. HOUSING (POSITIVE LOCK)		
30 OVER	± 0.3	CHECKED BY	DATE	MATERIAL NO.			
ANGULAR	± 3 °	KTOYODA	2005/01/14	MOLEX INCORPORATED			
DRAFT WHERE APPLICABLE MUST REMAIN WITHIN DIMENSIONS		APPROVED BY	DATE	DOCUMENT NO.		SHEET NO.	
		N.UKITA	2005/01/14	SEE CHART SD-51103-021		2 OF 2	
		THIS DRAWING CONTAINS INFORMATION THAT IS PROPRIETARY TO MOLEX INCORPORATED AND SHOULD NOT BE USED WITHOUT WRITTEN PERMISSION					

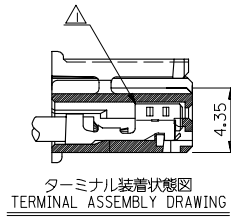
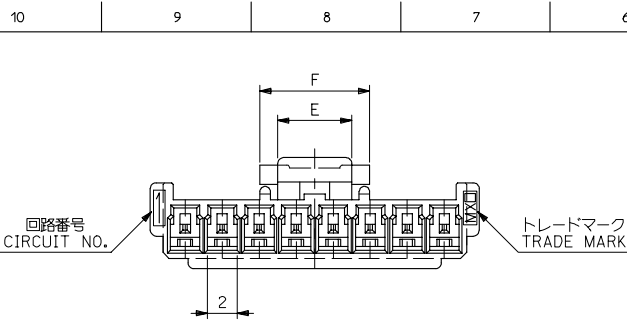

注記 NOTES

- △ 適合ターミナル : 50351-8\*00  
APPLICABLE TERMINAL : 50351-8\*00
- 2. 嵌合相手 : 53375,53376,53388,53389  
53426 シリーズ  
MATE WITH : 53375,53376,53388,53389  
53426 SERIES
- △ 偶数極の製品に適用。  
APPLY EVEN CIRCUIT PRODUCTS.

3-15 極に適用  
FOR 3-15 CKTS.

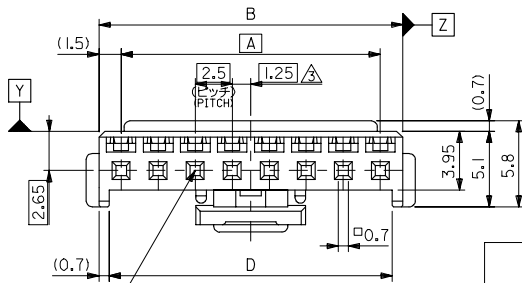
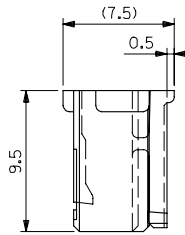
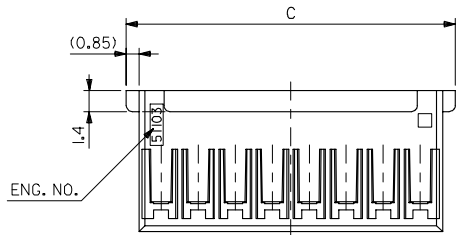

7.4	5	36.6	39.7	38	35	51103-1500	15
↑	↑	34.1	37.2	35.5	32.5	↑ -1400	14
		31.6	34.7	33	30	↑ -1300	13
		29.1	32.2	30.5	27.5	↑ -1200	12
		26.6	29.7	28	25	↑ -1100	11
		24.1	27.2	25.5	22.5	↑ -1000	10
		21.6	24.7	23	20	↑ -0900	9
		19.1	22.2	20.5	17.5	↑ -0800	8
		16.6	19.7	18	15	↑ -0700	7
		14.1	17.2	15.5	12.5	↑ -0600	6
		11.6	14.7	13	10	↑ -0500	5
7.4	5	9.1	12.2	10.5	7.5	↑ -0400	4
5	3	6.6	9.7	8	5	↑ 51103-0300	3
F	E	D	C	B	A	MATERIAL NO.	極数 OF CKT.

材料 MATERIAL  
PBTP, UL94V-0  
(色 WHITE)

仕上り FINISH —

適用電線範囲 WIRE RANGE —

被覆外径 INS. RANGE —

REVISED EC NO: J2005-3799	2005/06/20 DRAWN: MABEI	2005/06/21 CHKD: K. YODA	2005/06/27 APP: N. ITO	DESCRIPTION	GENERAL TOLERANCES (UNLESS SPECIFIED)	10 UNDER ±0.2	10 OVER ±0.25	30 OVER ±0.3	ANGULAR ±3°	DRAFT WHERE APPLICABLE MUST REMAIN WITHIN DIMENSIONS	DIMENSION STYLE MM ONLY	SCALE 4:1	DESIGN UNITS METRIC	THIRD ANGLE PROJECTION	
DRAWN BY T. ITO		DATE '92/05/06		TITLE 2.5 WIRE TO BOARD CONN HOUSING (POSITIVE LOCK)		CHECKED BY H. HIRAMOTO		DATE '95/10/03		APPROVED BY M. FUKUSHIMA		DATE '95/10/03		MATERIAL NO. SD-51103-023	
MOLEX INCORPORATED											DOCUMENT NO. SD-51103-023		SHEET NO. 1 OF 2		
SIZE A3 THIS DRAWING CONTAINS INFORMATION THAT IS PROPRIETARY TO MOLEX INCORPORATED AND SHOULD NOT BE USED WITHOUT WRITTEN PERMISSION															

10 9 8 7 6 5 4 3 2 1

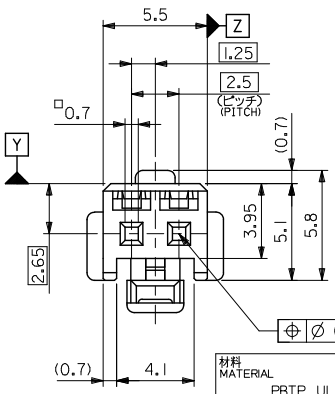
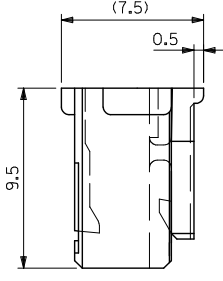
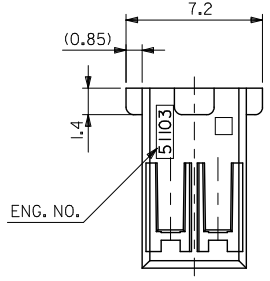
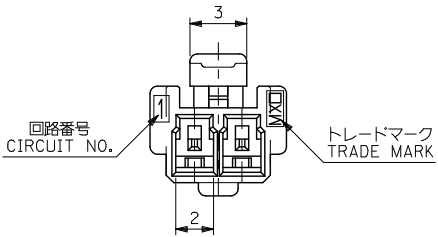

材料 MATERIAL	PBTP, UL94V-0 (白色 WHITE)
仕上げ FINISH	—
適用電線範囲 WIRE RANGE	—
被覆外径 INS. RANGE	—

**注記 NOTES**

- △ 適合ターミナル: 50351-8\*00  
APPLICABLE TERMINAL: 50351-8\*00
- 2. 嵌合相手: 53375,53426 シリーズ  
MATE WITH: 53375,53426 SERIES

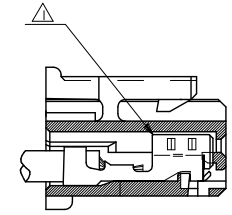

ターミナル装着状態図  
TERMINAL ASSEMBLY DRAWING

2極に適用  
FOR 2 CKTS.

51103-0200	2
MATERIAL NO.	NO. OF CKTS.
THIRD ANGLE PROJECTION	

<b>REVISED</b> IEC NO. J2005-3799 DRAWN BY: 2005/06/20 CHIKIDAKUYODA APPR. NIKITA 2005/06/27 REV. DESCRIPTION	GENERAL TOLERANCES (UNLESS SPECIFIED)		DIMENSION STYLE	SCALE	DESIGN UNITS	TITLE <b>2.5 WIRE TO BOARD CONN HOUSING (POSITIVE LOCK)</b>  <b>MOLEX INCORPORATED</b> DOCUMENT NO. <b>SD-51103-023</b> SHEET NO. 2 OF 2
	10 UNDER	± 0.2	MM ONLY	5:1	METRIC	
	10 OVER 30 UNDER	± 0.25	DRAWN BY DATE			
	30 OVER	± 0.3	CHECKED BY DATE			
	ANGULAR ± 3 °	DRAFT WHERE APPLICABLE MUST REMAIN WITHIN DIMENSIONS	APPROVED BY DATE			
			SEE CHART			
			THIS DRAWING CONTAINS INFORMATION THAT IS PROPRIETARY TO MOLEX INCORPORATED AND SHOULD NOT BE USED WITHOUT WRITTEN PERMISSION			