



Distributor of Molex Connector Corporation: Excellent Integrated System Limited
Datasheet of 0545991019 - Connector Plug Serial I/O 10 Position Free Hanging (In-Line)

Contact us: sales@integrated-circuit.com Website: www.integrated-circuit.com

Excellent Integrated System Limited

Stocking Distributor

Click to view price, real time Inventory, Delivery & Lifecycle Information:

[Molex Connector Corporation](#)
[0545991019](#)

For any questions, you can email us directly:

sales@integrated-circuit.com

部品構成
PARTS CONSTRUCTION

部番 NO.	部品名 PART NAME	製品番号 ENG. NO.	個数 QUAN.	材質 MATERIAL
①	ハウジングアッセンブリ HOUSING ASS'Y	54593-1016	1	ハウジング: ポリアミド, UL 94V-0 色:黒 HOUSING: POLYAMIDE, UL94V-0 COLOR:BLACK ターミナル:りん青銅 t0.3 TERMINAL: PHOSPHOR BRONZE t0.3 メッキ仕様 接点部: ニッケル下地金メッキ PLATING CONTACT AREA: GOLD OVER NICKEL 結線部: ニッケル下地金メッキ WIRE TERMINATION AREA: TIN OVER NICKEL
②	カバーA COVER A	54594-1015	1	カバーA: ガラス入りポリカーボネイト樹脂 COVER A: POLYCARBONATE G.F. UL 94V-0 色:グレー UL94V-0 COLOR: GRAY スプリングラッチ: ステンレス鋼 t0.4 SPRING LATCH: STAINLESS STEEL t0.4
③	カバーB COVER B	54595-1005	1	ガラス入りポリカーボネイト樹脂 UL 94V-0 色:グレー POLYCARBONATE G.F. UL94V-0 COLOR: GRAY
④	シェル カバー SHELL COVER	58935-1028	1	りん青銅 t0.4 PHOSPHOR BRONZE t0.4
⑤	シェル ボディ SHELL BODY	58934-1028	1	メッキ仕様: ニッケル下地, 錫メッキ PLATING: NICKEL BASE, TIN PLATING
⑥	ケーブルクランプ CABLE CLAMP	58937-0000	1	ステンレス鋼 STAINLESS STEEL
⑦	十字穴付きなべ小ネジ CROSS RECESSED PAN HEAD MACHINE SCREW	58203-0010	2	鋼 (ネジサイズ: M2X5) STEEL (SCREW SIZE: M2X5)

注記: 1. 本製品は 54599-1015 の鉛フリー品である。
 NOTES: THIS PRODUCT IS LEAD FREE OF 54599-1015.

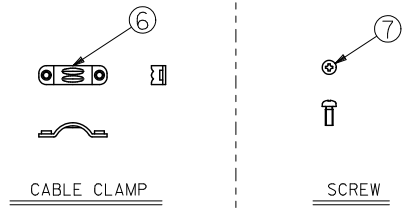

CABLE CLAMP

SCREW

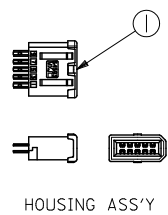

HOUSING ASS'Y

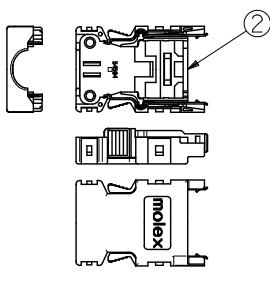

COVER A

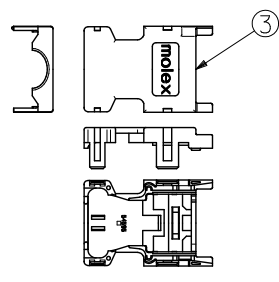

COVER B

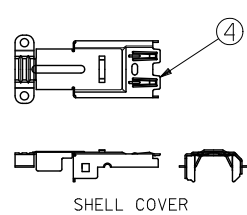

SHELL COVER

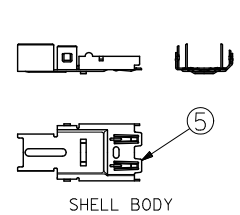

SHELL BODY

54599-1019	54599-101*
MATERIAL NO.	MODEL NO.

REVISED EC NO. J2010-0635 DRAWN BY: DRW:HSATO CHKD:HMATSUMOTO APPR:HIRATA REV: A	GENERAL TOLERANCES (UNLESS SPECIFIED)		DIMENSION STYLE MM ONLY		SCALE ---	DESIGN UNITS METRIC	THIRD ANGLE PROJECTION
	10 UNDER	± ---	DRAWN BY M. NABEI	DATE 2004/04/14	TITLE 2.0 I/O CONN. HAND/S TYPE PLUG SET -LEAD FREE-		
	10 OVER 30 UNDER	± ---	CHECKED BY K. TOJO	DATE 2004/04/14	MOLEX INCORPORATED		
	30 OVER	± ---	APPROVED BY HIRATA	DATE 2010/02/25	DOCUMENT NO. SD-54599-006		
ANGULAR ± --- °		DRAFT WHERE APPLICABLE MUST REMAIN WITHIN DIMENSIONS		MATERIAL NO. SEE TABLE		SHEET NO. 1 OF 3	
SIZE A3 THIS DRAWING CONTAINS INFORMATION THAT IS PROPRIETARY TO MOLEX INCORPORATED AND SHOULD NOT BE USED WITHOUT WRITTEN PERMISSION							

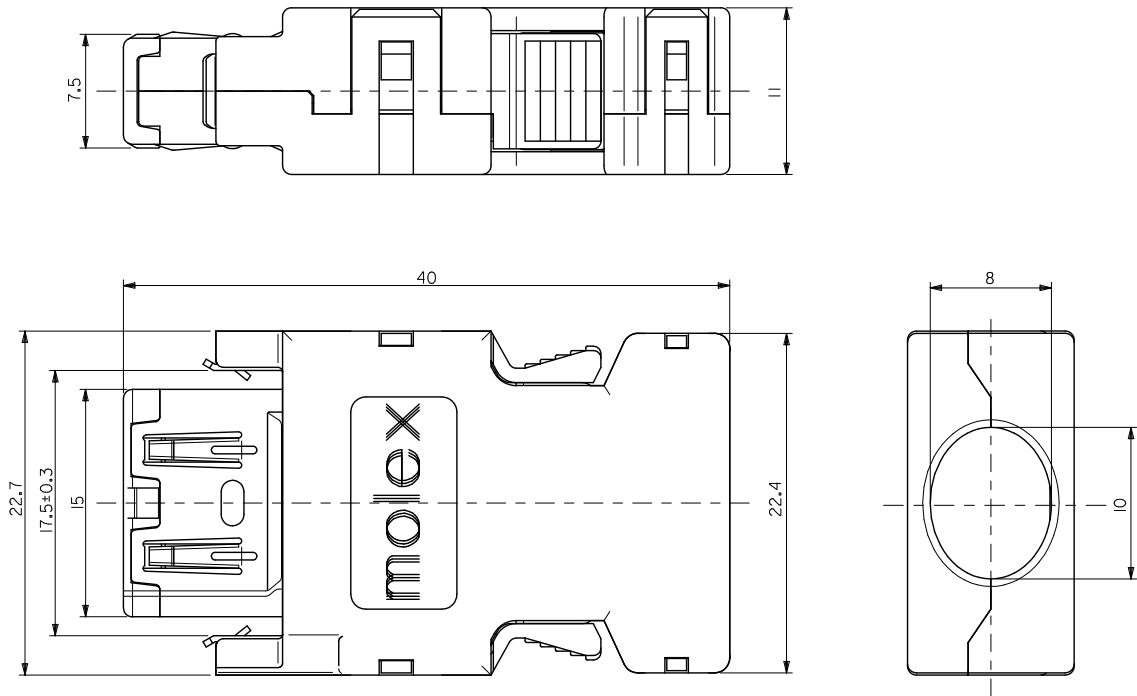

REVISED EC NO. J2010-0635 DRAWN BY DRW:ESATO 2010/02/25 CHK:OHMATSUMOTO 2010/02/25 APPR:HIRATA 2010/02/25 REV A	GENERAL TOLERANCES (UNLESS SPECIFIED)		DIMENSION STYLE MM ONLY		SCALE ---	DESIGN UNITS METRIC	MODEL NO. 54599-101
	10 UNDER	± ---	DRAWN BY	DATE	TITLE 2.0 I/O CONN. HAND/S TYPE PLUG SET -LEAD FREE-		
	10 OVER 30 UNDER	± ---	M. NABEI	2004/04/14	MOLEX INCORPORATED		
	30 OVER	± ---	K. TOJO	2004/04/14	SD-54599-006		
ANGULAR ± --- °		APPROVED BY HIRATA		DATE	SHEET NO. 2 OF 2		
DRAFT WHERE APPLICABLE MUST REMAIN WITHIN DIMENSIONS		MATERIAL NO.		2010/02/25	DOCUMENT NO. EN-02JA(021)		
		SEE TABLE		THIS DRAWING CONTAINS INFORMATION THAT IS PROPRIETARY TO MOLEX INCORPORATED AND SHOULD NOT BE USED WITHOUT WRITTEN PERMISSION			

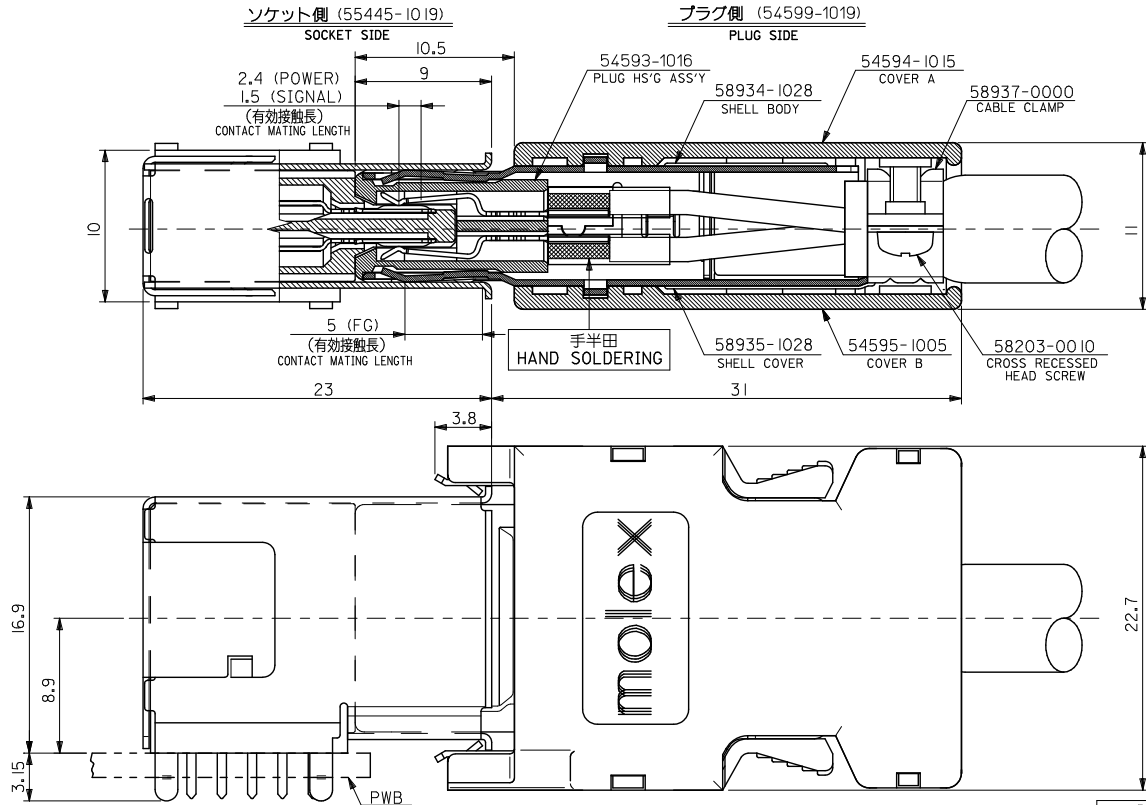

REVISED IEC NO. J2010-0635 DRAWN BY: DRW:NESATO CHIKUHMATSUMOTO APPROV:HIRATA DATE: 2010/02/25 DESCRIPTION: 2010/02/25 REV: A	GENERAL TOLERANCES (UNLESS SPECIFIED)		DIMENSION STYLE	SCALE	54599-101*	MODEL NO.	
	10 UNDER ±---		MM ONLY	---	DESIGN UNITS	THIRD ANGLE PROJECTION	
	10 OVER 30 UNDER ±---		DRAWN BY DATE		METRIC	2.0 I/O CONN. HAND/S TYPE PLUG SET -LEAD FREE-	
	30 OVER ±---		M. NABEI 2004/04/14	TITLE		MOLEX INCORPORATED	
ANGULAR ±---°		CHECKED BY DATE			DOCUMENT NO.	SHEET NO.	
DRAFT WHERE APPLICABLE MUST REMAIN WITHIN DIMENSIONS		K. TOJO 2004/04/14	APPROVED BY DATE		SD-54599-006	3 OF 3	
		HIRATA 2010/02/25	MATERIAL NO.		THIS DRAWING CONTAINS INFORMATION THAT IS PROPRIETARY TO MOLEX INCORPORATED AND SHOULD NOT BE USED WITHOUT WRITTEN PERMISSION		
			SEE TABLE				
			SIZE				
			A3				