

## Excellent Integrated System Limited

Stocking Distributor

Click to view price, real time Inventory, Delivery & Lifecycle Information:

[Dialight](#)  
[5530004805F](#)

For any questions, you can email us directly:  
[sales@integrated-circuit.com](mailto:sales@integrated-circuit.com)



**Distributor of Dialight: Excellent Integrated System Limited**

Datasheet of 5530004805F - LED CBI 3MM X/X/ORN/GRN MULTILVL

Contact us: sales@integrated-circuit.com Website: www.integrated-circuit.com

PART NUMBER	POS.1	POS.2	POS.3	POS.4
553-0004-805	BLANK	BLANK	ORANGE	GREEN

LED ELECTRO-OPTICAL CHARACTERISTICS

PARAMETER	GREEN	ORANGE	UNITS	TEST COND.	SPECS
POWER DISSIPATION	100	135	mW	N/A	ABSOLUTE MAXIMUM RATINGS AT T <sub>A</sub> = 25°C
FORWARD DC CURRENT	30	25	mA		
OPERATING TEMPERATURE	-55° TO +100°	-55° TO +100°	°C		
STORAGE TEMPERATURE	-55° TO +100°	-55° TO +100°	°C		
LEAD SOLDERING TEMP. (1/16" FROM CASE)	260° FOR 5 SEC.		°C		
FORWARD VOLTAGE	TYP 2.1#	2.2	V		
REVERSE BREAKDOWN VOLTAGE	5 MIN.		V	I <sub>R</sub> = 100µA	OPERATING CHAR. AT T <sub>A</sub> = 25°C
PEAK WAVELENGTH	565	600	nm	MEAS. AT PEAK	
LUMINOUS INTENSITY	MIN 4.7	3.0	mc/d	I <sub>F</sub> = 10mA	

REV.	ECN NO.	REVISIONS	DRN.	CKD.	APP.	DATE
A		NEW RELEASE		DC		1-13-95
B		GREEN PWR DISS. 100 WAS 135; FWD DC CURRENT 30 WAS 25. FWD VOLT TYP 2.1, MAX 2.8 WAS 2.3, 3.0; LUM. INT. 4.7 WAS 4.0; ADDED NOTE 3.		TC		

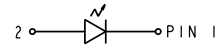
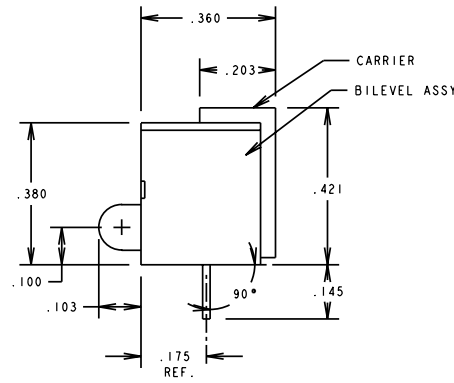
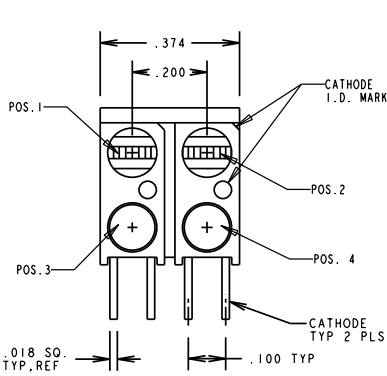

NOTES:

- LEADS TO FIT INTO .040 DIA. HOLES SPACED AS PER PATTERN.
- PIN NUMBERS FOR REFERENCE ONLY. DESIGNATION NON-EXISTENT ON PARTS.
- DIALIGHT PART NUMBER: 553-0004-805.

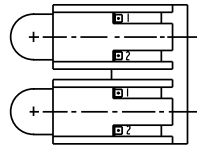
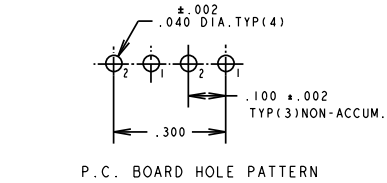

THIS DRAWING AND THE CONTENTS HERE IN ARE CONFIDENTIAL AND THE SOLE PROPERTY OF DIALIGHT. REPRODUCTION OF THIS DRAWING OR CONSTRUCTION OF ANY PARTS WITHIN THIS DRAWING ARE FORBIDDEN WITHOUT THE WRITTEN CONSENT OF DIALIGHT.	
SCALE: 4:1	DRAWING NUMBER
ALL DIM'S IN: INCHES	C-15934
TOLERANCES: UNLESS OTHERWISE SPECIFIED	REV B
FRACTIONS: ±1/64	TITLE
DECIMALS (.XX): ±.020	MATERIAL
DECIMALS (.XXX): ±.015	FINISH:
ANGLES: ±3°	FSCM 83330
FINISH:	Dialight
	1913 ATLANTIC AVE. MANASQUAN, N.J. 08736
	SHEET OF FAMILY TABLE: