

## Excellent Integrated System Limited

Stocking Distributor

Click to view price, real time Inventory, Delivery & Lifecycle Information:

[Dialight](#)  
[5680004861F](#)

For any questions, you can email us directly:  
[sales@integrated-circuit.com](mailto:sales@integrated-circuit.com)

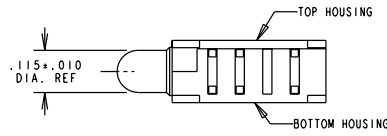
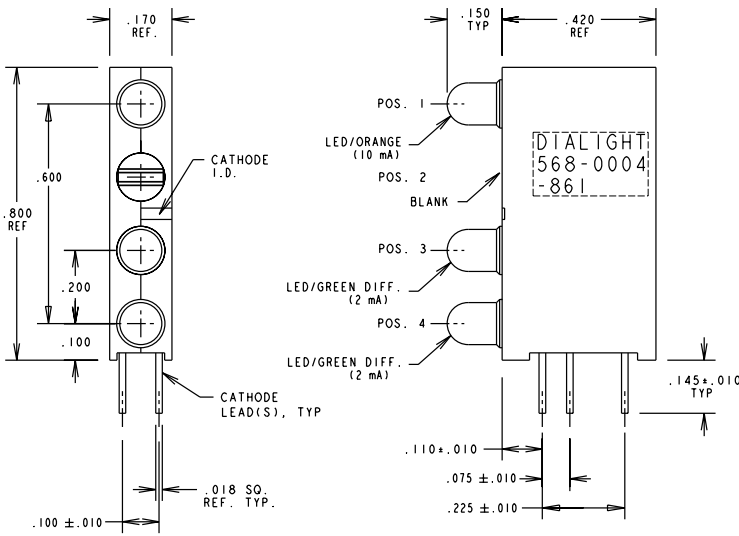

REV.	ECN NO.	REVISIONS	DRN.	CKD.	APP.	DATE
A		NEW RELEASE	TC		N.O.	1-9-97
B		CHANGE "CLAMHELL" DESIGN TO NEW "BOTTOM INSERT" DESIGN; DELETED LED SCHEMATIC AND PIN NUMBER DESIGNATIONS; DELETED OLD NOTE 1 AND ADDED NEW NOTES 1 THRU 3 AND TITLE NAME ON TITLE BLOCK.	TC	D.C.	N.O.	2-12-99
C		CHANGE BACK TO "CLAMHELL" DESIGN; TOP LED LEAD LENGTH NOT LONG ENOUGH FOR NEW "BOTTOM INSERT" DESIGN.	DC			

NOTES:  
1- LEADS TO FIT INTO HOLES SPACED AS PER HOLE PATTERN GAUGE  
2- LED LEAD DIMENSIONS SHOWN ARE MEASURED AT HOUSING EXIT.  
3- DIALIGHT PART NUMBER: 568-0004-861

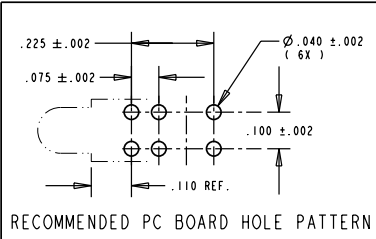

OPERATING CHARACTERISTICS AT 25°C AMBIENT						
CHARACTERISTICS	COLOR	MIN	TYP	MAX	UNITS	TEST CONDITIONS
LUMINOUS INTENSITY	ORANGE	3.0	6.5		mcd	I <sub>f</sub> = 10 mA
	GREEN	1.0	1.6			I <sub>f</sub> = 2 mA
FORWARD VOLTAGE	ORANGE	1.5	2.2	3.0	V	I <sub>f</sub> = 10 mA
	GREEN	1.8	2.2			I <sub>f</sub> = 2 mA
REVERSE VOLTAGE	ORANGE	5			V	I <sub>r</sub> = 100 μA
	GREEN	5				I <sub>r</sub> = 50 μA
PEAK WAVELENGTH	ORANGE		600		nm	
	GREEN		565			

THIS DRAWING AND THE CONTENTS HEREIN ARE CONFIDENTIAL AND THE SOLE PROPERTY OF DIALIGHT. REPRODUCTION OF THIS DRAWING OR CONSTRUCTION OF ANY PARTS WITHIN THIS DRAWING ARE FORBIDDEN WITHOUT THE WRITTEN CONSENT OF DIALIGHT.		
SCALE 4:1	DRAWING NUMBER	REV
ALL DIM'S IN: INCHES	C-16171	C
TOLERANCES: UNLESS OTHERWISE SPECIFIED	TITLE STANDARD 4X1 CBI BLOCK	
FRACTIONS: 1/64	MATERIAL	
DECIMALS (.XX): ±.020	Dialight	
DECIMALS (.XXX): ±.015	1913 ATLANTIC AVE. MANASQUAN, N.J. 08736	
ANGLES: ±3°	FSCM 83330	
FINISH:	SHEET OF	FAMILY TABLE: