

## Excellent Integrated System Limited

Stocking Distributor

Click to view price, real time Inventory, Delivery & Lifecycle Information:

[Curtis Instruments](#)  
[201PCR5VDC](#)

For any questions, you can email us directly:

[sales@integrated-circuit.com](mailto:sales@integrated-circuit.com)

## SOLID STATE ELAPSED TIME MONITOR

### 200 SERIES

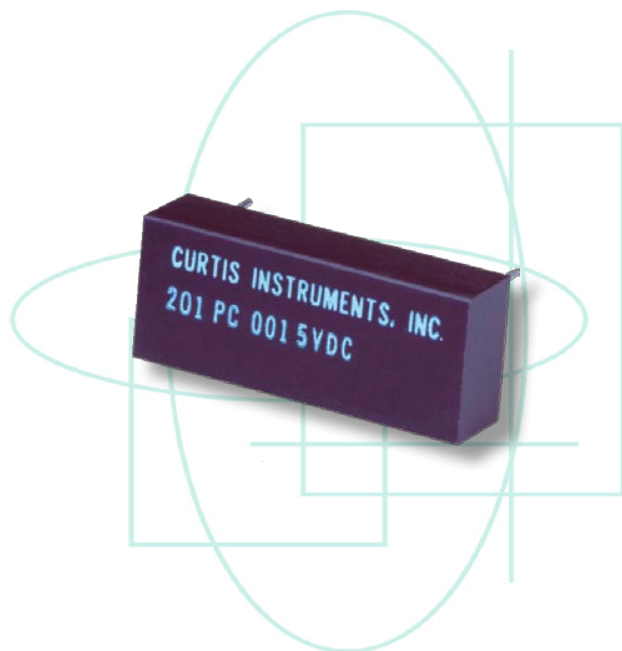
**CURTIS**

### DESCRIPTION

The Curtis 200 series are elapsed time monitors without displays that offer unprecedented levels of reliability, performance and flexibility.

### APPLICATION

A wide range of applications including maintenance, total hours monitoring, true warranty verification and leasing for commercial, medical, industrial equipment and vehicles.

### FEATURES

- High levels of reliability and accuracy for consistent data acquisition and storage.
- Silent operation – no moving parts. Eliminates gear and motor noise.
- Serial digital output for PC or peripheral reader interface.
- Safe, reliable EEPROM memory storage of data without battery back up.
- Optional resettable version available.
- Compact size designed for easy, PC board mounting.
- Memory will arm only when power has been applied for five seconds (with no loss of time).
- Low power consumption.
- Over 45 years of Curtis design experience and Elapsed Time Indicators expertise.

### SPECIFICATIONS

- Voltage Range:  
4.75 – 10 VDC
- Reset Voltage:  
20VDC +/- 5%
- Reset Pulse Width:  
100 micro sec minimum; 1 sec max
- Recording and Display Capability:  
99,999.99 hours
- Resolution:  
0.01 hours
- Accuracy:  
+/- 0.1% hours
- Current Consumption:  
0.4mA (max) @ 5VDC
- Operating Temperature:  
-40° C to +85° C
- Storage Temperature:  
-45° C to +90° C

## 200 SERIES

### DIMENSIONS mm

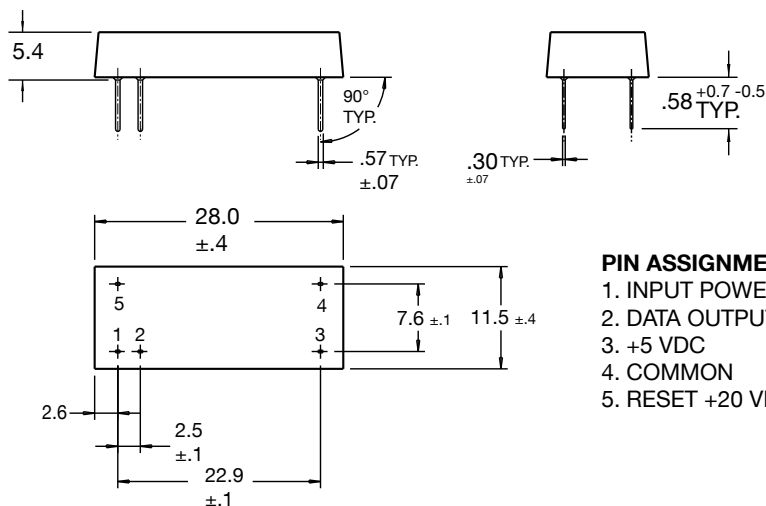

#### PIN ASSIGNMENT

1. INPUT POWER FROM READER
2. DATA OUTPUT
3. +5 VDC
4. COMMON
5. RESET +20 VDC  $\pm 5\%$

### MODEL ENCODEMENT

#### 201

Elapsed Time Monitor

#### PC

PC Board Mount

#### N

N = Non Reset

R = Reset

**WARRANTY** Two year limited warranty from time of delivery.