

## Excellent Integrated System Limited

Stocking Distributor

Click to view price, real time Inventory, Delivery & Lifecycle Information:

[Molex Connector Corporation](#)  
[03-06-1241](#)

For any questions, you can email us directly:

[sales@integrated-circuit.com](mailto:sales@integrated-circuit.com)

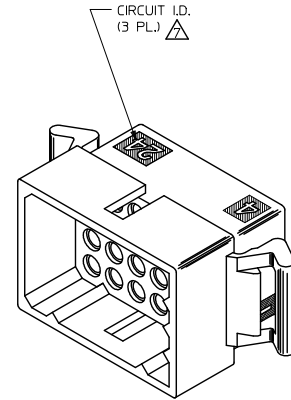
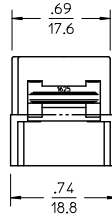
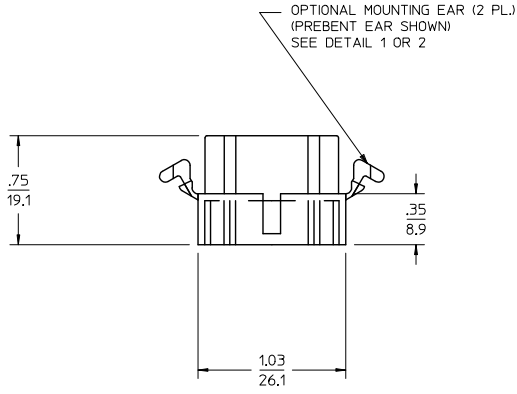
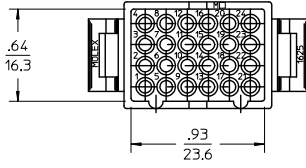

PLUG HOUSING

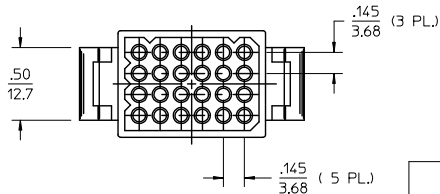

PK SPEC EC NO: UCP2015-0466 DRAWN BY: JDFOX CHKD BY: MKIPPER APPROVED BY: F SMITH	DESCRIPTION 2014/08/07 2014/08/07 2014/08/14	QUALITY SYMBOLS ▽=0 ▽=0 ▽=0	GENERAL TOLERANCES (UNLESS SPECIFIED)		DIMENSION STYLE		SCALE	DESIGN UNITS	THIRD ANGLE PROJECTION
			mm	INCH	IN/MM	2:1	INCH	INCH	
4 PLACES ± --- ± ---			DRAWN BY: JDFOX		DATE: 2014/08/07		TITLE .062/(1,57) HOUSINGS PLUG AND RECEPTACLE 24 CIRCUIT <b>molex</b>		
3 PLACES ± --- ± ---			CHECKED BY: MKIPPER		DATE: 2014/08/07				
2 PLACES ± 0.25 ± .014			APPROVED BY: F SMITH		DATE: 2014/08/14		MATERIAL NO. _____ DOCUMENT NO. SD-1625-24* SHEET NO. 1 OF 3		
1 PLACE ± 0.36 ± ---			ANGULAR ± 1/2°		SEE CHART		THIS DRAWING CONTAINS INFORMATION THAT IS PROPRIETARY TO MOLEX INCORPORATED AND SHOULD NOT BE USED WITHOUT WRITTEN PERMISSION		
0 PLACE ± --- ± ---			DRAFT WHERE APPLICABLE MUST REMAIN WITHIN DIMENSIONS		SIZE C				

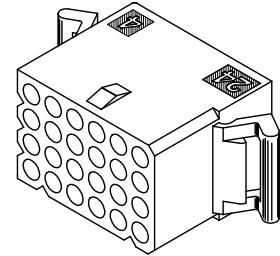
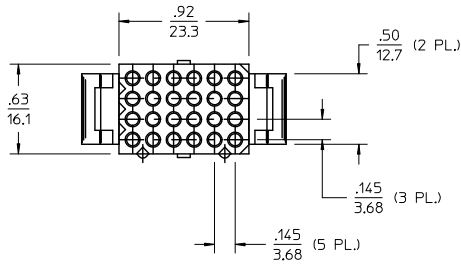
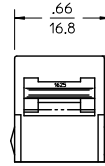
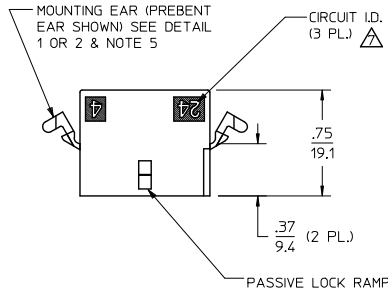
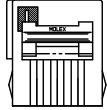
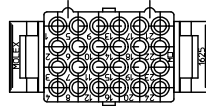

RECEPTACLE HOUSING

SEE SHEET 1 EC NO: UCP2015-0466 DRAWN: JDFOX 2014/08/07 CHECKED: MKIPPER 2014/08/07 APPROVED: F SMITH 2014/08/14 P1 REV	QUALITY SYMBOLS ∇=0 ∇=0 ∇=0	GENERAL TOLERANCES (UNLESS SPECIFIED)		DIMENSION STYLE IN/MM		SCALE 2:1	DESIGN UNITS INCH	THIRD ANGLE PROJECTION			
		4 PLACES ± --- ± ---	3 PLACES ± --- ± .010	2 PLACES ± 0.25 ± .014	1 PLACE ± 0.36 ± ---	0 PLACE ± --- ± ---	DRAWN BY JDFOX	DATE 2014/08/07	TITLE .062/(1.57) HOUSINGS PLUG AND RECEPTACLE 24 CIRCUIT		
		ANGULAR ±1/2°					MATERIAL NO. SEE CHART	DOCUMENT NO. SD-1625-24*			SHEET NO. 2 OF 3
		DRAFT WHERE APPLICABLE MUST REMAIN WITHIN DIMENSIONS					THIS DRAWING CONTAINS INFORMATION THAT IS PROPRIETARY TO MOLEX INCORPORATED AND SHOULD NOT BE USED WITHOUT WRITTEN PERMISSION				

PLUG		RECEPTACLE	
PART NO.	ENG. NO.	PART NO.	ENG. NO.
03-06-2241	1625-24P	03-06-1241	1625-24R
03-06-2242	1625-24PI	03-06-6241	1625-24RBK
03-06-7241	1625-24PBK		
03-06-7242	1625-24PIBK		

**LEGEND:**  
1625-24\*\*\*\*

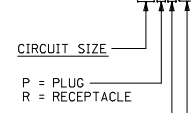

CIRCUIT SIZE  
P = PLUG  
R = RECEPTACLE

BLANK = WITH MOUNTING EARS  
I = WITHOUT EARS

COLOR:  
BLANK = NATURAL COLOR  
AM = AMBER BK = BLACK BU = BLUE  
BN = BROWN GY = GRAY GN = GREEN  
OR = ORANGE RD = RED YW = YELLOW

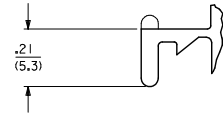

**DETAIL 1**  
.062/(1.57) STANDARD MOUNTING EAR  
(SCALE 4:1)

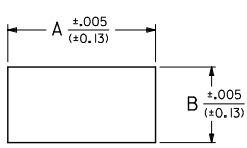
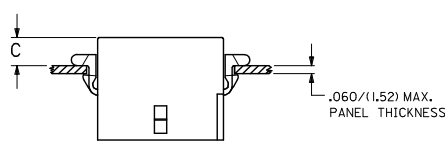

**RECOMMENDED HOLE PATTERN**

RECEP.	1.079 (27.41)	.715 (18.16)	.22 (5.5)	.22 (5.7)
PLUG	1.182 (30.02)	.765 (19.43)	.24 (6.0)	.24 (6.2)
PART	DIM. A	DIM. B	DIM. C (STANDARD EAR)	DIM. C (PREBEND EAR)

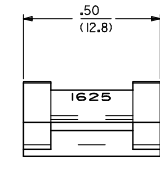

**DETAIL 2**  
.062/(1.57) PREBEND MOUNTING EAR  
(SCALE 4:1)

- NOTES:
1. MATERIAL: NYLON TYPE 6/6, UL94V-2. COLOR: SEE LEGEND.
  2. FINISH: NONE.
  3. MOLEX PRODUCT SPEC PS-02-06 APPLIES.
  4. PACKAGING SPECIFICATION: PK-1625-003.
  5. WHERE DENOTED IN CHART, TOOLS ARE BUILT WITH PREBEND MOUNTING EARS PER DETAIL 2 AND SUPERSEDE ALL TOOLS PREVIOUSLY BUILT WITH THE STANDARD MOUNTING EAR.
  6. THIS HOUSING FOR USE WITH .062/(1.57) DIA. TERMINALS.
  7. CIRCUIT I.D. NUMBERS ON HOUSING APPEAR ON PART FROM TOOLS BUILT AFTER 8/5/91.
  8. PARTS CONFORM TO CLASS B REQUIREMENTS OF COSMETIC SPECIFICATION PS-45499-002.

SEE SHEET 1 IEC NO: UCP2015-0466 DRAWN BY: JDFOX 2014/08/07 CHECKED BY: CHKORAKIPER 2014/08/07 APPROVED BY: FSMITH 2014/08/14	QUALITY SYMBOLS □=0 □=0 □=0	GENERAL TOLERANCES (UNLESS SPECIFIED)		DIMENSION STYLE IN/MM		SCALE 2:1	DESIGN UNITS INCH	THIRD ANGLE PROJECTION	
		4 PLACES ± --- ± ---		DRAWN BY JDFOX DATE 2014/08/07		.062/(1.57) HOUSINGS PLUG AND RECEPTACLE 24 CIRCUIT DOCUMENT NO. SD-1625-24* SHEET NO. 3 OF 3			
		3 PLACES ± --- ± .010		CHECKED BY MKIPPER DATE 2014/08/07					
		2 PLACES ± 0.25 ± .014		APPROVED BY FSMITH DATE 2014/08/14					
1 PLACE ± 0.36 ± ---		0 PLACE ± --- ± ---							
ANGULAR ± 1/2°		MATERIAL NO.		SEE CHART					
DRAFT WHERE APPLICABLE MUST REMAIN WITHIN DIMENSIONS		SIZE C		THIS DRAWING CONTAINS INFORMATION THAT IS PROPRIETARY TO MOLEX INCORPORATED AND SHOULD NOT BE USED WITHOUT WRITTEN PERMISSION					