

Excellent Integrated System Limited

Stocking Distributor

Click to view price, real time Inventory, Delivery & Lifecycle Information:

[Hammond Manufacturing](#)
[1590K431](#)

For any questions, you can email us directly:

sales@integrated-circuit.com

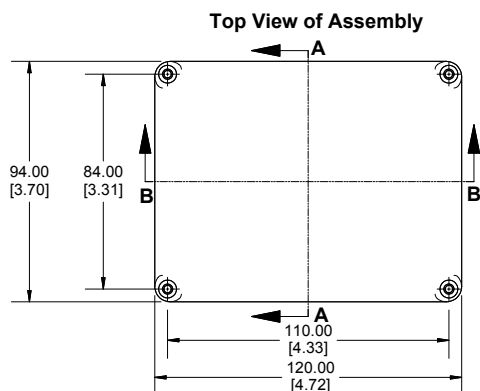

SECTION A-A
End View of Assembly

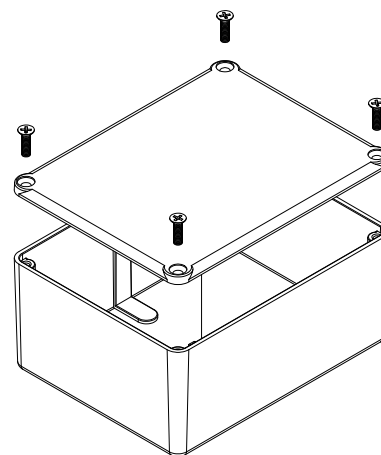
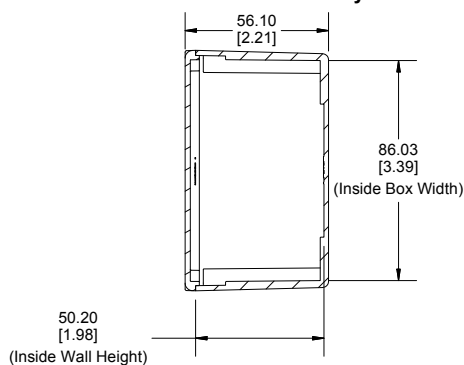

SECTION B-B
Side View of Assembly

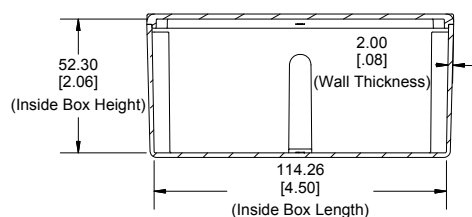

Top View Looking Inside Box

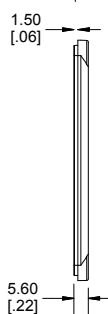
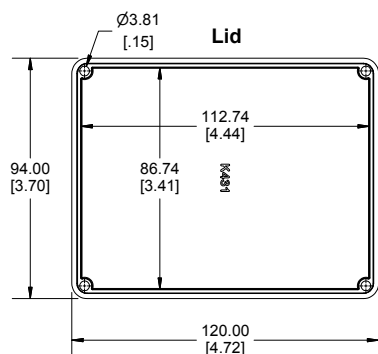
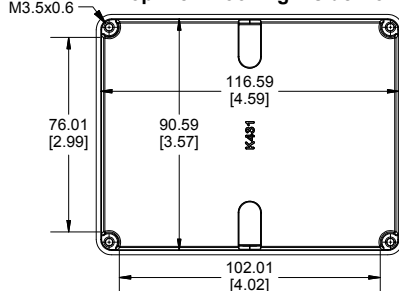

Enclosures can be Factory Modified (Milling, Drilling, Printing etc.)
Contact Factory mjm@hammondmfg.com for quotes
Solid models of this enclosure available in STEP or IGES.

NOTE

Purchased assembly includes box, lid and 4 cover screws.
Box and lid are made from Diecast Zinc Alloy.

PART NUMBERS

1590K431 Enclosure

Natural Finish Enclosure

1590K431

ACCESSORIES

Recommended Torque: 75 ozf.in / 55 cN.m

Plated Cover Screws (Pkg 100)
[M3.5 x 12mm]

1550MS100



HAMMOND
MANUFACTURING™

1590K431

www.hammondmfg.com

Dimensions:
mm
[inches]