

## **Excellent Integrated System Limited**

Stocking Distributor

Click to view price, real time Inventory, Delivery & Lifecycle Information:

[Amphenol RF](#)  
[122428](#)

For any questions, you can email us directly:

[sales@integrated-circuit.com](mailto:sales@integrated-circuit.com)

REV.	DATE	DESCRIPTION
A	05/01/04	UPDATE DRAWING FORMAT

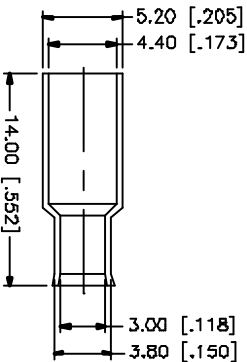
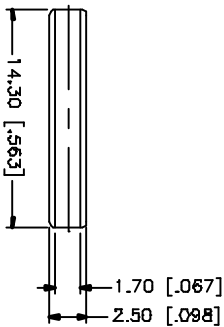
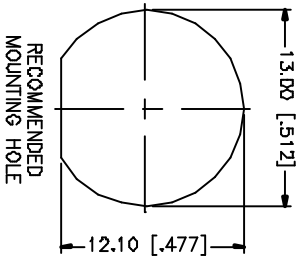
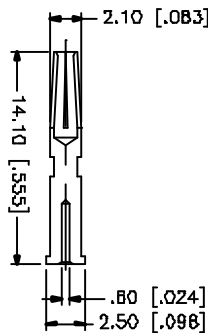
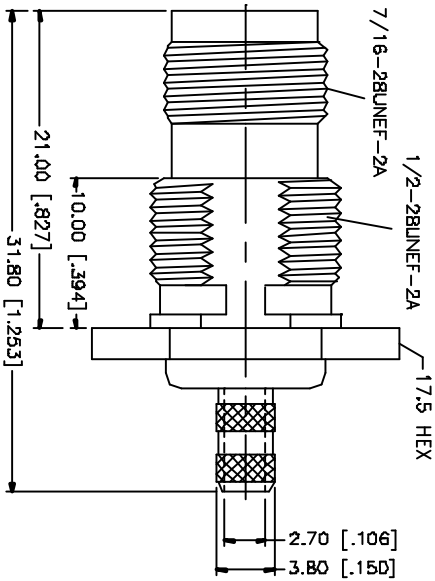
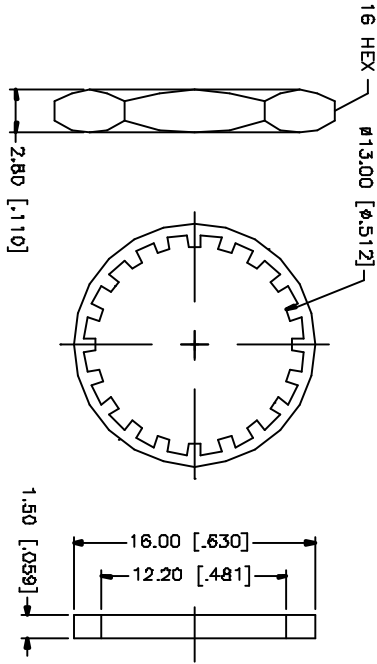
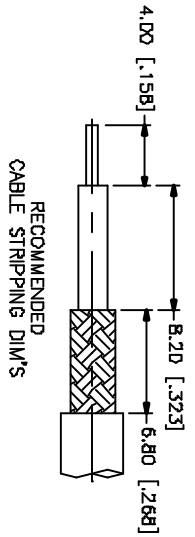

8	FERRULE	COPPER	NICKEL	1	UNLESS OTHERWISE SPECIFIED DIMENSIONS ARE IN MILLIMETERS. DIMENSIONS IN [ ] ARE IN INCHES AND FOR CONSUMER REFERENCE ONLY. UNLESS OTHERWISE SPECIFIED TOLERANCES FOR MILLIMETERS ARE: A - 30mm ± 0.20mm B - 30mm ± 0.40mm C - 120mm ± 0.50mm UNLESS OTHERWISE SPECIFIED TOLERANCES FOR INCHES ARE: .020 - .315 = ± 0.007" .315 - 1.180 = ± 0.015" 1.180 - 4.724 = ± 0.020"	APPROVALS DRAWN G.R.S. CHECKED ISSUED SHEET 1 OF 1	DATE 05/01/04	PART DESCRIPTION <b>TNC BULKHEAD CRIMP JACK</b> (FOR RG-174/U, 188A/U, 316/U)				
7	SLEEVE	DELFIN	NATURAL	1								
6	CONTACT PIN	PHOS. BRONZE	GOLD	1								
5	HEX NUT	BRASS	NICKEL	1								
4	LOCK WASHER	BRASS	NICKEL	1								
3	GASKET	RUBBER	RED	1								
2	INSULATOR	TEFLON	NATURAL	1								
1	BODY	BRASS	NICKEL	1								
DESCRIPTION		MATERIAL		FINISH	QTY	DO NOT SCALE DRAWING		CAD FILE	DWG. NO.	REV.	SIZE	SCALE
								C:/122/122428.DWG	122428.DWG	A	A	NA

**Amphenol Connex**