

## Excellent Integrated System Limited

Stocking Distributor

Click to view price, real time Inventory, Delivery & Lifecycle Information:

[Molex Connector Corporation](#)  
[0479890132](#)

For any questions, you can email us directly:

[sales@integrated-circuit.com](mailto:sales@integrated-circuit.com)

10 9 8 7 6 5 4 3 2 1

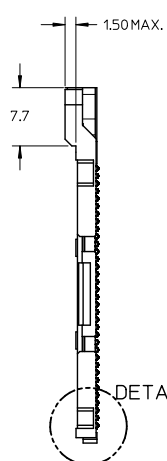
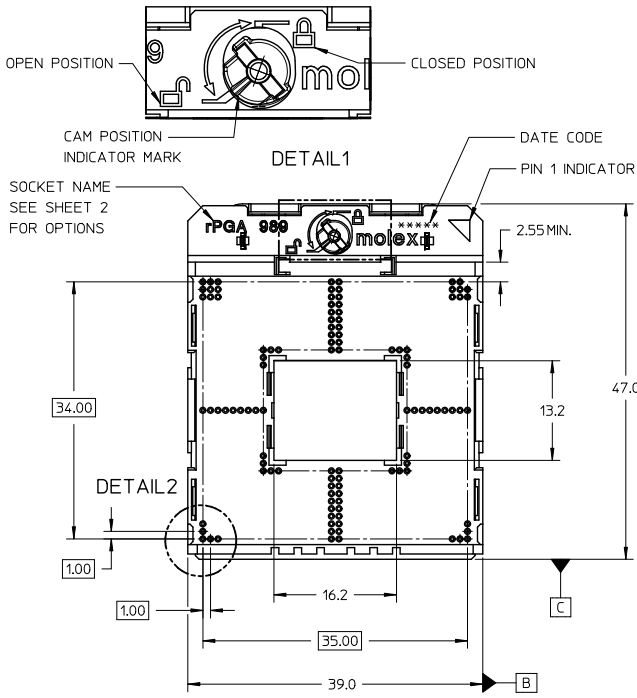

- NOTES:
- 1) THIS SOCKET COMPLIES WITH ALL SPECIFICATIONS AND PERFORMANCE REQUIREMENTS FOR INTEL rPGA98X SERIES CPU PROCESSORS.
  - 2) SOCKET SHOWN IN OPEN POSITION.
  - 3) SEE SHEET 2 FOR DETAILS PERTAINING TO KEYING, MATERIAL AND PACKAGING OPTIONS.
  - 4) THIS PRODUCT SERIES COMPLIANT TO RoHS DIRECTIVE 2002/95/EC AND ELV DIRECTIVE 2000/53/EC.

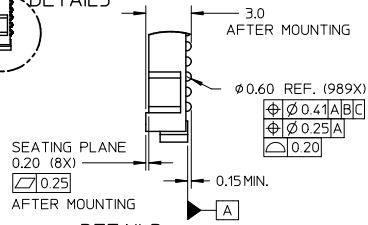
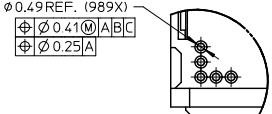
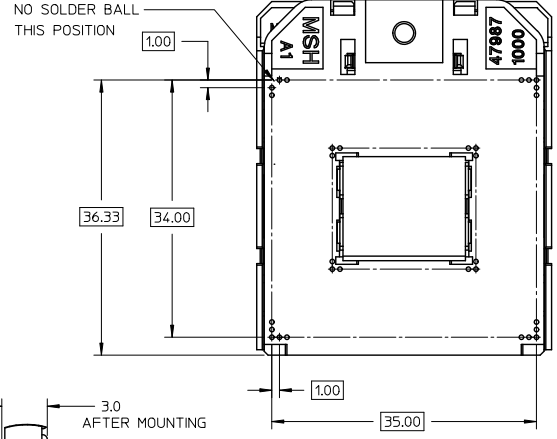

DETAIL3

REVISED EC NO: SH2011-0076 DRAWN BY: DRWANZHYAN CHKD: CHKD: APP: AYIN	2010/09/03 2010/09/06 2010/09/17	QUALITY SYMBOLS ▽=0 ▽=0 ▽=0	DESCRIPTION	GENERAL TOLERANCES (UNLESS SPECIFIED)		DIMENSION STYLE MM ONLY		SCALE 2:1	DESIGN UNITS METRIC	THIRD ANGLE PROJECTION	
				4 PLACES ± --- ± ---	3 PLACES ± --- ± ---	2 PLACES ± 0.10 ± ---	1 PLACE ± 0.20 ± ---	ANGULAR ± 2 °	DRAWN BY: QWFANG DATE: 2008/04/25	CHECKED BY: JKACHLIC DATE: 2008/05/29	APPROVED BY: CL IANG DATE: 2008/05/29
DRAFT WHERE APPLICABLE MUST REMAIN WITHIN DIMENSIONS				THIS DRAWING CONTAINS INFORMATION THAT IS PROPRIETARY TO MOLEX INCORPORATED AND SHOULD NOT BE USED WITHOUT WRITTEN PERMISSION							

9 8 7 6 5 4 3 2 1

10 9 8 7 6 5 4 3 2 1

REMOVEABLE PICK & PLACE CAP

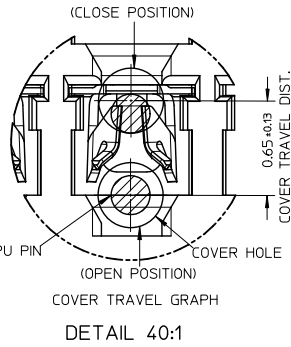
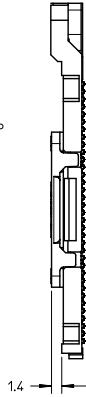
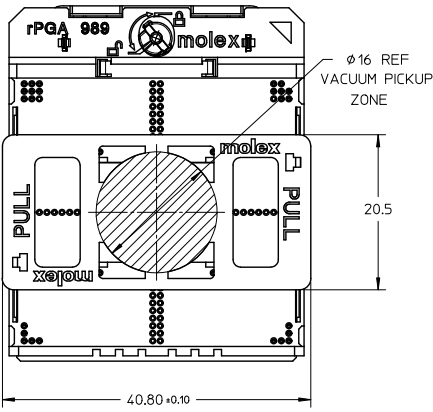

NOTES:

1) MATERIALS:

- MOLDED COMPONENTS: LIQUID CRYSTAL POLYMER (LCP) UL 94V-0
- BASE HOUSING COLOR: BLACK
- COVER COLOR: NATURAL
- MYLAR(POLYIMIDE, COLOR:ORANGE) OR PnP COVER(LCP, COLOR: BLACK) FOR PICK & PLACE.
- CONTACTS: HIGH STRENGTH COPPER ALLOY
- PLATING: GOLD THICKNESS AS FOLLOWING TABLE 1-3 IN CONTACT AREA, 1.3µm NICKEL OVERALL
- CAM COMPONENTS: STAINLESS STEEL
- SOLDER BALL: LEAD-FREE BALL SnAg3.0Cu0.5

2) DATE CODE \*\*\*\*\*

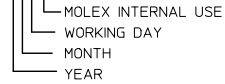

3) PRODUCT SPECIFICATION PS-47989-00\* APPLIES

- 4) PACKAGING SPECIFICATION: PK-47989-001 (TAPE & REEL)
- PK-47989-002 (HARD TRAY)

REVISED EC NO: SH2011-0076 2010/09/03 DRW:ZNYAN CHKD: 2010/09/06 APPR:AYIN 2010/09/17 REV B	QUALITY SYMBOLS	GENERAL TOLERANCES (UNLESS SPECIFIED)	DIMENSION STYLE MM ONLY	SCALE 2:1	DESIGN UNITS METRIC	THIRD ANGLE PROJECTION
	▽=0	4 PLACES ± --- ± ---	DRAWN BY QWFANG	DATE 2008/04/25	TITLE RPGA989 SOCKET ASSEMBLY	
	▽=0	3 PLACES ± --- ± ---	CHECKED BY JKACHLIC	DATE 2008/05/29	MOLEX INCORPORATED DOCUMENT NO. SD-47989-001 SHEET NO. 2 OF 6	
	▽=0	2 PLACES ± 0.10 ± ---	APPROVED BY CLIANG	DATE 2008/05/29		
		1 PLACE ± 0.20 ± ---	MATERIAL NO. SEE TABLE			
		ANGULAR ± 2 °	SIZE A3		THIS DRAWING CONTAINS INFORMATION THAT IS PROPRIETARY TO MOLEX INCORPORATED AND SHOULD NOT BE USED WITHOUT WRITTEN PERMISSION	
		DRAFT WHERE APPLICABLE MUST REMAIN WITHIN DIMENSIONS				

9 8 7 6 5 4 3 2 1

10 9 8 7 6 5 4 3 2 1

PART NO. OF GF PLATING- TABLE 1

PART NUMBER	PICK UP TYPE		PACKAGE TYPE		PRODUCT SPEC.
	MYLAR	CAP	T&R	HARD TRAY	
47989-0110	◆			◆	PS-47989-002
47989-0120	◆		◆		
47989-0130		◆		◆	
47989-0140		◆	◆		
47989-0210	◆			◆	
47989-0220	◆		◆		
47989-0230		◆		◆	
47989-0240		◆	◆		

PART NO. OF 10u" MIN. GOLD PLATING- TABLE 2

PART NUMBER	PICK UP TYPE		PACKAGE TYPE		PRODUCT SPEC.
	MYLAR	CAP	T&R	HARD TRAY	
47989-0111	◆			◆	PS-47989-003
47989-0121	◆		◆		
47989-0131		◆		◆	
47989-0141		◆	◆		
47989-0211	◆			◆	
47989-0221	◆		◆		
47989-0231		◆		◆	
47989-0241		◆	◆		

PART NO. OF 15u" MIN. GOLD PLATING- TABLE 3

PART NUMBER	PICK UP TYPE		PACKAGE TYPE		PRODUCT SPEC.
	MYLAR	CAP	T&R	HARD TRAY	
47989-0112	◆			◆	PS-47989-001
47989-0122	◆		◆		
47989-0132		◆		◆	
47989-0142		◆	◆		
47989-0212	◆			◆	
47989-0222	◆		◆		
47989-0232		◆		◆	
47989-0242		◆	◆		

SOCKET KEYING OPTIONS

MYLAR PICK & PLACE OPTION

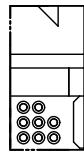
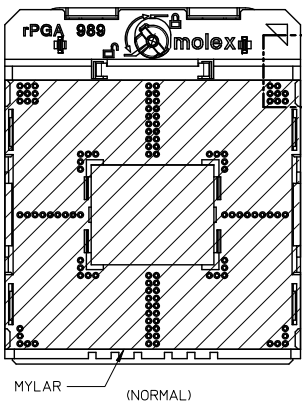

rPGA989  
47989-01\*\*

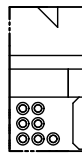

rPGA988A  
47989-02\*\*

REVISED EC NO: SH2011-0076 DRAWN BY: DRW:ZYMAN CHKD: 2010/09/06 APPR: ATIN 2010/09/17	QUALITY SYMBOLS √=0 √=0 √=0	GENERAL TOLERANCES (UNLESS SPECIFIED)		DIMENSION STYLE		SCALE	DESIGN UNITS	THIRD ANGLE PROJECTION
				MM ONLY		2:1	METRIC	
				DRAWN BY DATE		TITLE		
				CHECKED BY DATE		RPGA989 SOCKET ASSEMBLY		
		APPROVED BY DATE		MATERIAL NO.		MOLEX INCORPORATED		SHEET NO. 3 OF 6
		CL IANG 2008/05/29		DOCUMENT NO.		SD-47989-001		
		SEE TABLE		THIS DRAWING CONTAINS INFORMATION THAT IS PROPRIETARY TO MOLEX INCORPORATED AND SHOULD NOT BE USED WITHOUT WRITTEN PERMISSION				

9 8 7 6 5 4 3 2 1

10 9 8 7 6 5 4 3 2 1

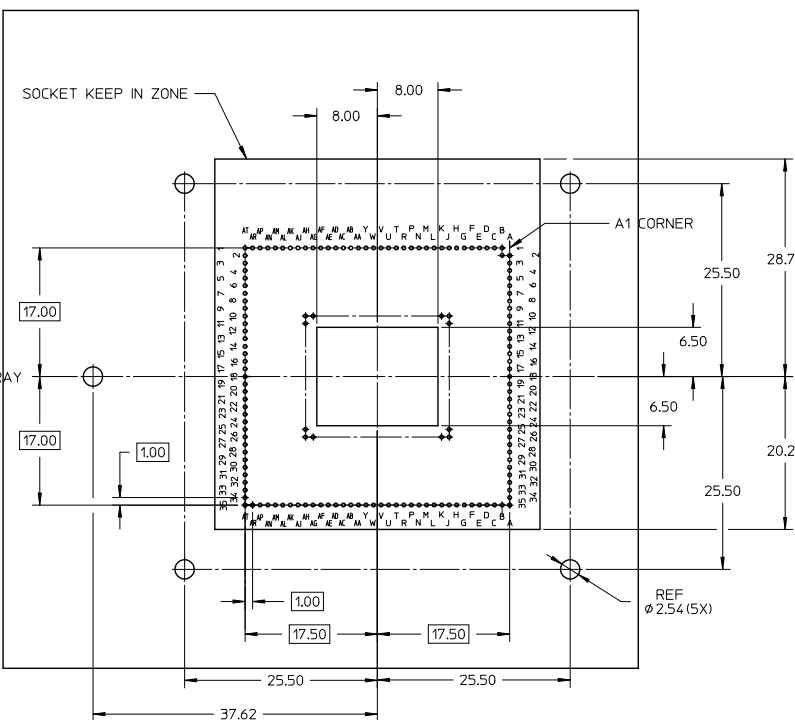

**NOTES:**

shape pada of PCB are recommended

TYPE1-Corner Pads



TYPE2-Peripheral Pads(Oblong-shape pada are recommended)

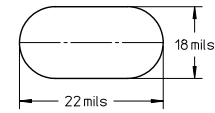

TYPE3-All Other Location Except for those of Type1 and Type2 Locations)

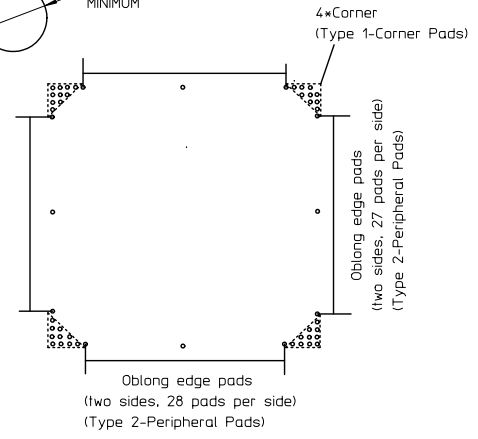
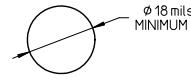

MOTHERBOARD KEEP IN ZONE (KIZ)  
(FOR NORMAL)

REVISED EC NO. SH2011-0076 DRAWN BY CHYK: ZHANG YAN CHKD: APPR: AYIN REV B	DESCRIPTION 2010/09/03 2010/09/06 2010/09/17	QUALITY SYMBOLS	GENERAL TOLERANCES (UNLESS SPECIFIED)	DIMENSION STYLE	SCALE	DESIGN UNITS	THIRD ANGLE PROJECTION
		√=0 √=0 √=0	4 PLACES ± --- ± --- 3 PLACES ± --- ± --- 2 PLACES ± 0.10 ± --- 1 PLACE ± 0.20 ± --- ANGULAR ± 2 °	MM ONLY	METRIC	TITLE	
		DRAWN BY QWFANG DATE 2008/04/25 CHECKED BY DATE APPROVED BY JKACHL IC DATE 2008/05/29 DATE MATERIAL NO. CL IANG DATE 2008/05/29	MOLEX INCORPORATED				
		DRAFT WHERE APPLICABLE MUST REMAIN WITHIN DIMENSIONS SEE TABLE THIS DRAWING CONTAINS INFORMATION THAT IS PROPRIETARY TO MOLEX INCORPORATED AND SHOULD NOT BE USED WITHOUT WRITTEN PERMISSION	DOCUMENT NO. SD-47989-001 SHEET NO. 4 OF 6				

9 8 7 6 5 4 3 2 1

10 9 8 7 6 5 4 3 2 1

PART NO. OF GF PLATING- TABLE 1

PART NUMBER	PICK UP TYPE		PACKAGE TYPE		PRODUCT SPEC.
	MYLAR	CAP	T&R	HARD TRAY	
47989-9110	◆			◆	PS-47989-002
47989-9120	◆		◆		
47989-9130		◆		◆	
47989-9140		◆	◆		
47989-9210	◆			◆	
47989-9220	◆		◆		
47989-9230		◆		◆	
47989-9240		◆	◆		

PART NO. OF 10u" MIN. GOLD PLATING- TABLE 2

PART NUMBER	PICK UP TYPE		PACKAGE TYPE		PRODUCT SPEC.
	MYLAR	CAP	T&R	HARD TRAY	
47989-9111	◆			◆	PS-47989-003
47989-9121	◆		◆		
47989-9131		◆		◆	
47989-9141		◆	◆		
47989-9211	◆			◆	
47989-9221	◆		◆		
47989-9231		◆		◆	
47989-9241		◆	◆		

PART NO. OF 15u" MIN. GOLD PLATING- TABLE 3

PART NUMBER	PICK UP TYPE		PACKAGE TYPE		PRODUCT SPEC.
	MYLAR	CAP	T&R	HARD TRAY	
47989-9112	◆			◆	PS-47989-001
47989-9122	◆		◆		
47989-9132		◆		◆	
47989-9142		◆	◆		
47989-9212	◆			◆	
47989-9222	◆		◆		
47989-9232		◆		◆	
47989-9242		◆	◆		

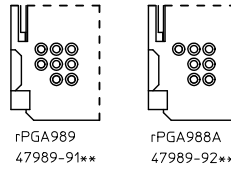
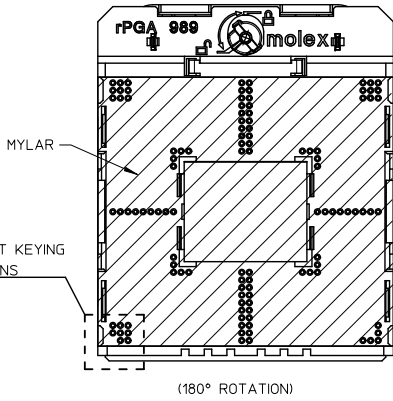
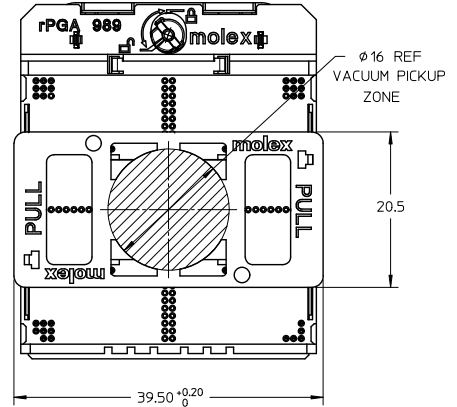

REVISED EC NO: SH2011-0076 DRAWN: ZHANYAN CHKD: APPR: AYIN	DESCRIPTION REV	QUALITY SYMBOLS	GENERAL TOLERANCES (UNLESS SPECIFIED)	DIMENSION STYLE	SCALE	DESIGN UNITS	THIRD ANGLE PROJECTION																
		$\sqrt{\text{R}}=0$ $\sqrt{\text{E}}=0$ $\sqrt{\text{D}}=0$	<table border="1"> <tr><th></th><th>mm</th><th>INCH</th></tr> <tr><td>4 PLACES</td><td>± ---</td><td>± ---</td></tr> <tr><td>3 PLACES</td><td>± ---</td><td>± ---</td></tr> <tr><td>2 PLACES</td><td>± 0.10</td><td>± ---</td></tr> <tr><td>1 PLACE</td><td>± 0.20</td><td>± ---</td></tr> <tr><td colspan="3">ANGULAR ± 2 °</td></tr> </table>		mm	INCH	4 PLACES	± ---	± ---	3 PLACES	± ---	± ---	2 PLACES	± 0.10	± ---	1 PLACE	± 0.20	± ---	ANGULAR ± 2 °			MM ONLY	2:1
	mm	INCH																					
4 PLACES	± ---	± ---																					
3 PLACES	± ---	± ---																					
2 PLACES	± 0.10	± ---																					
1 PLACE	± 0.20	± ---																					
ANGULAR ± 2 °																							
DRAFT WHERE APPLICABLE MUST REMAIN WITHIN DIMENSIONS				DRAWN BY: QWFANG CHECKED BY: JKACHLIC APPROVED BY: CL IANG	DATE: 2008/04/25 DATE: 2008/05/29 DATE: 2008/05/29	TITLE: RPGA989 SOCKET ASSEMBLY																	
				MATERIAL NO. SEE TABLE	DOCUMENT NO. SD-47989-001	MOLEX INCORPORATED																	
				SIZE: A3	THIS DRAWING CONTAINS INFORMATION THAT IS PROPRIETARY TO MOLEX INCORPORATED AND SHOULD NOT BE USED WITHOUT WRITTEN PERMISSION																		

9 8 7 6 5 4 3 2 1

10 9 8 7 6 5 4 3 2 1

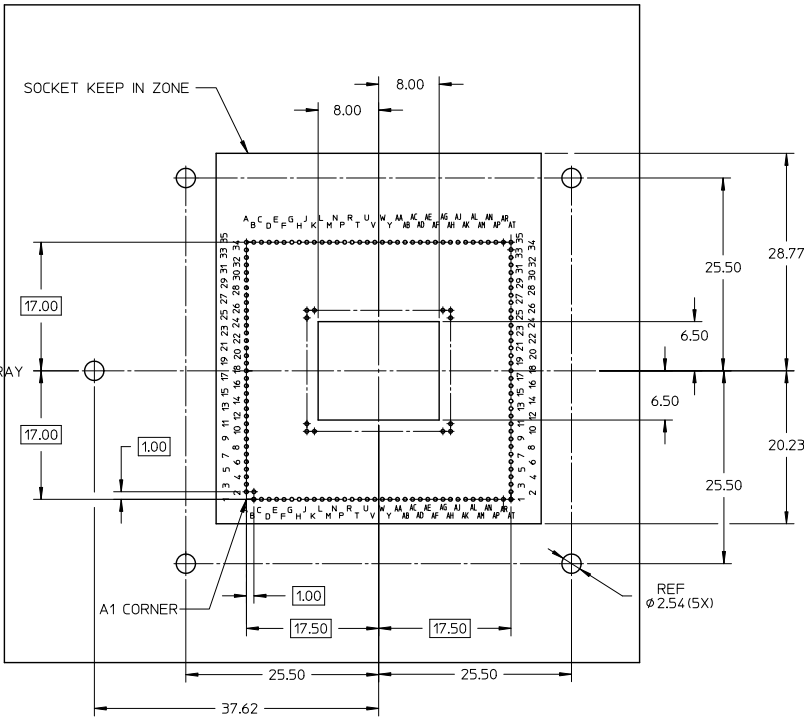

**NOTES:**

shape pada of PCB are recommended

TYPE1-Corner Pads  $\phi 20\text{mils}$

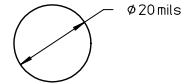

TYPE2-Peripheral Pads(Oblong-shape pada are recommended)

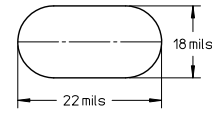

TYPE3-All Other Location Except for those of Type1 and Type2 Locations)

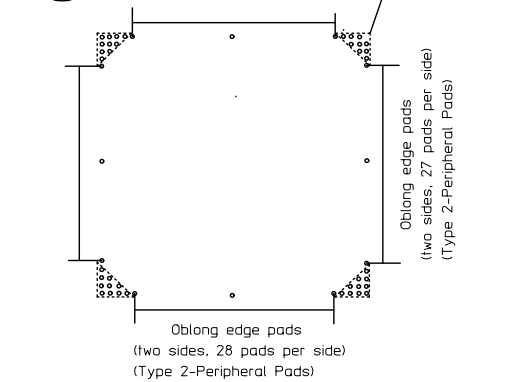
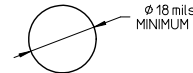

MOTHERBOARD KEEP IN ZONE (KIZ)  
(FOR 180° ROTATION)

REVISED EC NO: SH2011-0076 2010/09/03 DRW:ZYXIAN 2010/09/06 CHKD: APPR:ATIN 2010/09/17	QUALITY SYMBOLS $\nabla=0$ $\nabla=0$ $\nabla=0$	GENERAL TOLERANCES (UNLESS SPECIFIED)		DIMENSION STYLE		SCALE	DESIGN UNITS	THIRD ANGLE PROJECTION	
				MM ONLY		2:1	METRIC		
				mm	INCH	DRAWN BY	DATE		TITLE
				4 PLACES $\pm$ ---	$\pm$ ---	QWFANG	2008/04/25		RPGA989 SOCKET ASSEMBLY
B CHKD: APPR:ATIN	DESCRIPTION REV	DRAFT WHERE APPLICABLE MUST REMAIN WITHIN DIMENSIONS		MATERIAL NO.		DOCUMENT NO.		SHEET NO. 6 OF 6	
				SEE TABLE		SD-47989-001			
				THIS DRAWING CONTAINS INFORMATION THAT IS PROPRIETARY TO MOLEX INCORPORATED AND SHOULD NOT BE USED WITHOUT WRITTEN PERMISSION					

9 8 7 6 5 4 3 2 1