

Excellent Integrated System Limited

Stocking Distributor

Click to view price, real time Inventory, Delivery & Lifecycle Information:

[Molex Connector Corporation](#)

[03-09-1028](#)

For any questions, you can email us directly:

sales@integrated-circuit.com

PLUG		RECEPTACLE	
ORDER NO	ENG NO	ORDER NO	ENG NO
03-09-2028	1816-2P	03-09-1028	1816-2R
03-09-7028	1816-2PBK	03-09-6028	1816-2RBK
03-09-7029	1816-2PBK-B		

LEGEND:

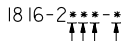

CIRCUIT SIZE
P = PLUG
R = RECEPTACLE

MATERIAL:

BLANK = NYLON 6/6, 94V-2, PER SMES-128-A**
B = NYLON 6/6, 94V-2, HEAT STABILIZED, PER SMES-128-0-1

COLOR:

BLANK = NATURAL
AM = AMBER
BN = BROWN
OR = ORANGE
COLOR
BK = BLACK
BU = BLUE
CY = GRAY
GN = GREEN
RD = RED
YW = YELLOW

NOTES:

- MOLEX PRODUCT SPEC 02-09 APPLIES.
- FOR USE WITH MOLEX .093/(2.36) SERIES TERMINALS.

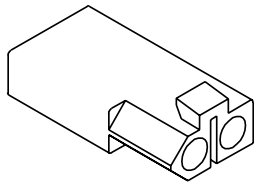
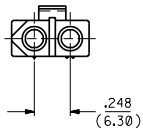
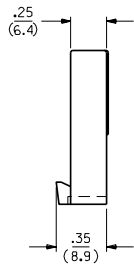
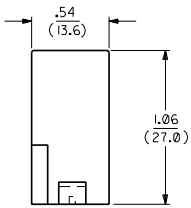
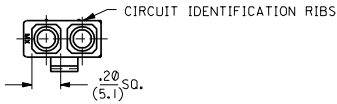

RECEPTACLE

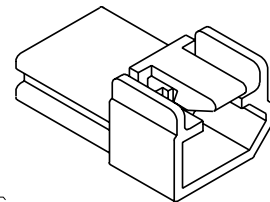
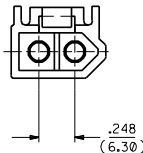
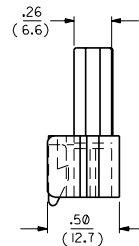
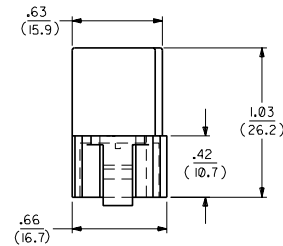
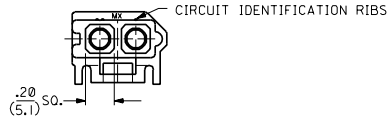

PLUG

C1	ADD RADII PER ECR U2 1817 CAC 12/23/92	RW
C	REVISE PER ECR U2 1805 CAC 1/29/92	RW
B1	REVISE PER ECR U2 0825 CAC 5/28/92	RW
B	REVISED & REDRAWN ECR = U8 1905 KBW 9-29-88	

DIMENSIONS SHOWN METRIC INCH		MFG. SH. REV. LTR. REVISIONS	
UNLESS OTHERWISE SPECIFIED TOLERANCES ARE AS FOLLOWS		TITLE	
3 PLACE ± .010	---	REVISE ONLY ON CAD SYSTEM	
2 PLACE ± .014	± 0.25	.093/(2.36) HOUSINGS	
1 PLACE ---	± 0.35	PLUG & RECEPTACLE	
DRAFT WHERE APPLICABLE MUST REMAIN WITHIN DIMENSIONS		2 CIRCUIT, .248/(6.30) Ø	
DRG. BY: KBW		DATE: 09/20/88	
CHKD. BY: RAS		SHEET NO. 1 OF 1	
APP'D. BY: RAS		SCALE: 2 : 1	
FILE NAME: M8162.S82		PART NO. SD-1816-2*	
THIS DRAWING CONTAINS INFORMATION THAT IS PROPRIETARY TO MOLEX INC. AND SHOULD NOT BE USED WITHOUT WRITTEN PERMISSION.		CP C	