

## Excellent Integrated System Limited

Stocking Distributor

Click to view price, real time Inventory, Delivery & Lifecycle Information:

[Molex Connector Corporation](#)  
[0019092031](#)

For any questions, you can email us directly:  
[sales@integrated-circuit.com](mailto:sales@integrated-circuit.com)

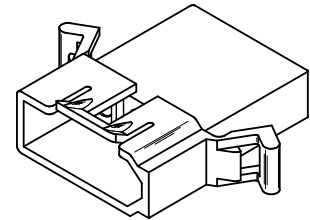
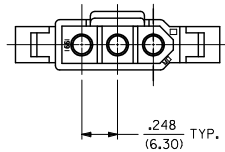
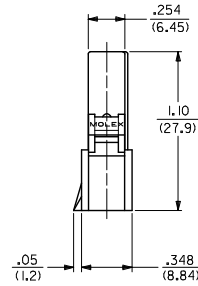
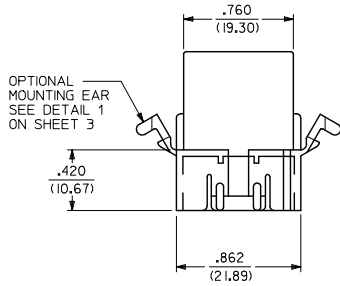
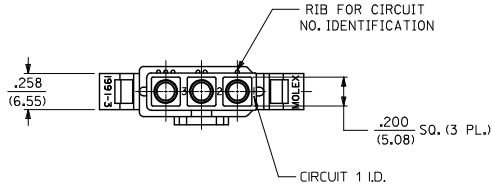

PLUG HOUSING

<p><b>REMOVE OBSOLETE</b> EC NO: UCP2014-3949 DRAWN BY: 2014/05/06 CHKD BY: 2014/05/06 APPROVED BY: 2014/06/10</p>	<p>QUALITY SYMBOLS ▽=0 ▽=0 ▽=0</p>	<p>GENERAL TOLERANCES (UNLESS SPECIFIED)</p>		<p>DIMENSION STYLE IN/MM</p>		<p>SCALE 2:1</p>	<p>DESIGN UNITS INCH</p>	<p>THIRD ANGLE PROJECTION</p>	
		<p>4 PLACES ± --- ± ---</p>	<p>3 PLACES ± --- ± .005</p>	<p>DRAWN BY GEP</p>	<p>DATE 1988/03/07</p>	<p>TITLE .093/(2.36) HOUSINGS, PLUG AND RECEPTACLE, 3 CKT, .248/(6.30) CTRS</p>			
		<p>2 PLACES ± 0.13 ± .010</p>	<p>1 PLACE ± 0.25 ± ---</p>	<p>CHECKED BY RW</p>	<p>DATE 1988/03/07</p>	<p><b>molex</b></p>			
		<p>0 PLACE ± --- ± ---</p>	<p>ANGULAR ± 1°</p>	<p>APPROVED BY FSMITH</p>	<p>DATE 2014/06/10</p>	<p>MATERIAL NO.</p>	<p>DOCUMENT NO. SD-1991-3*</p>	<p>SHEET NO. 1 OF 3</p>	
<p>DRAFT WHERE APPLICABLE MUST REMAIN WITHIN DIMENSIONS</p>		<p>SEE CHART</p>		<p>THIS DRAWING CONTAINS INFORMATION THAT IS PROPRIETARY TO MOLEX INCORPORATED AND SHOULD NOT BE USED WITHOUT WRITTEN PERMISSION</p>					

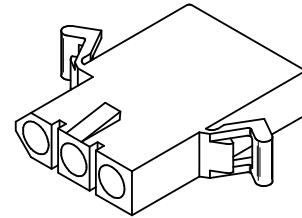
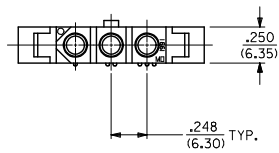
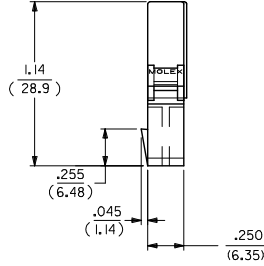
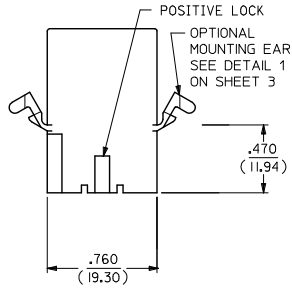
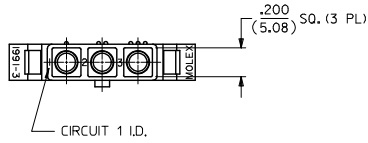

RECEPTACLE HOUSING

SEE SHEET 1 EC NO: UCP2014-3949 DRAWN BY: ZHANGKIPPER 2014/05/06 CHECKED BY: CHIKOBANDERSON 2014/05/06 APPROVED BY: APPRECI SMITH 2014/06/10	QUALITY SYMBOLS ∇=0 ∇=0 ∇=0	GENERAL TOLERANCES (UNLESS SPECIFIED)		DIMENSION STYLE IN/MM		SCALE 2:1	DESIGN UNITS INCH	THIRD ANGLE PROJECTION	
		4 PLACES ± --- ± ---	3 PLACES ± --- ± .005	DRAWN BY GEP	DATE 1988/03/07	TITLE .093/(2,36) HOUSINGS, PLUG AND RECEPTACLE, 3 CKT, .248/(6.30) CTRS			
		2 PLACES ± 0.13 ± .010	1 PLACE ± 0.25 ± ---	CHECKED BY RW	DATE 1988/03/07	APPROVED BY F SMITH			
		0 PLACE ± --- ± ---	ANGULAR ± 1 °	MATERIAL NO. SEE CHART	DATE 2014/06/10	DOCUMENT NO. SD-1991-3*	SHEET NO. 2 OF 3		
DRAFT WHERE APPLICABLE MUST REMAIN WITHIN DIMENSIONS		SIZE C		THIS DRAWING CONTAINS INFORMATION THAT IS PROPRIETARY TO MOLEX INCORPORATED AND SHOULD NOT BE USED WITHOUT WRITTEN PERMISSION					

-PLUG		
PART NO.	ENG. NO.	PKG. INFORMATION
I9-09-2031	I99I-3P	PK-1991-001
I9-09-7031	I99I-3PBK	PK-1991-001
I9-09-7032	I99I-3PIBK	PK-1991-001
I9-09-2032	I99I-3P1	PK-1991-002
I9-09-7034	I99I-3PIOR	PK-1991-001

RECEPTACLE		
PART NO.	ENG. NO.	PKG. INFORMATION
I9-09-1032	I99I-3R1	PK-1991-001
I9-09-6031	I99I-3RBK	PK-1991-001
I9-09-6032	I99I-3RIBK	PK-1991-001

LEGEND:

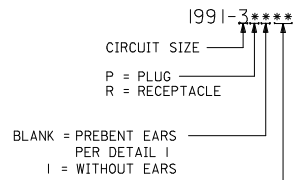

COLOR: BLANK=NATURAL COLOR  
 AM=AMBER BK=BLACK BU=BLUE  
 BN=BROWN GY=GRAY GN=GREEN  
 OR=ORANGE RD=RED YW=YELLOW

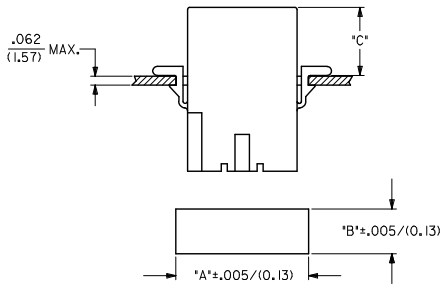

HOUSING	DIM. "A"	DIM. "B"	DIM. "C" STD. EAR	DIM. "C" PREBENT
PLUG	.1022/(25.96)	.365/(9.27)	.48/(12.2)	.52/(13.2)
RECEPTACLE	.920/(23.37)	.311/(7.90)	.47/(11.9)	.51/(12.9)

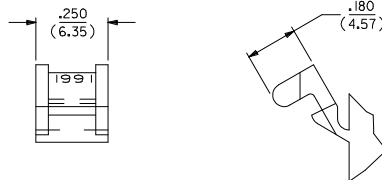

DETAIL I

PREBENT MOUNTING EAR  
(SCALE 4:1)

NOTES:

1. MATERIAL: NYLON TYPE 6/6, 94V-2.
2. FINISH: NOT APPLICABLE
3. PRODUCT SPECIFICATION: PS-02-09
4. PACKAGING SPECIFICATION: SEE CHART
5. ACCEPTS MOLEX .093/(2.36) SERIES TERMINALS.
6. PARTS CONFORM TO CLASS B REQUIREMENTS OF COSMETIC SPECIFICATION PS-45499-002.

SEE SHEET 1 IEC NO: UCP2014-3949 DRAWN BY: DRINKUPPER 2014/05/06 CHECKED BY: CHIKO BANIKSON 2014/05/06 APPROVED BY: APRIL SMITH 2014/06/10	QUALITY SYMBOLS 	GENERAL TOLERANCES (UNLESS SPECIFIED)		DIMENSION STYLE IN/MM		SCALE 2:1	DESIGN UNITS INCH	THIRD ANGLE PROJECTION																		
		<table border="1"> <tr> <th></th> <th>mm</th> <th>INCH</th> </tr> <tr> <td>4 PLACES</td> <td>± .005</td> <td>± .0005</td> </tr> <tr> <td>3 PLACES</td> <td>± .005</td> <td>± .0005</td> </tr> <tr> <td>2 PLACES</td> <td>± 0.13</td> <td>± .010</td> </tr> <tr> <td>1 PLACE</td> <td>± 0.25</td> <td>± .010</td> </tr> <tr> <td>0 PLACE</td> <td>± .005</td> <td>± .0005</td> </tr> </table>			mm	INCH	4 PLACES	± .005	± .0005	3 PLACES	± .005	± .0005	2 PLACES	± 0.13	± .010	1 PLACE	± 0.25	± .010	0 PLACE	± .005	± .0005	DRAWN BY: GEP DATE: 1988/03/07 CHECKED BY: RW DATE: 1988/03/07 APPROVED BY: F SMITH DATE: 2014/06/10		TITLE: .093/(2.36) HOUSINGS, PLUG AND RECEPTACLE, 3 CKT, .248/(6.30) CTRS 		
			mm	INCH																						
		4 PLACES	± .005	± .0005																						
3 PLACES	± .005	± .0005																								
2 PLACES	± 0.13	± .010																								
1 PLACE	± 0.25	± .010																								
0 PLACE	± .005	± .0005																								
ANGULAR ± 1 ° DRAFT WHERE APPLICABLE MUST REMAIN WITHIN DIMENSIONS		MATERIAL NO. SEE CHART DOCUMENT NO. SD-1991-3*		SHEET NO. 3 OF 3																						
THIS DRAWING CONTAINS INFORMATION THAT IS PROPRIETARY TO MOLEX INCORPORATED AND SHOULD NOT BE USED WITHOUT WRITTEN PERMISSION																										