

## **Excellent Integrated System Limited**

Stocking Distributor

Click to view price, real time Inventory, Delivery & Lifecycle Information:

[Omron Automation & Safety](#)  
[CJ1W-OA201](#)

For any questions, you can email us directly:

[sales@integrated-circuit.com](mailto:sales@integrated-circuit.com)

Note: All dimensions are shown in mm. Divide by 25.4 to convert millimeters into inches.

■ CJ1 Product Dimensions

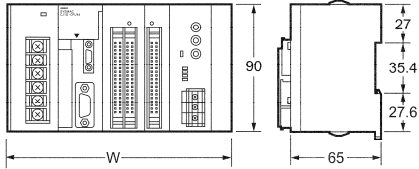

Unit/product	Model number	Width
Power Supply Unit	CJ1W-PA205R	80
Power Supply Unit	CJ1W-PA202	45
	CJ1W-PD025	60
CPU Unit	CJ1M-CPU11/12/13	31
	CJ1M-CPU21/22/23	49
	CJ1H-CPU□□□□ CJ1G-CPU□□□□	62
End Cover	CJ1W-TER01	14.7

■ Example Rack Widths using CJ1W-PA202 Power Supply Unit (AC, 14 W)

No. of Units mounted with 31-mm width	Rack width (mm)		
	With CJ1M-CPU12/13	With CJ1M-CPU22/23	With CJ1G or CJ1H CPU Unit
1	121.7	139.7	152.7
2	152.7	170.7	183.7
3	183.7	201.7	214.7
4	214.7	232.7	245.7
5	245.7	263.7	276.7
6	276.7	294.7	307.7
7	307.7	325.7	338.7
8	338.7	356.7	369.7
9	369.7	387.7	400.7
10	400.7	418.7	431.7

Power Supply Units

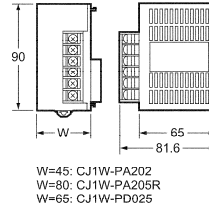

CPU Units  
 CJ1H-CPU□□□□  
 CJ1G-CPU□□□□

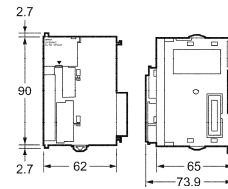

End Plate  
 (included with CPU Unit)

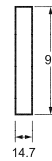

CJ1M-CPU11/12/13

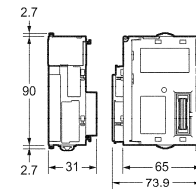

RS-422A Adapter  
 CJ1W-CIF11



CJ1M-CPU21/22/23

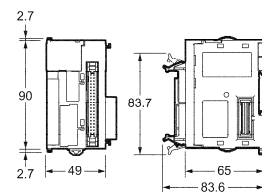

## Reference Information

OMRON

### Dimensions

Note: All dimensions are shown in mm. Divide by 25.4 to convert millimeters into inches.

#### ■ Units of Width 20 mm

Unit	Model number	Width
I/O Control Module	CJ1W-IC101	20
32Basic-point I/O Modules	CJ1W-ID231/232	
	CJ1W-OD231/232	
B7A Interface Unit	CJ1W-B7A22	
	CJ1W-B7A14	
	CJ1W-B7A04	
CompoBus/S Master Module	CJ1W-SRM21	

#### I/O Control Unit

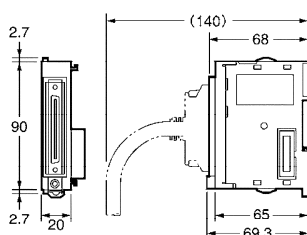

#### 32-point I/O Units (CJ1W-ID23□/OD23□)

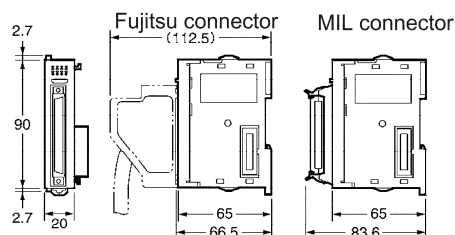

#### Units of Width 31 mm

Unit	Model number	Width
I/O Interface Module	CJ1W-II101	31
8/16-point Basic I/O Modules	CJ1W-ID201	
	CJ1W-ID211	
	CJ1W-IA111/201	
	CJ1W-OD201/202/203/204	
	CJ1W-OD211/212	
	CJ1W-OC201/211	
CJ1W-OA201		
32-point Basic I/O Modules	CJ1W-MD231	
	CJ1W-MD232	
	CJ1W-MD233	
64-point Basic I/O Modules	CJ1W-ID261	
	CJ1W-ID262	
	CJ1W-OD261	
	CJ1W-OD262	
	CD1W-MD262	
	CJ1W-OD263	
	CD1W-MD261	
	CD1W-MD263	
CD1W-MD563		
Interrupt Input Module	CJ1W-INT01	
High Speed Input Module	CJ1W-IDP01	
Analog I/O Module	CJ1W-AD□□□	
	CJ1W-DA□□□	
	CJ1W-MAD42	
Temperature Control Units	CJ1W-TC□□□	
Position Control Units	CJ1W-NC113/133	
	CJ1W-NC213/233	
	CJ1W-NC413/433	
High-speed Counter Unit	CJ1W-CT021	
ID Sensor Unit	CJ1W-V600C11	
	CJ1W-V600C12	
Controller Link Module	CJ1W-CLK21-V1	
Serial Communications Unit	CJ1W-SCU41	
Ethernet Module	CJ1W-ETN21	
DeviceNet Module	CJ1W-DRM21	
Profibus-DP Slave	CJ1W-PRT21	
Profibus-DP Master	CJ1W-PRM21	

**OMRON**

**Reference Information**

**Dimensions**

**I/O Interface Unit**

**8/16-point Basic I/O Units, Interrupt Input Unit, and High-speed Input Unit**

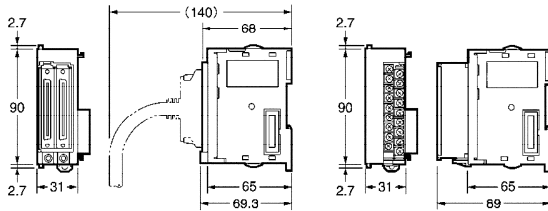

**64-point Basic I/O Units and 32-point Basic I/O Units (CJ1W-MD23□)**

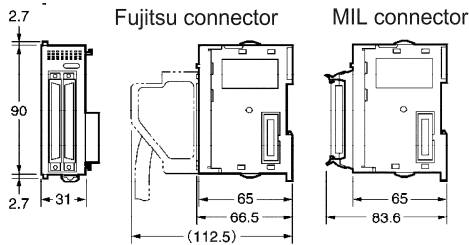

**Special I/O Units and CPU Bus Units**

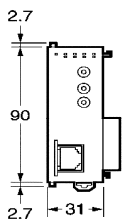

**■ Mounting Dimensions**

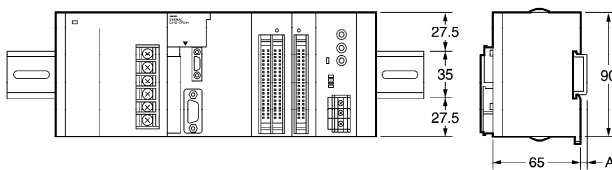

DIN Track model number	A
PFP-100N2	16 mm
PFP-100N	7.3 mm
PFP-50N	7.3 mm

**■ Mounting Height**

The mounting height of CJ1 Series CPU Racks and Expansion Racks is from 81.6 to 89.0 mm, depending on the Modules that are mounted. Additional height is required to connect Programming Devices (e.g., CX-Programmer or Programming Console) and Cables. Be sure to allow sufficient mounting height.

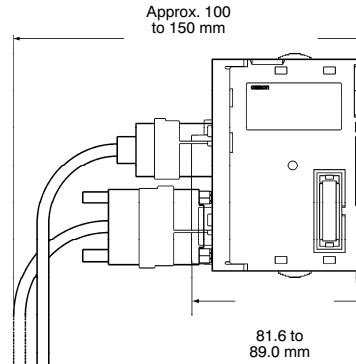

Note: Consider the following points when expanding the configuration:

- The total length of I/O Connecting Cable must not exceed 12 m.
- I/O Connecting Cables require the bending radius as indicated in the CS/CJ-series Connecting Cable.

**CS/CJ-series Connecting Cable**

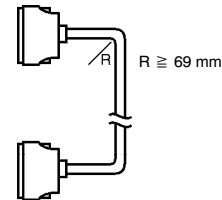

Note: Outer diameter of cable: 8.6 mm.

## Reference Information

**OMRON**

### CJ1 system Configuration Worksheets

#### ■ Worksheet 1

CPU Rack					
Required Parts				Qty.	Part Number(s) Selected
CPU - Note: CJ1M-CPU1□ requires 0.58 A, CJ1M-CPU2□ requires 0.64 A, CJ1G requires 0.91 A, SJ1H requires 0.99 A				1	
Module	Current Consumption	Description			
1			1		
2			1		
3			1		
4			1		
5			1		
6			1		
7			1		
8			1		
9			1		
10			1		
<b>CJ1W-IC101</b>	0.02 A at 5V	If CJ1 Modules exceed ten per system, an additional rack is required. The CJ1W will attach to a CJ1W-II101 in the expansion rack.			
TOTALS:					
Power Supply:				1	
Optional Parts					
Memory Card (FLASH)					
Programming Cable (Peripheral cable)					
CX-Programmer Programming Software					
Remote I/O Touch Screens/Cables/Terminal Blocks/Other Software/Etc.					

Note: Make copies of this worksheet for system configuration and planning.

**OMRON**

# Reference Information

## CJ1 system Configuration Worksheets

### ■ Worksheet 2

Expansion Rack # _____					
Required Parts				Qty.	Part Number(s) Selected
I/O Expansion Cables (CS1W-CN□□3)				1	CS1W-CN _____
I/O Expansion Module CJ1W-II101 (Current consumption 0.13 A at 5V)				1	CJ1W-II101
Module	Current Consumption	Description			
1			1		
2			1		
3			1		
4			1		
5			1		
6			1		
7			1		
8			1		
9			1		
10			1		
<b>CJ1W-IC101</b>	0.02 A at 5V	If CJ1 Modules exceed ten per system, an additional rack is required. The CJ1W will attach to a CJ1W-II101 in the expansion rack.			
TOTALS:					
Power Supply:					
Other					

Note: Make copies of this worksheet for system configuration and planning.