

Excellent Integrated System Limited

Stocking Distributor

Click to view price, real time Inventory, Delivery & Lifecycle Information:

[BUD Industries, Inc.](#)
[JB-3951](#)

For any questions, you can email us directly:

sales@integrated-circuit.com

PART NAME	JUNCTION BOX	PART No.	JB-3951	REVISION DATE	7-18-11
-----------	--------------	----------	---------	---------------	---------

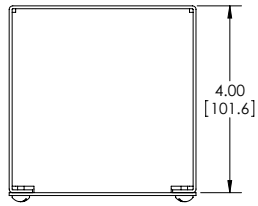

MATERIAL - 16 GA. [1.5mm] STEEL
FINISH - SMOOTH GRAY POWDERCOAT

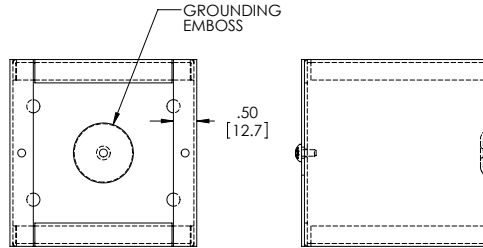
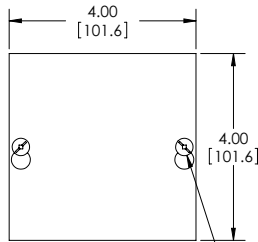
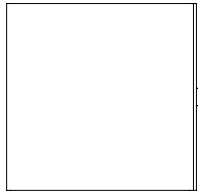
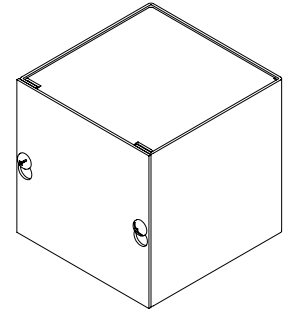

COVER REMOVED

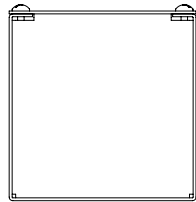
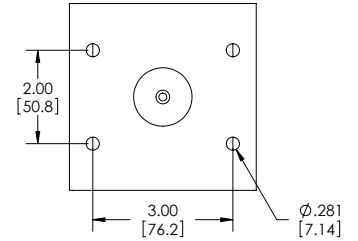

SCREWS: #10-32 x .31"[8mm] LG.
MACHINE, PAN HEAD, SLOTTED/SQUARE
COMBINATION STYLE DRIVE, STEEL, ZINC PLATED.
(SUPPLIED FOR COVER MOUNTING AND
FOR GROUND POINT).