

## Excellent Integrated System Limited

Stocking Distributor

Click to view price, real time Inventory, Delivery & Lifecycle Information:

[Molex Connector Corporation](#)  
[0734041390](#)

For any questions, you can email us directly:

[sales@integrated-circuit.com](mailto:sales@integrated-circuit.com)

12 11 10 9 8 7 6 5 4 3 2 73404

**MATERIALS AND FINISHES**

BODY, OC, SLEEVE: BRASS  
PLATED: GOLD

CENTER CONTACT: BeCu  
PLATED: GOLD

INSULATOR: TEFLON

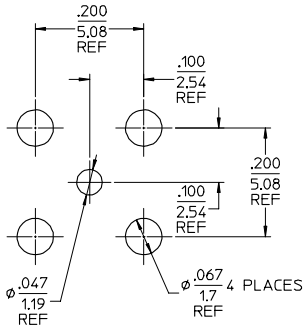

RECOMMENDED BOARD LAYOUT

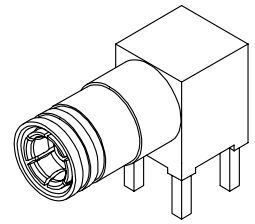
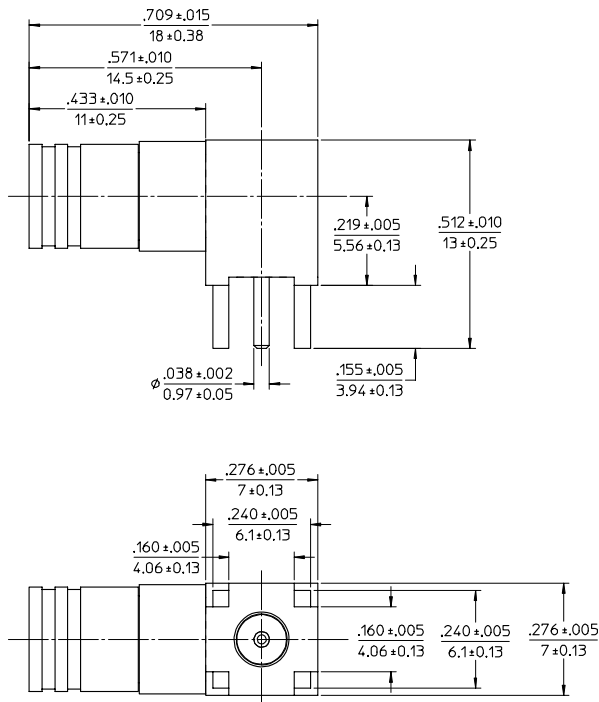

- UNLESS OTHERWISE SPECIFIED DIMS ARE INCHES AND ANGLES ARE DEGREES.
- SURFACE FINISH OF 63 ALL OVER.
  - NO CHATTER OR NON-UNIFORM
  - SURFACE FINISH ALLOWED.
  - PARTS TO BE FREE OF BURRS & SHARP EDGES .005 MAX BREAK.
  - EXTERNAL THREADS TO BE ROLLED OR SINGLE POINT.
  - DIAMETERS TO BE CONCENTRIC WITHIN .003 TIR.

PART # 73404-1390

MIL-STD-348A, FIG. 311-2	INTERFACE
SPECIFICATION	DESCRIPTION

CHG: NEW RELEASE	EC NO. URF-1802	DRWN: SSS 07/16/03	CHK: TEF 07/16/03	APPR: GMH 07/16/03	CHG: XXX	EC NO. URF-XXXX	DRWN: XXX 00/00/00	CHK: XXX 00/00/00	APPR: XXX 00/00/00	DATE: 03/07/16	DESCRIPTION	QUALITY SYMBOLS	GENERAL TOLERANCES (UNLESS SPECIFIED)	SCALE	DESIGN UNITS	THIRD ANGLE PROJECTION	REVISE ON CAD ONLY		
												4 PLACES	± .005	± .005	6:1	INCH	NO	NO	
													3 PLACES	± .010	± .010	IN/MM	YES	YES	
													2 PLACES	± .020	± .020	TEF	SMB PLUG RA PCB 50 OHM		
													1 PLACE	± .050	± .050	TEF	SMB-P/PCB		
													ANGULAR ±1/2°		CHECKED BY	DATE	MOLEX INCORPORATED		
													DRAFT WHERE APPLICABLE MUST REMAIN WITHIN DIMENSIONS		APPROVED BY	DATE	MATERIAL NO.	DOCUMENT NO.	SHEET NO.
															GMH	2003/06/18		SD-73404-139	1 OF 1
													THIS DRAWING CONTAINS INFORMATION THAT IS PROPRIETARY TO MOLEX INCORPORATED AND SHOULD NOT BE USED WITHOUT WRITTEN PERMISSION						

11 10 9 8 7 6 5 4 3 2 1