

Excellent Integrated System Limited

Stocking Distributor

Click to view price, real time Inventory, Delivery & Lifecycle Information:

[Bel Fuse Inc.](#)
[PL20-2](#)

For any questions, you can email us directly:

sales@integrated-circuit.com

RED INDICATES ORIGINAL

DASH NO	FIG	CABLES ACCOMMODATED	A DIM	B FLATS	C HEX	ASSEMBLE PER
-1		RG-58				
-U1		ESSEX 621-715				
-2		RG-59				
-U2		BELDEN 8279				
-U2A		AT&T 730A				
-U2B		RG-223				
-3		RG-55	.931	.437	.437	TAI-101
-U3		RG-122				
-U3A		BELDEN 8218				
-4		RG-174				
-U4		RG-187				
-U5		RG-196				
-U5A		HEWLETT-PACKARD 8120-1107				
-U5B		BELDEN 9231	.988	.500	.500	TAI-119
-6		RG-5				
-U6		RG-2				
-U6A		RG-6				
-7		RG-303				
-U7		RG-180				
-U22		GRUMMAN GC875GPI				
-31		RG-187 DBL SHLD				
-U31		BELDEN 8228	.931	.437	.437	TAI-101
-U34		275-3991 MICRODOT				
-36		616-569 AMPLEX				
-U36		810 RAYCHEM				
-37		RG-304				
-U41		9248 BELDEN				
-44		BRAND-REX B749				
-U44		GORE C06C032	.988	.500	.500	TAI-119
-51		88281 BELDEN				
-U52		89120 BELDEN				
-53		89555 BELDEN				
-U53		734A, AT&T	.931	.437	.437	TAI-101
-63		RG-405				
-U63		RG-402				TAI-130
-U66						
-U66B						
-U41						

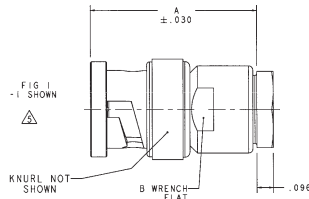

REV	ECO NO	DESCRIPTION	DATE	APPROVED
AE	11583	REVISED FOR SECTION VIEW		LSR

INCH	MM
.005	0.13
.050	1.27
.096	2.44
.125	3.18
.250	6.35
.312	7.92
.350	8.89
.437	11.10
.500	12.70
.606	15.39
.931	23.65
.988	25.10
1.846	46.89

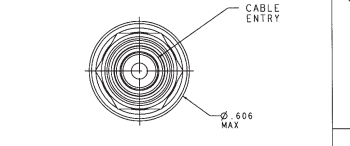
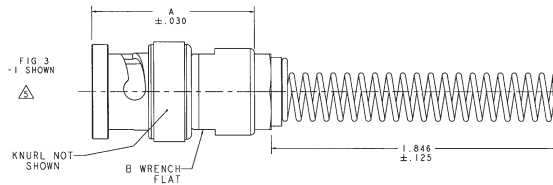
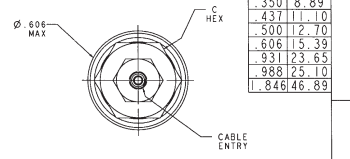
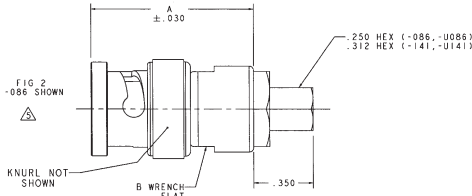

IF BEND RELIEF SPRING REQUIRED ADD SUFFIX "BR" TO MODEL NO. (SEE FIG 3) (NOT AVAILABLE WITH CABLE GROUPS -6, -U6, -6E, -U6E, -51, -U51, -52, -U52, -63, -U63, -88, -U88, -141 & -U141)

FOR CABLE GROUPS -1 & -U1 SUPPLY 1 EA ACA1
 FOR CABLE GROUPS -2 & -U2 SUPPLY 1 EA ACA2
 FOR CABLE GROUPS -5 & -U5 SUPPLY 1 EA ACAS
 MAY BE ASSEMBLED TO CABLE/CONNECTOR ASSY USING 3M SCOTCHGRIP NO. 1099 PLASTIC ADHESIVE, OR EQUIV.

IF PLASTIC STRAIN RELIEF REQUIRED, ADD SUFFIX "BT" TO MODEL NO. (ONLY AVAILABLE WITH: -1, -U1, -2, -U2, -5, -U5)

4. BNC COAXIAL CABLE PLUG BOTH 50 & 75 OHM VERSIONS
3. DASH NO DENOTES CABLE GROUP EXCEPT "U" PREFIX DENOTES 75 OHM VERSION
2. FINISH: TFS-1A(NICKEL) TOTAL BUILD-UP .000180-.000450
1. ALL DIM ARE IN INCHES

REV	ECO NO	DESCRIPTION	DATE	APPROVED
12-09	105-1004	110-0003	110-0002	
105-0717	105-0810	1-0203	1-0227	
305-0241	105-0698	1-0212	105-1844	
105-0158	105-0697	1-0215	105-0007	
305-0383	105-0659	1-0216	105-0449	
305-0187	105-0461	1-0218	105-0394	
105-1018	105-0295	1-0220	1-0304	

SCALE: 4/1
 DATE: 10-22-73
 SHEET: 1C