

## Excellent Integrated System Limited

Stocking Distributor

Click to view price, real time Inventory, Delivery & Lifecycle Information:

[Bel Fuse Inc.](#)  
[UBJ228](#)

For any questions, you can email us directly:  
[sales@integrated-circuit.com](mailto:sales@integrated-circuit.com)

DASH NO	MODEL NO	Ω
-1	BJ228	50
-2	UBJ228	75

DATA CONTAINED IN THIS DOCUMENT IS PROPRIETARY TO TROMPETER ELECTRONICS INC. AND SHALL NOT BE DISCLOSED, COPIED OR USED FOR PROCUREMENT OR MANUFACTURE WITHOUT EXPRESS WRITTEN PERMISSION.

REVISIONS			
REV	DESCRIPTIONS	DATE	APPROVED
C	REVISED PER ECO 14093	6-6-01	J.M.

**RED INDICATES ORIGINAL**

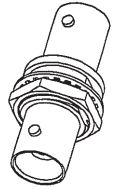
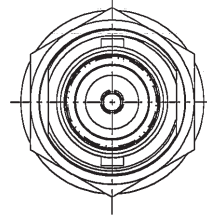
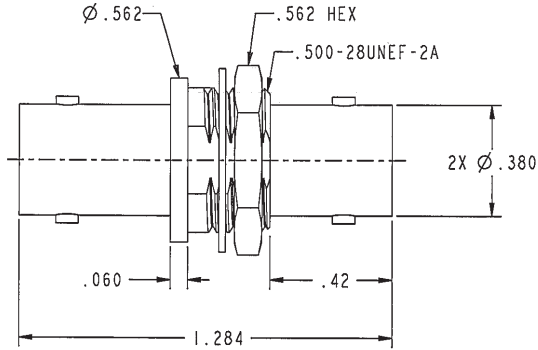

SCALE 1/1

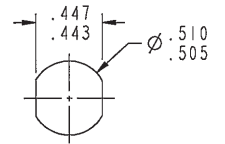

RECOMMENDED PANEL CUTOUT  
SCALE 1/1

3. SOCKET CONTACT COAXIAL BNC TYPE INSULATED FEED THRU BULKHEAD JACK, 50 AND 75 OHM VERSIONS
2. MAX PANEL THICKNESS: .156
1. FINISH: TFS-1Y (NICKEL)

NOTES: UNLESS OTHERWISE SPECIFIED.

INTERPRET DRAWING PER MIL-STD-100. DIMENSIONS ARE IN INCHES AND INCLUDE FINISH THICKNESS UNLESS OTHERWISE SPECIFIED.		TOL: UNLESS SPECIFIED. .XX ± .02 .XXX ± .010 ANGLE ± 1°			
DRN: JCM 6-5-01		MATERIAL:		TITLE: BJ228/UBJ228	
CHG: J.M. 6/5/01		FINISH:		SIZE: A 14949	
APPROVED: J.M. 6/5/01		DO NOT SCALE DWG		DRAWING NO. 105-2057	
PROTE FILE NO. 105-2057		SCALE: 2/1		DATE: 6/13/00	
NEXT ASSY		SHEET: 1C		REV: C	