

Excellent Integrated System Limited

Stocking Distributor

Click to view price, real time Inventory, Delivery & Lifecycle Information:

[Laird Technologies EMI](#)
[0077005602](#)

For any questions, you can email us directly:

sales@integrated-circuit.com

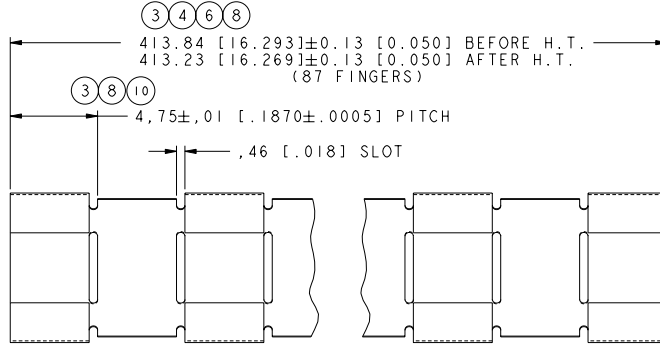
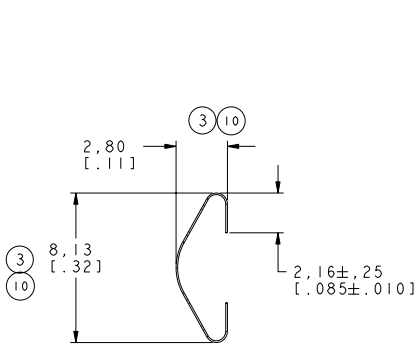
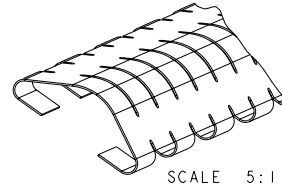
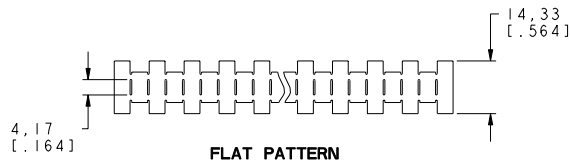

DWG. NO.		0077-0056-02
REVISIONS		
ECO-E1787 ADDED TOLERANCE 2 PL DECIMAL WAS 3PL RKM 07/21/00 EWS 7-25-00	03	
ECO-E1982 ADDED BEFORE AND AFTER H.T. DIMENSIONS. RKM 11/13/00 EWS 11/14/00	04	
ECO-E2637 ±.015 WAS ±.005 RKM 12/04/01 EWS 12/04/01	05	
ECO-E2711 16.275 WAS 16.293 16.250 WAS 16.269. RKM 01/28/02 EWS 01/28/02	06	
ECO-E4029 REMOVED MATERIAL WIDTH SDH 09/11/03 EWS 09/26/03	07	
ECO-E5062 ADDED H.T. SPECS. FROM REV 07 RKM 06/29/05 EWS 06/29/05	08	
ECO-E5541 ADDED ±.010 TOL TO .085 DIM SDH 08/23/06 EWS 08/24/06	09	
ECO-E5864 .32 WAS .320. .11 WAS .110. 0005 PITCH TOL. WAS .005. RKM 03/23/07. EWS 03/26/07	10	

MATERIAL: 0.09 [0.0035]±.0005 [0.0002] THICK BeCu ALLOY 25 1/4 HARD	TOLERANCES NOT SHOWN DECIMAL 2 PL'S ± 0.50 [0.020] DECIMAL 3 PL'S ± 0.38 [0.015]
HEAT TREAT: TO DPH 373 MIN USING A 500 GRAM LOAD	ANGULAR ± ---
THICKNESS AFTER: CLEANING AND BEFORE PLATING 0.08 [0.00315] MIN.	THIRD ANGLE PROJECTION
FINISH: BRIGHT FINISH	UNITS: MM SCALE: 5:1 [INCH]
CAD MAINTAINED DRAWING. MANUAL CHANGES UNAUTHORIZED.	

 DELAWARE WATER GAP PENNSYLVANIA LAIRD STANDARD	DRAWN BY: AD DATE: 05/18/99
	CHECKED: ES DATE: 12/04/01
	APPROVED: EWS DATE: 05/26/99
REF. DWG. NO. 0077-0010-01	DWG. NO. 0077-0056-02
SHEET 1 OF 1	

THIS INFORMATION IS CONFIDENTIAL AND PROPRIETARY TO LAIRD TECHNOLOGIES. IT MAY NOT BE DISCLOSED TO ANYONE, OTHER THAN LAIRD TECHNOLOGIES PERSONNEL, WITHOUT WRITTEN AUTHORIZATION FROM LAIRD TECHNOLOGIES.

DWG. NO. 0077-0056-02

REV 10