



**Distributor of FCI: Excellent Integrated System Limited**

Datasheet of 10118241-001RLF - Connector Receptacle HDMI 19 Position Surface Mount, Right Angle, Horizontal

Contact us: [sales@integrated-circuit.com](mailto:sales@integrated-circuit.com) Website: [www.integrated-circuit.com](http://www.integrated-circuit.com)

---

## **Excellent Integrated System Limited**

Stocking Distributor

Click to view price, real time Inventory, Delivery & Lifecycle Information:

[FCI](#)

[10118241-001RLF](#)

For any questions, you can email us directly:

[sales@integrated-circuit.com](mailto:sales@integrated-circuit.com)

PART NUMBER  
10118241-001RLF

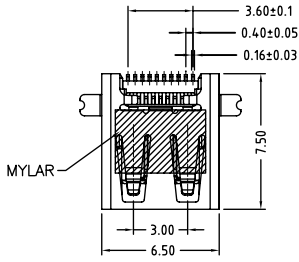

PART NO. DESCRIPTION:  
10118241-00XXLF  
RoHS COMPATIBLE  
PACKING TYPE  
R:TAPE & REEL  
CONTACT AREA PLATING  
1:Au 15u"

- NOTES:  
1. MATERIAL:  
HOUSING: LCP+30%GF ,UL94 V-0, BLACK  
TERMINAL: COPPER ALLOY.  
SHELL: STAINLESS STEEL  
2. FINISH:  
CONTACT AREA: GOLD PLATED  
CONTACT SOLDER AREA: GOLD FLASH PLATED  
SHELL: TIN PLATED  
UNDER NICKEL PLATED OVER ALL.  
3. PRODUCT SPECIFICATION: GS-12-0983.  
4. PACKAGING SPECIFICATION: GS-14-2164.  
5. THE PRODUCT MEETS EUROPEAN UNION DIRECTIVES AND OTHER COUNTRY REGULATIONS AS DESCRIBED IN GS-22-008.  
6. THE CONNECTOR CAN WITHSTAND EXPOSURE TO 260 DEGREE C PEAK TEMPERATURE FOR 10 SECONDS IN IR REFLOW OVEN.

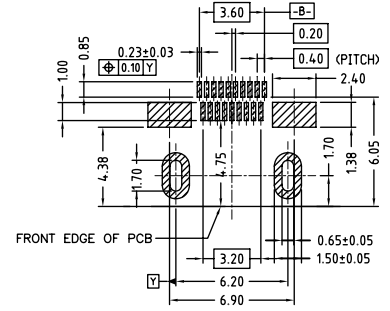
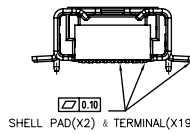
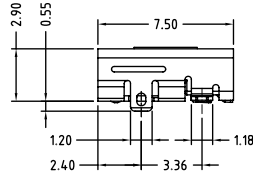
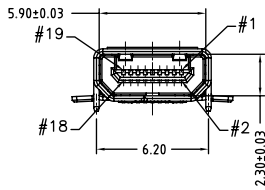

RECOMMENDED PCB LAYOUT (.XX±0.05)  
CONNECTOR SIDE (TOP VIEW)

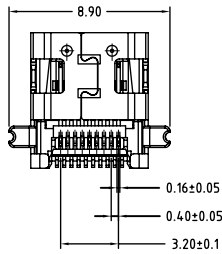

mat'l. code	surface	tolerance	projection	product family	HDMI
	ASME Y14.5	ASME Y14.5			
ltr	ecn no	dr	date	title	
A	LS		09/13/11	HDMI TYPE D RECEPTACLE	
B	BLX-N-16493	Henry	06/24/14	dwg no	sheet 1 of 1 size
				10118241	Δ4
				type	CUSTOMER Drawing
sheet index	revision sheet	B	1		