

Excellent Integrated System Limited

Stocking Distributor

Click to view price, real time Inventory, Delivery & Lifecycle Information:

[Molex Connector Corporation](#)
[0758614104](#)

For any questions, you can email us directly:

sales@integrated-circuit.com

20 19 18 17 16 15 14 13 12 11 10 9 8 7 6 5 4 3 2 1

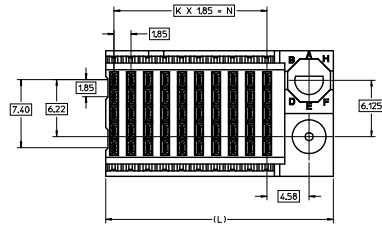
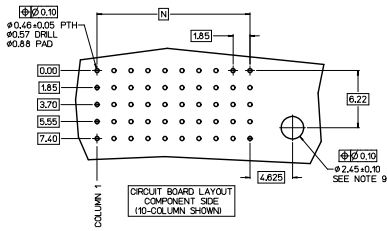

75861-4***		PIN LENGTH	GOLD (Au) THICKNESS
COLUMN	DRY IN	mm	micrometers
01 = 10	0-3.55 mm	0.25 (MAPS)	
02 = 25	4-5.55 mm		
05 = 5	3-3.55 mm		
	4-4.55 mm	0.76	
	5-5.55 mm		
	7-3.55 mm		
	8-4.55 mm	1.27	
	9-5.55 mm		

CONFIGURATION			
ASSEMBLY NO.	K	N	LU
75861-25**	4	7.40	16.83
75861-4**	9	16.85	24.78
75861-42**	24	44.40	52.53

KEYING POSITION
0 - NONE
1 - A
2 - B
ETC.

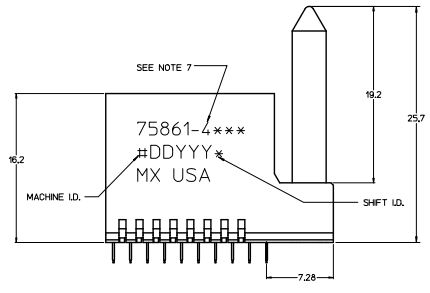
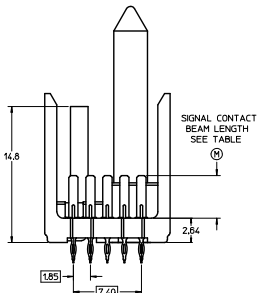
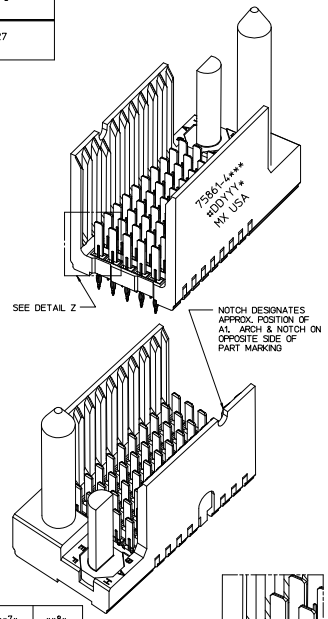

THE PRIMARY CARTON WITH A LABEL STATING "ELV AND RoHS COMPLAINT" IS LEAD FREE. CARTONS WITHOUT THIS LABEL MAY CONTAIN LEAD.

- NOTES:
- MATERIAL: HOUSING - LIQUID CRYSTAL POLYMER (LCP), GLASS-FILLED, UL 94V-0, GRAY, SIGNAL CONTACTS - HIGH PERFORMANCE COPPER ALLOY.
 - FINISHES: SELECTIVE GOLD (Au) ON CONTACT AREA, SELECTIVE MATTE TIN (Sn) ON TAIL AREA, NICKEL (Ni) OVERALL.
 - 10-COLUMN ASSEMBLY SHOWN AS REFERENCE. SEE TABLE AND CHART FOR OTHER OPTIONS.
 - PARTS PACKAGED PER PK-70873-5058.
 - THIS PART CONFORMS TO MOLEX PRODUCT SPECIFICATION PS-75221-999.
 - FOR MIXED CONTACT LENGTHS CONSULT MOLEX.
 - EITHER MARK PART NUMBER AND DATE CODE APPROXIMATELY WHERE SHOWN OR PLACE A LABEL ON THE TUBE.
 - MINIMUM CIRCUIT BOARD THICKNESS: 1.6
 - OPTIONAL HOLE LOCATION FOR GROUNDED GUIDE PIN OR FOR ADDITIONAL GUIDE PIN SUPPORT. FOR GROUNDED GUIDE, HOLE TO BE PLATED, DRILL SIZE #2.58, PAD SIZE #5.50
 - THESE PARTS CONFORM TO MOLEX COSMETIC SPECIFICATION PS-45499-002 CLASS B.
 - MAPS (MOLEX ADVANCED PLATING SYSTEM).

LEAD-FREE PLATING

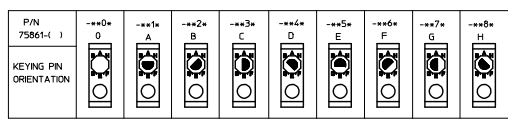

REV. TO LEAD-FREE	QUALITY SYMBOLS	GENERAL TOLERANCES (UNLESS SPECIFIED)	DIMENSION STYLE	SCALE	DESIGN UNITS	THIRD ANGLE PROJECTION
REV. NO. 07/03/9005	▽=0	mm	MM ONLY <td>5:1 <td>METRIC</td> <td>THIRD ANGLE PROJECTION</td> </td>	5:1 <td>METRIC</td> <td>THIRD ANGLE PROJECTION</td>	METRIC	THIRD ANGLE PROJECTION
DRWINGS: 2002/09/05	▽=0.1	INCH				
CHKD DATE: 2002/09/05	▽=0.2					
APPROVAL: 2002/07/05	▽=0.3					
	▽=0.4					
	▽=0.5					
	▽=0.6					
	▽=0.7					
	▽=0.8					
	▽=0.9					
	▽=1.0					
	▽=1.1					
	▽=1.2					
	▽=1.3					
	▽=1.4					
	▽=1.5					
	▽=1.6					
	▽=1.7					
	▽=1.8					
	▽=1.9					
	▽=2.0					
	▽=2.1					
	▽=2.2					
	▽=2.3					
	▽=2.4					
	▽=2.5					
	▽=2.6					
	▽=2.7					
	▽=2.8					
	▽=2.9					
	▽=3.0					
	▽=3.1					
	▽=3.2					
	▽=3.3					
	▽=3.4					
	▽=3.5					
	▽=3.6					
	▽=3.7					
	▽=3.8					
	▽=3.9					
	▽=4.0					
	▽=4.1					
	▽=4.2					
	▽=4.3					
	▽=4.4					
	▽=4.5					
	▽=4.6					
	▽=4.7					
	▽=4.8					
	▽=4.9					
	▽=5.0					
	▽=5.1					
	▽=5.2					
	▽=5.3					
	▽=5.4					
	▽=5.5					
	▽=5.6					
	▽=5.7					
	▽=5.8					
	▽=5.9					
	▽=6.0					
	▽=6.1					
	▽=6.2					
	▽=6.3					
	▽=6.4					
	▽=6.5					
	▽=6.6					
	▽=6.7					
	▽=6.8					
	▽=6.9					
	▽=7.0					
	▽=7.1					
	▽=7.2					
	▽=7.3					
	▽=7.4					
	▽=7.5					
	▽=7.6					
	▽=7.7					
	▽=7.8					
	▽=7.9					
	▽=8.0					
	▽=8.1					
	▽=8.2					
	▽=8.3					
	▽=8.4					
	▽=8.5					
	▽=8.6					
	▽=8.7					
	▽=8.8					
	▽=8.9					
	▽=9.0					
	▽=9.1					
	▽=9.2					
	▽=9.3					
	▽=9.4					
	▽=9.5					
	▽=9.6					
	▽=9.7					
	▽=9.8					
	▽=9.9					
	▽=10.0					

SD-75861-4104 1 OF 1