



Distributor of ASSMANN WSW Components: Excellent Integrated System Limited
Datasheet of AU-Y1008 - Connector Receptacle USB TypeA, Stacked 1.1 8 Position Through Hole, Right Angle, Horizontal

Contact us: sales@integrated-circuit.com Website: www.integrated-circuit.com

Excellent Integrated System Limited

Stocking Distributor

Click to view price, real time Inventory, Delivery & Lifecycle Information:

[ASSMANN WSW Components](#)
[AU-Y1008](#)

For any questions, you can email us directly:

sales@integrated-circuit.com

Contact us: sales@integrated-circuit.com Website: www.integrated-circuit.com

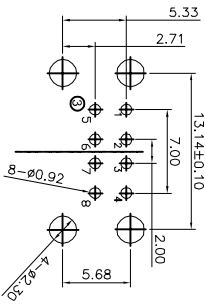
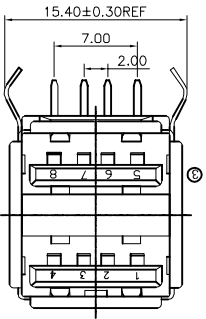
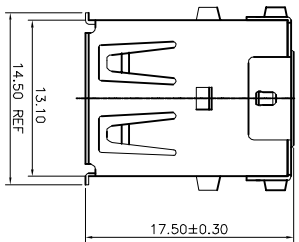
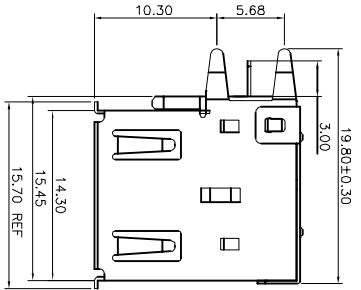

NOTES:

1. Material:
 - 1.1 Housing: PBT+30%GF UL94V-0, Color Black
 - 1.2 Shell: SPCC
 - 1.3 Contact :Brass
2. FINISH:
 - 2.1 Contact Area: Selective 5u"Au
 - Solder Area: Tin Plated
3. MECHANICAL:
 - Under: Ni Plated
 - 3.1 Mating Force: 3.57kgf Max.
 - 3.2 Unmating Force: 1.02kgf Min
 - 3.3 Durability: 1500 cycles Min
4. ELECTRICAL:
 - 4.1 Current Rating: 1.5A
 - 4.2 Dielectric Strength: 500V AC FOR 1 MINUTE
 - 4.3 Contact Resistance: 30mΩ Max
 - 4.4 Insulation Resistance: 1000 MΩ Min
5. Operating temperature: -55°C TO +85°C
6. Soldering temperature: 245°C ±5°C for 3~5 Sec
7. PACKING: Tray

RoHS compliant

Scale	Free								
TOLERANCE									
.X	±0.30	③	Change the Pin number	03.04.2014	Winnie	Drawn	07.06.2013	Winnie	ASSMANN WSW-No.
.XX	±0.20	②	Add the soldering temperature	27.12.2013	Winnie	Approved	03.04.2014	Winnie	① AU-Y1008
.XXX	±0.10	①	Update the P/N	10.12.2013	Winnie	Drawing-No.			
DIM	TOL	①	Drawn	07.06.2013	Winnie	ASS 5781 CO			
X. °	±5°								
Angle	TOL								
UNIT	mm								

ASSMANN
 WSW/ components

ASS 5781 CO rev03

SHEET

1

2

3

4

5

6

7

1

2

3

4

5

6

7