

Excellent Integrated System Limited

Stocking Distributor

Click to view price, real time Inventory, Delivery & Lifecycle Information:

[Molex Connector Corporation](#)

[0765461129](#)

For any questions, you can email us directly:

sales@integrated-circuit.com

20 19 18 17 16 15 14 13 12 11 10 9 8 7 6 5 4 3 2 1

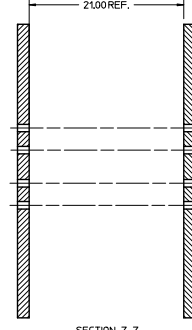
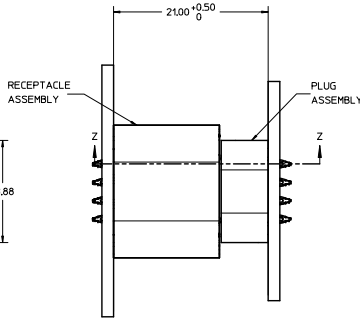
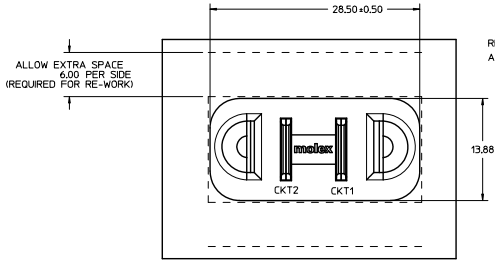
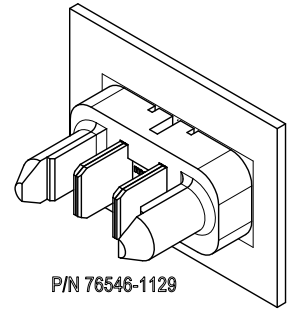
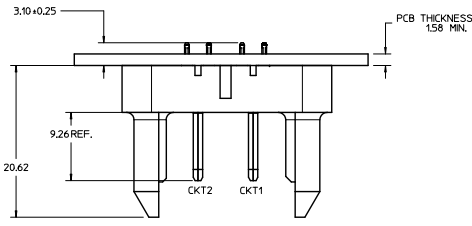

SECTION Z-Z

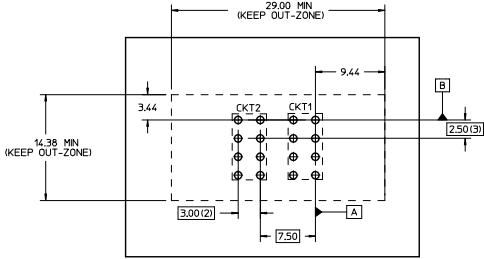

RECOMMENDED PCB LAYOUT AND KEEP-OUT ZONE

NOTES:

1. MATERIAL:
 - HOUSINGS: LCP UL94 V-0, COLOR: BLACK.
 - TERMINALS: COPPER ALLOY.
 - PLATING: 0.000127 NICKEL OVERALL WITH 0.00254 SELECTIVE MATTE TIN ON COMPLIANT PINS AND 0.000762 SELECTIVE GOLD ON CONTACT AREA.
2. PACKAGING ASSEMBLIES TO BE TRAY PACKED, STD. QUANTITY: TBD.
3. PC BOARD REQUIRES THRU HOLES. REFER TO PS-46436-100 FOR DETAILS.
4. PRODUCT SPEC: PS-46436-100.
5. APPLICATION SPEC: AS-46436-100.
6. SEE PRODUCT SPEC FOR MEET ROHS REQUIREMENTS.
7. ASSEMBLY MATES WITH MOLEX VERTICAL RECEPTACLE ASSEMBLY, P/N 46562-1129.

PRELIMINARY EC NO. LCP200-2269 DRAWN: MKARADIMAS 2010/03/25 CHECKED: BKOSTILIC 2010/03/25 APPROVED: APATEL 2010/04/29 DESIGNED BY:	QUALITY SYMBOLS	GENERAL TOLERANCES (UNLESS SPECIFIED)	DIMENSION STYLE	SCALE	DESIGN UNITS	THIRD ANGLE PROJECTION	
	$\nabla=0$ $\nabla=0$ $\nabla=0$	4 PLACES ±--- ±--- 3 PLACES ±--- ±--- 2 PLACES ±0.25 ±--- 1 PLACE ±0.25 ±--- ANGULAR ±1/2°	mm INCH ---+--- +---+--- ---+--- +---+--- ---+--- +---+--- ---+--- +---+---	DRAWN BY DATE MKARADIMAS 2010/03/25 CHECKED BY DATE BKOSTILIC 2010/03/25 APPROVED BY DATE APATEL 2010/04/29	4:1	METRIC	TITLE VERTICAL PLUG ASSY 2 AC PRESS-FIT TEN60 FAMILY
	MATERIAL NO. 76546-1129	DRAFT WHERE APPLICABLE MUST REMAIN WITHIN DIMENSIONS	MOLEX INCORPORATED	DOCUMENT NO. SD-76546-1129	SHEET NO. 1 OF 1		
	SIZE D THIS DRAWING CONTAINS INFORMATION THAT IS PROPRIETARY TO MOLEX INCORPORATED AND SHOULD NOT BE USED WITHOUT WRITTEN PERMISSION						

19 18 17 16 15 14 13 12 11 10 9 8 7 6 5 4 3 2 1