

Excellent Integrated System Limited

Stocking Distributor

Click to view price, real time Inventory, Delivery & Lifecycle Information:

[Molex Connector Corporation](#)
[19073-0145](#)

For any questions, you can email us directly:

sales@integrated-circuit.com

| 10 | | 9 | | 8 | | 7 | | 6 | | 5 | | 4 | | 3 | | 2 | | 19073 | |
|-----------------|----------|------------------------------|-----------|-----------|--------------|--------------|--------------|---------------|--|---|--|---|--|---|--|---|--|-------|--|
| MATERIAL NUMBER | ENG. NO. | MATERIAL NUMBER TAPE MOUNTED | ENG. NO. | STUD SIZE | *"S" ±.005 | *"W" MAX | *"C" MIN | *"L" MAX | | | | | | | | | | | |
| 190730145 | C-801-12 | 190730146 | C-801-12T | 12 | .515 (13.08) | .760 (19.30) | .611 (15.52) | 1.580 (40.13) | | | | | | | | | | | |
| 190730148 | C-801-14 | ----- | ----- | 14 | .265 (6.73) | | | | | | | | | | | | | | |
| 190730150 | C-801-38 | ----- | ----- | 38 | .390 (9.91) | | | | | | | | | | | | | | |
| 190730152 | C-801-56 | ----- | ----- | 56 | .328 (8.33) | | | | | | | | | | | | | | |
| 190730154 | C-801-76 | ----- | ----- | 76 | .453 (11.51) | | | | | | | | | | | | | | |
| 190730156 | C-828-04 | 190730157 | C-828-04T | 04 | .119 (3.02) | .385 (9.78) | .303 (7.70) | 1.091 (27.71) | | | | | | | | | | | |
| 190730160 | C-828-06 | 190730162 | C-828-06T | 06 | .146 (3.71) | | | | | | | | | | | | | | |
| 190730165 | C-828-08 | 190730167 | C-828-08T | 08 | .173 (4.39) | | | | | | | | | | | | | | |
| 190730170 | C-828-10 | 190730172 | C-828-10T | 10 | .198 (5.03) | | | | | | | | | | | | | | |
| 190730175 | C-828-14 | ----- | ----- | 14 | .265 (6.73) | | | | | | | | | | | | | | |

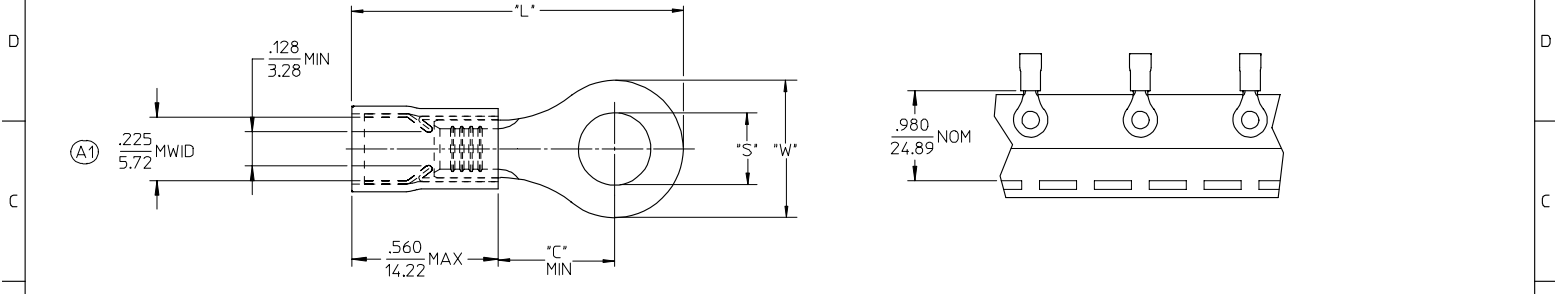

SALES DRAWING

- NOTES:
 1. MATERIAL: COPPER (.040/1.02) THICK.
 PLATING: ELECTROPLATE TIN
 2. FERRULE: TIN PLATED BRASS
 3. INSULATION: YELLOW NYLON
 4. MWID=MAXIMUM WIRE INSULATION DIA.
 5. ALL DIMENSIONS IN INCHES (MM).
 6. WIRE SIZE: 12-10 AWG
 4.0-6.0 MM²

| | | | | | | | | |
|--|-------------------------------|---------------------------------------|-----------------------|---|-------------------|---|---------------------------|------------------|
| EC NO. ETC2006-0152 DRWN: A SAYDEH 2005/12/12 CHKD: JLOMASTR0005/12/13 APPR: RDEROSS 2005/12/14 | QUALITY SYMBOLS ▽-0 ▽-0 | GENERAL TOLERANCES (UNLESS SPECIFIED) | | SCALE 4:1 | DESIGN UNITS INCH | THIRD ANGLE PROJECTION | REVISE ON CAD ONLY | |
| | | 4 PLACES ± --- ± --- | 3 PLACES ± --- ± .005 | DIMENSION STYLE IN/MM | | TITLE RING TONGUE TERMINAL AVIKRIMP, 800-SERIES 12-10 AWG | | |
| | | 2 PLACES ± 0.13 ± .01 | 1 PLACE ± 0.25 ± --- | DRAWN BY DMYRICK | DATE 03/12/15 | MOLEX INCORPORATED | | |
| | | ANGULAR ± 1 ° | | CHECKED BY SBEITZEL | DATE 03/12/15 | MATERIAL NO. SEE CHART | DOCUMENT NO. SD-19073-007 | SHEET NO. 1 OF 1 |
| DRAFT WHERE APPLICABLE MUST REMAIN WITHIN DIMENSIONS | | APPROVED BY RDEROSS | DATE 03/12/15 | THIS DRAWING CONTAINS INFORMATION THAT IS PROPRIETARY TO MOLEX INCORPORATED AND SHOULD NOT BE USED WITHOUT WRITTEN PERMISSION | | | | |