

## Excellent Integrated System Limited

Stocking Distributor

Click to view price, real time Inventory, Delivery & Lifecycle Information:

[Molex Connector Corporation](#)  
[0192120005](#)

For any questions, you can email us directly:

[sales@integrated-circuit.com](mailto:sales@integrated-circuit.com)

10	9	8	7	6	5	4	3	2	19212		
MATERIAL NO. LOOSE PIECE	ENGINEERING NO. LOOSE PIECE	MATERIAL NO. ON TAPE	ENGINEERING NO. ON TAPE	WIRE SIZE	INSULATOR COLOR	ID MINIMUM	L MAXIMUM	P (A1) MINIMUM	D ±.01/0.25	MWID	B MAX (A1)
192120003	WP-2218X	192120004	WP-2218XT	22-18 AWG	RED	.055/1.40	.93/23.6	.35/8.9	.078/1.98	.145/3.68	.41/10.4
192120005	WP-2614X	192120006	WP-2614XT	16-14 AWG	BLUE	.081/2.06 (A1)	.93/23.6	.35/8.9	.078/1.98	.175/4.44	.41/10.4
192120001	WP-2210X	192120002	WP-2210XT	12-10 AWG	YELLOW	.126/3.20	1.12/28.4	.41/10.4	.107/2.72	.250/6.35	.56/14.2

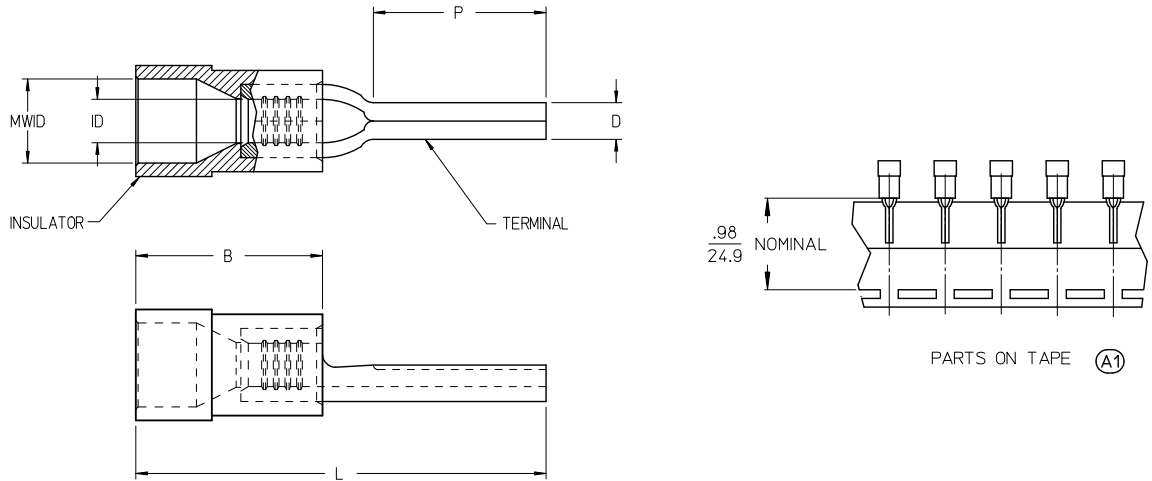

- NOTES:
1. TERMINAL MATERIAL: COPPER
  2. TERMINAL FINISH: TIN PLATED
  3. INSULATOR MATERIAL: PVC
  4. MWID = MAXIMUM WIRE INSULATION DIAMETER.
  5. PARTS ARE ROHS COMPLIANT.

<b>CORRECT TOLERANCES</b> E.C. NO: WNA2009-0437 DRAWN BY: DRW:ETHRODAHL 2010/03/18 CHECKED BY: JMACNEIL 2010/03/18 APPR: JMACNEIL 2010/03/18	<b>QUALITY SYMBOLS</b> ▽=0 ▽=0 ▽=0	<b>GENERAL TOLERANCES (UNLESS SPECIFIED)</b>		<b>DIMENSION STYLE</b> IN/MM		SCALE 5:1	DESIGN UNITS INCH	THIRD ANGLE PROJECTION	
		4 PLACES ±	±	mm	INCH	DRAWN BY EMF	DATE 1992/10/08		<b>WIRE PIN TERMINAL, INSULKRIMP</b>
		3 PLACES ±	±	mm	INCH	CHECKED BY JM	DATE 1992/10/08		
		2 PLACES ±	±	mm	INCH	APPROVED BY JMACNEIL	DATE 2010/03/18		
1 PLACE ±	±	mm	INCH	ANGULAR ±---°		<b>MOLEX INCORPORATED</b>			
DRAFT WHERE APPLICABLE MUST REMAIN WITHIN DIMENSIONS		SEE CHART		MATERIAL NO. SD-19212-001	DOCUMENT NO.	SHEET NO. 1 OF 1			
SIZE B		THIS DRAWING CONTAINS INFORMATION THAT IS PROPRIETARY TO MOLEX INCORPORATED AND SHOULD NOT BE USED WITHOUT WRITTEN PERMISSION							