

## Excellent Integrated System Limited

Stocking Distributor

Click to view price, real time Inventory, Delivery & Lifecycle Information:

[Molex Connector Corporation](#)  
[1060320000](#)

For any questions, you can email us directly:

[sales@integrated-circuit.com](mailto:sales@integrated-circuit.com)

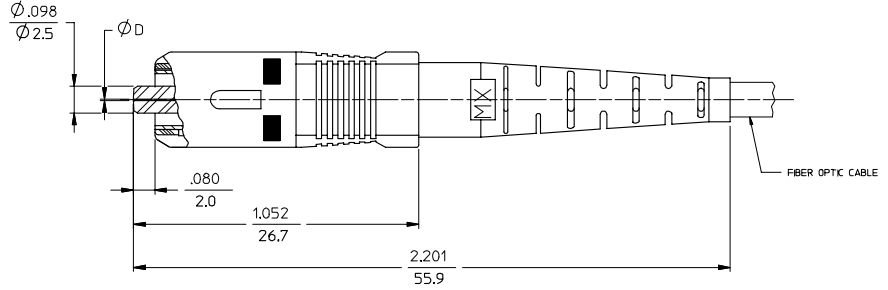
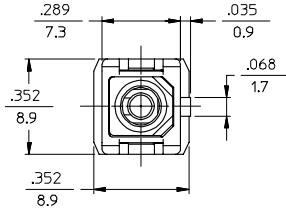

**NOTES:**

1. ALL DIMENSIONS ARE FOR REFERENCE ONLY.

\*2. P/NS 106032-5020, 106032-0140, 106032-5310, 106032-5990 AND 106032-0910 ARE BULK PACKED IN QUANTITIES OF 100 pcs.

ENTER DESCRIPTION IEC NO: MF2007-0445 DRAWN BY: DRINKREVZNER CHKD: 2007/01/12 APPR: IGMIN 2007/01/15 REV: B1	QUALITY SYMBOLS ▽=0 ∇=0	GENERAL TOLERANCES (UNLESS SPECIFIED) <table border="1"> <thead> <tr> <th></th> <th>mm</th> <th>INCH</th> </tr> </thead> <tbody> <tr> <td>4 PLACES</td> <td>± .005</td> <td>± .0004</td> </tr> <tr> <td>3 PLACES</td> <td>± .003</td> <td>± .0002</td> </tr> <tr> <td>2 PLACES</td> <td>± .002</td> <td>± .0001</td> </tr> <tr> <td>1 PLACE</td> <td>± .001</td> <td>± .00005</td> </tr> </tbody> </table> ANGULAR ±1/2°		mm	INCH	4 PLACES	± .005	± .0004	3 PLACES	± .003	± .0002	2 PLACES	± .002	± .0001	1 PLACE	± .001	± .00005	DIMENSION STYLE IN/MM	SCALE 4:1	DESIGN UNITS INCH	THIRD ANGLE PROJECTION
		mm	INCH																		
	4 PLACES	± .005	± .0004																		
	3 PLACES	± .003	± .0002																		
2 PLACES	± .002	± .0001																			
1 PLACE	± .001	± .00005																			
DRAWN BY: RPACIFICI DATE: 2005/12/22	CHECKED BY:	DATE:	TITLE SC CONNECTOR (TUNABLE)	MOLEX INCORPORATED																	
APPROVED BY:	DATE:	MATERIAL NO. SEE TABLE	DOCUMENT NO. SD-106032-XXX0	SHEET NO. 1 OF 3	THIS DRAWING CONTAINS INFORMATION THAT IS PROPRIETARY TO MOLEX INCORPORATED AND SHOULD NOT BE USED WITHOUT WRITTEN PERMISSION																
DRAFT WHERE APPLICABLE MUST REMAIN WITHIN DIMENSIONS																					

10	9	8	7	6	5	4	3	2	1		
CONNECTOR P/N	Ø (Hm)	BOOT COLOR	HOUSING COLOR	CONNECTOR TYPE	CABLE (mm)	CONNECTOR P/N	Ø (Hm)	BOOT COLOR	HOUSING COLOR	CONNECTOR TYPE	CABLE (mm)
106032-0000	127	BLUE	BLUE	MULTIMODE	3	106032-3000	128	BLUE	BLUE	MULTIMODE	3
106032-0900					2.0 & 1.6 DUPLEX	106032-3900					2.0 & 1.6 DUPLEX
106032-0100					1.6 SIMPLEX	106032-3100					1.6 SIMPLEX
106032-0050					3	106032-3060					3
106032-0950					2.0 & 1.6 DUPLEX	106032-3960					2.0 & 1.6 DUPLEX
106032-0150					1.6 SIMPLEX	106032-3160					1.6 SIMPLEX
106032-0060		3	106032-3050		3						
106032-0910*		2.0 & 1.6 DUPLEX	106032-3950		2.0 & 1.6 DUPLEX						
106032-0960		1.6 SIMPLEX	106032-3150		1.6 SIMPLEX						
106032-0140*		3	106032-3080		3						
106032-0160		2.0 & 1.6 DUPLEX	106032-3980		2.0 & 1.6 DUPLEX						
106032-0080		3	106032-3180		1.6 SIMPLEX						
106032-0980	RED	RED	2.0 & 1.6 DUPLEX	106032-3070	3						
106032-0180			1.6 SIMPLEX	106032-3970	2.0 & 1.6 DUPLEX						
106032-0070			3	106032-3170	1.6 SIMPLEX						
106032-0970			2.0 & 1.6 DUPLEX								
106032-0170			1.6 SIMPLEX								
106032-2000	125.5	YELLOW	SINGLE MODE	3							
106032-2900				2.0 & 1.6 DUPLEX							
106032-2100				1.6 SIMPLEX							
106032-2050				3							
106032-2950				2.0 & 1.6 DUPLEX							
106032-2150				1.6 SIMPLEX							
106032-2080		3									
106032-2980		2.0 & 1.6 DUPLEX									
106032-2180		1.6 SIMPLEX									
106032-2070		3									
106032-2970		2.0 & 1.6 DUPLEX									
106032-2170		1.6 SIMPLEX									

ENTER DESCRIPTION EC NO: MF2007-0445 DRAWN BY: DRINKWELTZNER CHKD: 2007/01/12 APPR: GUMIN 2007/01/15	QUALITY SYMBOLS ▽=0 ▽=0	GENERAL TOLERANCES (UNLESS SPECIFIED)		DIMENSION STYLE	SCALE	DESIGN UNITS	THIRD ANGLE PROJECTION
		mm	INCH	IN/MM	4:1	INCH	
		DRAWN BY: RPACIFIC1		DATE: 2005/12/22	TITLE: SC CONNECTOR (TUNABLE)		
		CHECKED BY:		DATE:			
APPROVED BY:		DATE:	MATERIAL NO.:			DOCUMENT NO.:	
DRAFT WHERE APPLICABLE MUST REMAIN WITHIN DIMENSIONS		SEE TABLE		SD-106032-XXX0			SHEET NO. 2 OF 3
THIS DRAWING CONTAINS INFORMATION THAT IS PROPRIETARY TO MOLEX INCORPORATED AND SHOULD NOT BE USED WITHOUT WRITTEN PERMISSION							

10	9	8	7	6	5	4	3	2	106032		
CONNECTOR P/N	Ø (mm)	BOOT COLOR	HOUSING COLOR	CONNECTOR TYPE	CABLE (mm)	CONNECTOR P/N	Ø (mm)	BOOT COLOR	HOUSING COLOR	CONNECTOR TYPE	CABLE (mm)
106032-4000	125	YELLOW	BLUE	SINGLE MODE	3	106032-6000	125.5	YELLOW	BLUE	SINGLE MODE	3
106032-4900					2.0 & 1.6 DUPLEX	106032-6900					2.0 & 1.6 DUPLEX
106032-4100					1.6 SIMPLEX	106032-6100					1.6 SIMPLEX
106032-4050					3	106032-7000					3
106032-4950					2.0 & 1.6 DUPLEX	106032-7900					2.0 & 1.6 DUPLEX
106032-4150		1.6 SIMPLEX	106032-7100		1.6 SIMPLEX						
106032-4080		3	106032-7050		3						
106032-4980		2.0 & 1.6 DUPLEX	106032-7950		2.0 & 1.6 DUPLEX						
106032-4180		1.6 SIMPLEX	106032-7150		1.6 SIMPLEX						
106032-4070		3	106032-7080		3						
106032-4970	126	BLACK	BLACK	SINGLE MODE	2.0 & 1.6 DUPLEX	106032-7980	127	WHITE	RED	SINGLE MODE	2.0 & 1.6 DUPLEX
106032-4170					1.6 SIMPLEX	106032-7180					1.6 SIMPLEX
106032-5000					3	106032-7070					3
106032-5020*					2.4	106032-7970					2.0 & 1.6 DUPLEX
106032-5300					2.0 & 1.6 DUPLEX	106032-7170					1.6 SIMPLEX
106032-5310*		1.6 SIMPLEX									
106032-5900		3									
106032-5990*		2.0 & 1.6 DUPLEX									
106032-5100		1.6 SIMPLEX									
106032-5050		WHITE	BLUE		SINGLE MODE	3					
106032-5950	2.0 & 1.6 DUPLEX										
106032-5150	1.6 SIMPLEX										
106032-5080	3										
106032-5980	2.0 & 1.6 DUPLEX										
106032-5180	RED	RED	SINGLE MODE	1.6 SIMPLEX							
106032-5070				3							
106032-5970				2.0 & 1.6 DUPLEX							
106032-5170				1.6 SIMPLEX							

ENTER DESCRIPTION EC NO: MF2007-0445 DRAWN: REIZNER CHKD: GUMIN APPR: GUMIN B1	QUALITY SYMBOLS ▽=0 ▽=0	GENERAL TOLERANCES (UNLESS SPECIFIED)		DIMENSION STYLE	SCALE	DESIGN UNITS	THIRD ANGLE PROJECTION	
		4 PLACES	±	---	IN/MM	4:1	INCH	SC CONNECTOR (TUNABLE)
		3 PLACES	±	---	DRAWN BY	DATE	TITLE	
		2 PLACES	±	---	RPACIFIC1	2005/12/22	SC CONNECTOR (TUNABLE)	
1 PLACE	±	---	CHECKED BY	DATE	APPROVED BY	DATE	MATERIAL NO.	
ANGULAR ±1/2°		DRAFT WHERE APPLICABLE MUST REMAIN WITHIN DIMENSIONS		SEE TABLE	DOCUMENT NO.		SHEET NO.	
				SIZE B	SD-106032-XXX0		3 OF 03	
THIS DRAWING CONTAINS INFORMATION THAT IS PROPRIETARY TO MOLEX INCORPORATED AND SHOULD NOT BE USED WITHOUT WRITTEN PERMISSION								