

Excellent Integrated System Limited

Stocking Distributor

Click to view price, real time Inventory, Delivery & Lifecycle Information:

[Molex Connector Corporation](#)
[1060320160](#)

For any questions, you can email us directly:
sales@integrated-circuit.com

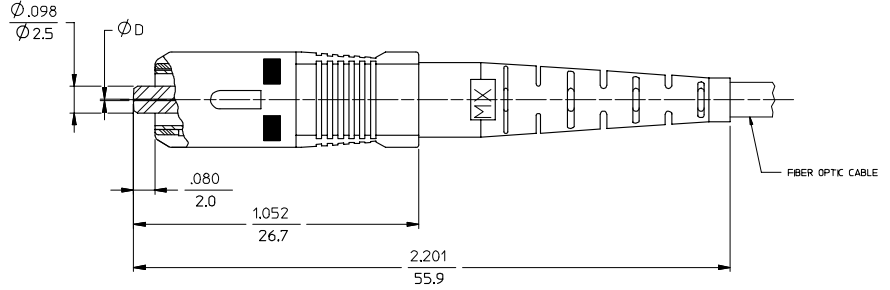
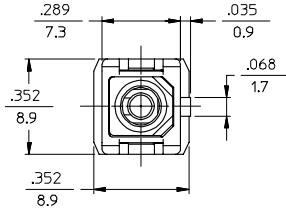

NOTES:

1. ALL DIMENSIONS ARE FOR REFERENCE ONLY.

*2. P/NS 106032-5020, 106032-0140, 106032-5310, 106032-5990 AND 106032-0910 ARE BULK PACKED IN QUANTITIES OF 100 pcs.

ENTER DESCRIPTION ILC NO: MF2007-0445 DRAWN BY: ZNER CHKD: ZNER APPR: IGMIN DATE: 2007/11/12 DATE: 2007/11/12 DATE: 2007/11/15	QUALITY SYMBOLS $\nabla=0$ $\sphericalangle=0$	GENERAL TOLERANCES (UNLESS SPECIFIED)		DIMENSION STYLE IN/MM	SCALE 4:1	DESIGN UNITS INCH	THIRD ANGLE PROJECTION		
		4 PLACES ±--- ±---	3 PLACES ±--- ±---	2 PLACES ±--- ±---	1 PLACE ±--- ±---	DRAWN BY: RPACIFICI DATE: 2005/12/22	TITLE: SC CONNECTOR (TUNABLE)		
		ANGULAR ±1/2°				APPROVED BY:	DATE:	MOLEX INCORPORATED	
		DRAFT WHERE APPLICABLE MUST REMAIN WITHIN DIMENSIONS		MATERIAL NO. SEE TABLE	DOCUMENT NO. SD-106032-XXX0	SHEET NO. 1 OF 3	THIS DRAWING CONTAINS INFORMATION THAT IS PROPRIETARY TO MOLEX INCORPORATED AND SHOULD NOT BE USED WITHOUT WRITTEN PERMISSION		

10	9	8	7	6	5	4	3	2	1		
CONNECTOR P/N	Ø (Hm)	BOOT COLOR	HOUSING COLOR	CONNECTOR TYPE	CABLE (mm)	CONNECTOR P/N	Ø (Hm)	BOOT COLOR	HOUSING COLOR	CONNECTOR TYPE	CABLE (mm)
106032-0000	127	BLUE	BLUE	MULTIMODE	3	106032-3000	128	BLUE	BLUE	MULTIMODE	3
106032-0900					2.0 & 1.6 DUPLEX	106032-3900					2.0 & 1.6 DUPLEX
106032-0100					1.6 SIMPLEX	106032-3100					1.6 SIMPLEX
106032-0050					3	106032-3060					3
106032-0950					2.0 & 1.6 DUPLEX	106032-3960					2.0 & 1.6 DUPLEX
106032-0150					1.6 SIMPLEX	106032-3160					1.6 SIMPLEX
106032-0060		3	106032-3050		3						
106032-0910*		2.0 & 1.6 DUPLEX	106032-3950		2.0 & 1.6 DUPLEX						
106032-0960		1.6 SIMPLEX	106032-3150		1.6 SIMPLEX						
106032-0140*		3	106032-3080		3						
106032-0160		2.0 & 1.6 DUPLEX	106032-3980		2.0 & 1.6 DUPLEX						
106032-0080		3	106032-3180		1.6 SIMPLEX						
106032-0980	RED	RED	MULTIMODE	2.0 & 1.6 DUPLEX	106032-3070	RED	RED	MULTIMODE	3		
106032-0180				1.6 SIMPLEX	106032-3180				1.6 SIMPLEX		
106032-0070				3	106032-3070				3		
106032-0970				2.0 & 1.6 DUPLEX	106032-3970				2.0 & 1.6 DUPLEX		
106032-0170				1.6 SIMPLEX	106032-3170				1.6 SIMPLEX		
106032-2000				3							
106032-2900	YELLOW	BLUE		SINGLE MODE	2.0 & 1.6 DUPLEX						
106032-2100					1.6 SIMPLEX						
106032-2050					3						
106032-2950					WHITE	BLUE	2.0 & 1.6 DUPLEX				
106032-2150							1.6 SIMPLEX				
106032-2080							3				
106032-2980	2.0 & 1.6 DUPLEX										
106032-2180	1.6 SIMPLEX										
106032-2070	3										
106032-2970	RED	RED	SINGLE MODE		2.0 & 1.6 DUPLEX						
106032-2170					1.6 SIMPLEX						
106032-2970	BLACK	BLACK			SINGLE MODE	2.0 & 1.6 DUPLEX					
106032-2170				1.6 SIMPLEX							

ENTER DESCRIPTION EC NO: MF2007-0445 DRAWN BY: DRINKWELTZNER CHKD: 2007/01/12 APPR: GUMIN 2007/01/15	QUALITY SYMBOLS ▽=0 ▽=0	GENERAL TOLERANCES (UNLESS SPECIFIED)		DIMENSION STYLE	SCALE	DESIGN UNITS	THIRD ANGLE PROJECTION
		4 PLACES	mm	INCH	4:1	INCH	SC CONNECTOR (TUNABLE) MOLEX INCORPORATED
		3 PLACES	±	±			
		2 PLACES	±	±			
1 PLACE	±	±					
ANGULAR ±1/2°		DRAWN BY: RPACIFIC1		DATE: 2005/12/22	TITLE: SC CONNECTOR (TUNABLE)		
DRAFT WHERE APPLICABLE MUST REMAIN WITHIN DIMENSIONS		CHECKED BY:		DATE:	DOCUMENT NO: SD-106032-XXX0		
REV: B1		APPROVED BY:		DATE:	SHEET NO: 2 OF 3		
		MATERIAL NO:		SIZE: B	THIS DRAWING CONTAINS INFORMATION THAT IS PROPRIETARY TO MOLEX INCORPORATED AND SHOULD NOT BE USED WITHOUT WRITTEN PERMISSION		

10	9	8	7	6	5	4	3	2	106032							
CONNECTOR P/N	Ø (mm)	BOOT COLOR	HOUSING COLOR	CONNECTOR TYPE	CABLE (mm)	CONNECTOR P/N	Ø (mm)	BOOT COLOR	HOUSING COLOR	CONNECTOR TYPE	CABLE (mm)					
106032-4000	125	YELLOW	BLUE	SINGLE MODE	3	106032-6000	125.5	YELLOW	BLUE	SINGLE MODE	3					
106032-4900					2.0 & 1.6 DUPLEX	106032-6900					2.0 & 1.6 DUPLEX					
106032-4100					1.6 SIMPLEX	106032-6100					1.6 SIMPLEX					
106032-4050					3	106032-7000					3					
106032-4950					2.0 & 1.6 DUPLEX	106032-7900					2.0 & 1.6 DUPLEX					
106032-4150		1.6 SIMPLEX			106032-7100	1.6 SIMPLEX										
106032-4080		3			106032-7050	3										
106032-4980		2.0 & 1.6 DUPLEX			106032-7950	2.0 & 1.6 DUPLEX										
106032-4180		1.6 SIMPLEX			106032-7150	1.6 SIMPLEX										
106032-4070		3			106032-7080	3										
106032-4970	126	BLACK	BLACK	SINGLE MODE	2.0 & 1.6 DUPLEX	106032-7980	127	WHITE	RED	SINGLE MODE	2.0 & 1.6 DUPLEX					
106032-4170					1.6 SIMPLEX	106032-7180					1.6 SIMPLEX					
106032-5000					3	106032-7070					3					
106032-5020*					2.4	106032-7970					2.0 & 1.6 DUPLEX					
106032-5300					2.0 & 1.6 DUPLEX	106032-7170					1.6 SIMPLEX					
106032-5310*		1.6 SIMPLEX														
106032-5900		3														
106032-5990*		2.0 & 1.6 DUPLEX														
106032-5100		1.6 SIMPLEX														
106032-5050		WHITE			RED	RED		SINGLE MODE			3					
106032-5950	2.0 & 1.6 DUPLEX															
106032-5150	1.6 SIMPLEX															
106032-5080	3															
106032-5980	2.0 & 1.6 DUPLEX															
106032-5180	BLACK	BLACK	BLACK	SINGLE MODE			1.6 SIMPLEX									
106032-5070							3									
106032-5970							2.0 & 1.6 DUPLEX									
106032-5170							1.6 SIMPLEX									

ENTER DESCRIPTION EC NO: MF2007-0445 DRAWN: REIZNER CHKD: GUMIN APPR: GUMIN B1	QUALITY SYMBOLS ▽=0 ▽=0	GENERAL TOLERANCES (UNLESS SPECIFIED)		DIMENSION STYLE	SCALE	DESIGN UNITS	THIRD ANGLE PROJECTION	
		mm	INCH	IN/MM	4:1	INCH		
		4 PLACES ± --- ± ---		DRAWN BY	DATE	TITLE	SC CONNECTOR (TUNABLE)	
		3 PLACES ± --- ± ---		RPACIFIC1	2005/12/22			
2 PLACES ± --- ± ---		CHECKED BY	DATE					
1 PLACE ± --- ± ---		APPROVED BY	DATE					
ANGULAR ±1/2°		DRAFT WHERE APPLICABLE MUST REMAIN WITHIN DIMENSIONS		MATERIAL NO.	DOCUMENT NO.	SHEET NO.		
				SEE TABLE	SD-106032-XXX0	3 OF 03		
				SIZE B	THIS DRAWING CONTAINS INFORMATION THAT IS PROPRIETARY TO MOLEX INCORPORATED AND SHOULD NOT BE USED WITHOUT WRITTEN PERMISSION			