

## Excellent Integrated System Limited

Stocking Distributor

Click to view price, real time Inventory, Delivery & Lifecycle Information:

[Molex Connector Corporation](#)  
[1060324900](#)

For any questions, you can email us directly:

[sales@integrated-circuit.com](mailto:sales@integrated-circuit.com)

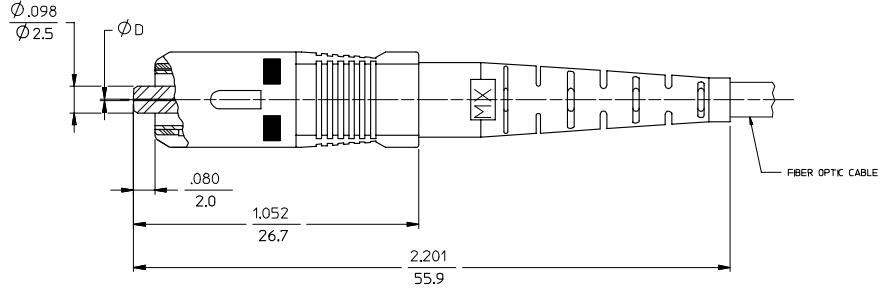
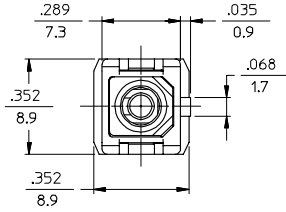

NOTES:

1. ALL DIMENSIONS ARE FOR REFERENCE ONLY.

\*2. P/NS 106032-5020, 106032-0140, 106032-5310, 106032-5990 AND 106032-0910 ARE BULK PACKED IN QUANTITIES OF 100 pcs.

ENTER DESCRIPTION I.C. NO: MF2007-0445 DRAWN BY: ZNER CHKD: ZNER APPR: IGMIN DATE: 2007/11/12 DATE: 2007/11/12 DATE: 2007/11/15 REV: B1	QUALITY SYMBOLS	GENERAL TOLERANCES (UNLESS SPECIFIED)	DIMENSION STYLE	SCALE	DESIGN UNITS	THIRD ANGLE PROJECTION															
	$\nabla=0$ $\sphericalangle=0$	<table border="1"> <thead> <tr> <th></th> <th>mm</th> <th>INCH</th> </tr> </thead> <tbody> <tr> <td>4 PLACES</td> <td>± .005</td> <td>± .0004</td> </tr> <tr> <td>3 PLACES</td> <td>± .003</td> <td>± .0002</td> </tr> <tr> <td>2 PLACES</td> <td>± .002</td> <td>± .0001</td> </tr> <tr> <td>1 PLACE</td> <td>± .001</td> <td>± .00005</td> </tr> </tbody> </table>		mm	INCH	4 PLACES	± .005	± .0004	3 PLACES	± .003	± .0002	2 PLACES	± .002	± .0001	1 PLACE	± .001	± .00005	IN/MM	4:1	INCH	
		mm	INCH																		
	4 PLACES	± .005	± .0004																		
3 PLACES	± .003	± .0002																			
2 PLACES	± .002	± .0001																			
1 PLACE	± .001	± .00005																			
	<table border="1"> <thead> <tr> <th></th> <th>mm</th> <th>INCH</th> </tr> </thead> <tbody> <tr> <td>ANGULAR</td> <td>± 1/2°</td> <td></td> </tr> </tbody> </table>		mm	INCH	ANGULAR	± 1/2°		DRAWN BY: RPACIFICI DATE: 2005/12/22 CHECKED BY: DATE:			SC CONNECTOR (TUNABLE)										
	mm	INCH																			
ANGULAR	± 1/2°																				
	DRAFT WHERE APPLICABLE MUST REMAIN WITHIN DIMENSIONS	MATERIAL NO. SEE TABLE SIZE C	APPROVED BY: DATE: MOLEX INCORPORATED	DOCUMENT NO. SD-106032-XXX0	SHEET NO. 1 OF 3																

10	9	8	7	6	5	4	3	2	1		
CONNECTOR P/N	Ø (Hm)	BOOT COLOR	HOUSING COLOR	CONNECTOR TYPE	CABLE (mm)	CONNECTOR P/N	Ø (Hm)	BOOT COLOR	HOUSING COLOR	CONNECTOR TYPE	CABLE (mm)
106032-0000	127	BLUE	BLUE	MULTIMODE	3	106032-3000	128	BLUE	BLUE	MULTIMODE	3
106032-0900					2.0 & 1.6 DUPLEX	106032-3900					2.0 & 1.6 DUPLEX
106032-0100					1.6 SIMPLEX	106032-3100					1.6 SIMPLEX
106032-0050					3	106032-3060					3
106032-0950					2.0 & 1.6 DUPLEX	106032-3960					2.0 & 1.6 DUPLEX
106032-0150					1.6 SIMPLEX	106032-3160					1.6 SIMPLEX
106032-0060		3	106032-3050		3						
106032-0910*		2.0 & 1.6 DUPLEX	106032-3950		2.0 & 1.6 DUPLEX						
106032-0960		1.6 SIMPLEX	106032-3150		1.6 SIMPLEX						
106032-0140*		3	106032-3080		3						
106032-0160		2.0 & 1.6 DUPLEX	106032-3980		2.0 & 1.6 DUPLEX						
106032-0080		3	106032-3180		1.6 SIMPLEX						
106032-0980	RED	RED	MULTIMODE	2.0 & 1.6 DUPLEX	106032-3070	3	106032-3970	2.0 & 1.6 DUPLEX			
106032-0180				1.6 SIMPLEX	106032-3170	1.6 SIMPLEX					
106032-0070				3							
106032-0970				2.0 & 1.6 DUPLEX							
106032-0170				1.6 SIMPLEX							
106032-2000	125.5	YELLOW		SINGLE MODE	3						
106032-2900					2.0 & 1.6 DUPLEX						
106032-2100					1.6 SIMPLEX						
106032-2050					3						
106032-2950					2.0 & 1.6 DUPLEX						
106032-2150					1.6 SIMPLEX						
106032-2080		3									
106032-2980		2.0 & 1.6 DUPLEX									
106032-2180		1.6 SIMPLEX									
106032-2070		3									
106032-2970		2.0 & 1.6 DUPLEX									
106032-2170		1.6 SIMPLEX									

ENTER DESCRIPTION EC NO: MF2007-0445 DRAWN BY: DRINKWELTZNER CHKD: 2007/01/12 APPR: GUMIN 2007/01/15	QUALITY SYMBOLS ▽=0 ▽=0	GENERAL TOLERANCES (UNLESS SPECIFIED)		DIMENSION STYLE	SCALE	DESIGN UNITS	THIRD ANGLE PROJECTION	
		mm	INCH	IN/MM	4:1	INCH		
		DRAWN BY: RPACIFIC1		DATE: 2005/12/22	TITLE: SC CONNECTOR (TUNABLE)			
		CHECKED BY:		DATE:				
APPROVED BY:		DATE:	MATERIAL NO.		DOCUMENT NO.	SHEET NO.		
ANGULAR ±1/2°		DRAFT WHERE APPLICABLE MUST REMAIN WITHIN DIMENSIONS		SEE TABLE	SD-106032-XXX0	2 OF 3		
				SIZE B	THIS DRAWING CONTAINS INFORMATION THAT IS PROPRIETARY TO MOLEX INCORPORATED AND SHOULD NOT BE USED WITHOUT WRITTEN PERMISSION			

10	9	8	7	6	5	4	3	2	106032		
CONNECTOR P/N	Ø (mm)	BOOT COLOR	HOUSING COLOR	CONNECTOR TYPE	CABLE (mm)	CONNECTOR P/N	Ø (mm)	BOOT COLOR	HOUSING COLOR	CONNECTOR TYPE	CABLE (mm)
106032-4000	125	YELLOW	BLUE	SINGLE MODE	3	106032-6000	125.5	YELLOW	BLUE	SINGLE MODE	3
106032-4900					2.0 & 1.6 DUPLEX	106032-6900					2.0 & 1.6 DUPLEX
106032-4100					1.6 SIMPLEX	106032-6100					1.6 SIMPLEX
106032-4050					3	106032-7000					3
106032-4950					2.0 & 1.6 DUPLEX	106032-7900					2.0 & 1.6 DUPLEX
106032-4150		1.6 SIMPLEX	106032-7100		1.6 SIMPLEX						
106032-4080		3	106032-7050		3						
106032-4980		2.0 & 1.6 DUPLEX	106032-7950		2.0 & 1.6 DUPLEX						
106032-4180		1.6 SIMPLEX	106032-7150		1.6 SIMPLEX						
106032-4070		3	106032-7080		3						
106032-4970	126	BLACK	BLACK	SINGLE MODE	2.0 & 1.6 DUPLEX	106032-7980	127	WHITE	RED	SINGLE MODE	2.0 & 1.6 DUPLEX
106032-4170					1.6 SIMPLEX	106032-7180					1.6 SIMPLEX
106032-5000					3	106032-7070					3
106032-5020*					2.4	106032-7970					2.0 & 1.6 DUPLEX
106032-5300*					2.0 & 1.6 DUPLEX	106032-7170					1.6 SIMPLEX
106032-5310*		1.6 SIMPLEX									
106032-5900		3									
106032-5990*		2.0 & 1.6 DUPLEX									
106032-5100		1.6 SIMPLEX									
106032-5050		WHITE	BLUE		SINGLE MODE	3					
106032-5950	2.0 & 1.6 DUPLEX										
106032-5150	1.6 SIMPLEX										
106032-5080	3										
106032-5980	2.0 & 1.6 DUPLEX										
106032-5180	RED	RED	SINGLE MODE	1.6 SIMPLEX							
106032-5070				3							
106032-5970				2.0 & 1.6 DUPLEX							
106032-5170				1.6 SIMPLEX							

ENTER DESCRIPTION EC NO: MF2007-0445 DRAWN: REIZNER CHKD: GUMIN APPR: GUMIN B1	QUALITY SYMBOLS ▽=0 ▽=0	GENERAL TOLERANCES (UNLESS SPECIFIED)		DIMENSION STYLE IN/MM	SCALE 4:1	DESIGN UNITS INCH	THIRD ANGLE PROJECTION		
		4 PLACES ± --- ± ---	3 PLACES ± --- ± ---	2 PLACES ± --- ± ---	1 PLACE ± --- ± ---	DRAWN BY RPACIFIC1	DATE 2005/12/22	TITLE SC CONNECTOR (TUNABLE)	
		ANGULAR ±1/2°				CHECKED BY	DATE	APPROVED BY	DATE
		DRAFT WHERE APPLICABLE MUST REMAIN WITHIN DIMENSIONS				MATERIAL NO.	DOCUMENT NO. SD-106032-XXX0	SHEET NO. 3 OF 03	
				SIZE B	THIS DRAWING CONTAINS INFORMATION THAT IS PROPRIETARY TO MOLEX INCORPORATED AND SHOULD NOT BE USED WITHOUT WRITTEN PERMISSION				