



Excellent Integrated System Limited

Stocking Distributor

Click to view price, real time Inventory, Delivery & Lifecycle Information:

[NorComp](#)
[160-000-109-000](#)

For any questions, you can email us directly:
sales@integrated-circuit.com

DESCRIPTION: DUST COVER MALE

DIMENSIONS

| | A | B | C | D |
|----|-------|-------|-------|------|
| 9 | .963 | .843 | .580 | .262 |
| | 24.45 | 21.40 | 14.72 | 6.65 |
| 15 | 1.293 | 1.19 | .580 | .262 |
| | 32.85 | 30.19 | 14.72 | 6.65 |
| 25 | 1.822 | 1.71 | .580 | .262 |
| | 46.28 | 43.44 | 14.72 | 6.65 |
| 37 | 2.470 | 2.36 | .580 | .282 |
| | 62.74 | 59.94 | 14.72 | 7.16 |
| 50 | 2.264 | 2.264 | .559 | .319 |
| | 57.51 | 57.51 | 14.19 | 8.10 |

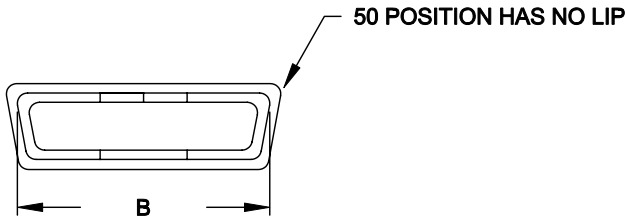
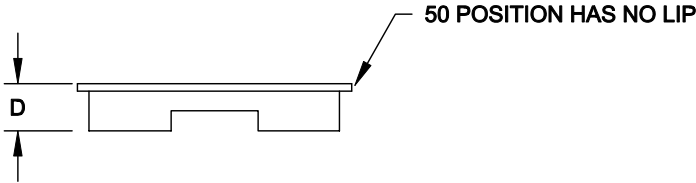
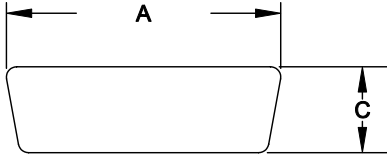

PART NUMBER

| | |
|----|-----------------|
| 09 | 160-000-109-000 |
| 15 | 160-000-115-000 |
| 25 | 160-000-125-000 |
| 37 | 160-000-137-000 |
| 50 | 160-000-150-000 |

MATERIAL:
PLASTIC: PE

| | | | |
|----------------|---|------------------------------|----------------------------|
| | THESE DRAWINGS AND SPECIFICATIONS ARE THE PROPERTY OF NorComp AND SHALL NOT BE REPRODUCED, COPIED OR USED AS THE BASIS FOR THE MANUFACTURE OF SALE OF APPARATUS WITHOUT WRITTEN PERMISSION. | DRAWN: PAM JENKINS | DATE: 8-12-98 |
| | | CHECKED: | DATE: |
| NorComp | | SCALE: | SHEET 1 OF 1 |
| | | DWG NO. | 160-000-1XX-000 |
| | | | REV 3 |