

Excellent Integrated System Limited

Stocking Distributor

Click to view price, real time Inventory, Delivery & Lifecycle Information:

[TE Connectivity AMP Connectors](#)
[414507-1](#)

For any questions, you can email us directly:

sales@integrated-circuit.com

DRAWING MADE IN THIRD ANGLE PROJECTION
THIS DRAWING IS UNPUBLISHED. RELEASED FOR PUBLICATION
© COPYRIGHT 19 BY AMP INCORPORATED. ALL INTERNATIONAL RIGHTS RESERVED.

221162

2

1

LOC	DIST	P	F	ZONE	LTR	DESCRIPTION	DATE	APPD
AJ	16			0		REL PER 93-3361-003	01/29/93	JPD
				A		REV PER 0130-0190-93	02/APR/95	JPD

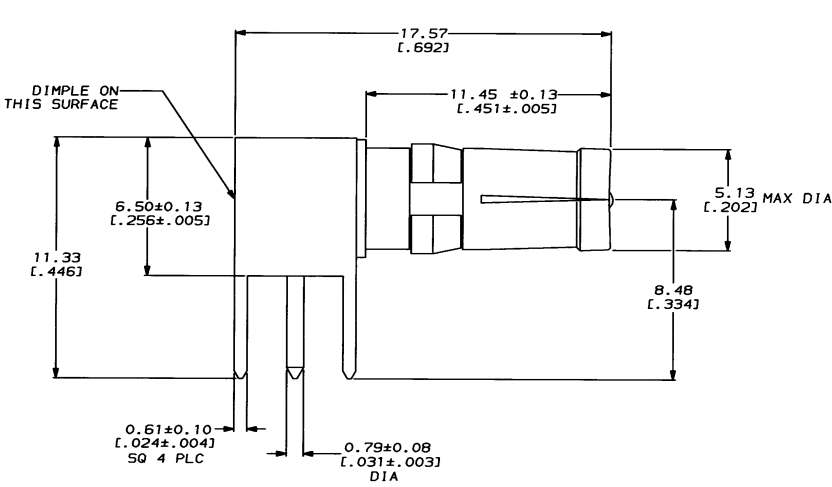

- △ BRASS PER QQ-B-626.
- △ PTFE PER MIL-P-1946B.
- △ PHOSPHOR BRONZE PER QQ-B-750.
- △ BERYLLIUM COPPER PER QQ-C-530.
- △ TIN LEAD PLATE PER ASTM-B-545.
- △ COPPER PLATE PER MIL-C-14550.
- △ NICKEL PLATE PER QQ-N-290.
- △ GOLD PLATE PER MIL-G-45204.
- 9. DIELECTRIC AND CONTACT ASSEMBLY WILL WITHSTAND 2.5 LB PUSHOUT FORCE DIRECTED FROM MATING END.

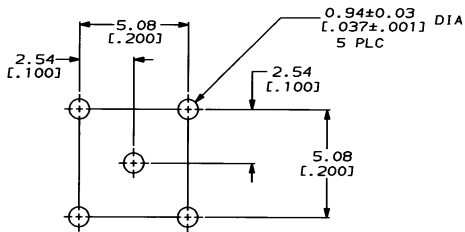

PCB CONFIGURATION

DO NOT SCALE PRINT. UNLESS SPECIFIED DIMENSIONS IN mm [INCHES] TOLERANCES ON : 2 PLC DEC ± 3 PLC DEC ± .010 ANGLES ± 0°30'		DR 01/29/93 J.DAVIS		414507-1 PART NO	
MATERIAL △1 △2 △3 △4		CHK 08-29-91 01/29/93		AMP AMP Incorporated Harrisburg, PA 17105-3608	
FINISH △5 △6 △7 △8		APPD 01/29/93 G.MICHAEL		NAME SOCKET, PCB, RIGHT ANGLE SIZE 8, HDI	
APPLICATION SPEC -		APPD 01/29/93 J.DAVIS		SIZE CAGE CODE DRAWING NO 00779 414507	
WEIGHT -		PRODUCT SPEC -		SCALE 8:1 SHEET 1 OF 1	