

Excellent Integrated System Limited

Stocking Distributor

Click to view price, real time Inventory, Delivery & Lifecycle Information:

[TE Connectivity AMP Connectors](#)
[104890-1](#)

For any questions, you can email us directly:

sales@integrated-circuit.com

DRAWING MADE IN THIRD ANGLE PROJECTION
 THIS DRAWING IS UNPUBLISHED. RELEASED FOR PUBLICATION .19
 © COPYRIGHT 19 BY AMP INCORPORATED. ALL INTERNATIONAL RIGHTS RESERVED.

MOD				LOC				DST				REVISONS			
30	AD	39	P	F	ZONE	LTR	DESCRIPTION				DATE	APPD			
						F	REV. PER 0310-0040-98				07/29/98	GB			

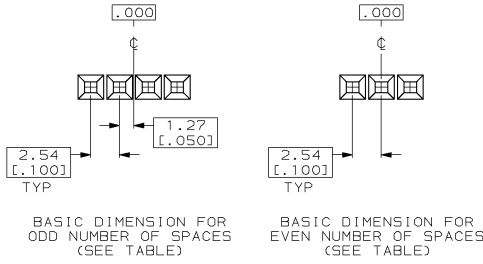

- USE EXTRACTION TOOL 91052-1 TO REMOVE RECEPTACLE CONTACTS.
- INK MARK PART NO. AND DATE CODE .062±.015 HIGH CHARACTERS, IN APPROXIMATE AREA SHOWN.
- INK MARK CAVITY IDENTIFICATION .046±.015 HIGH CHARACTERS, FIRST AND EVERY FIFTH CAVITY, ONE SIDE ONLY AS SHOWN.

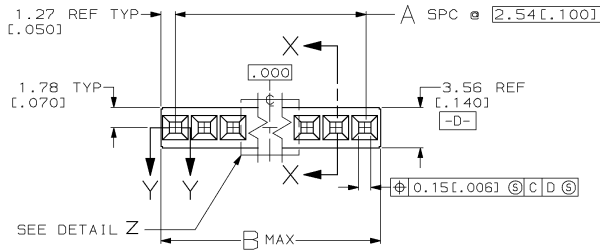
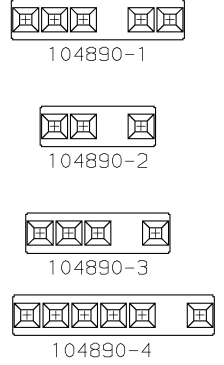
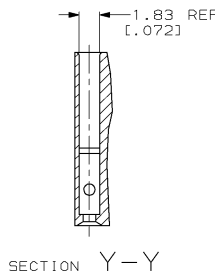
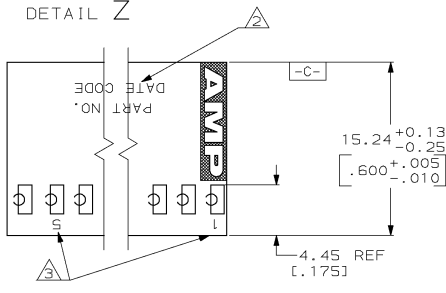

2	104890-5	△ △	17.91 [0.705]	6	7	104890-4
2	-	-	12.83 [0.505]	4	5	104890-3
2	-	-	10.29 [0.405]	3	4	104890-2
3	-	-	15.37 [0.605]	5	6	104890-1
UNMARKED IN PROCESS P/N	UNMARKED IN PROCESS P/N	MARKING	B	A	NO. OF POSN	PART NUMBER

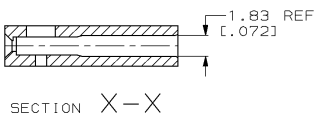

DO NOT SCALE PRINT. DIMENSIONS IN MILLIMETERS TOLERANCES ON +		DR 3-29-93 H. BAKERMANS		AMP INCORPORATED Harrisburg, Pa. 17105	
2 PLC DEC ± 0.13 [0.005]		CHK 5-10-93 P. SREMCICH	NAME		
ANGLES ± -		APPD 5-10-93 P. SREMCICH	HOUSING, MOD IV, SINGLE ROW, 2.54 [1.00] ⌀, CRIMP SNAP-IN		
MATERIAL	GLASS FILLED NYLON COLOR-BLACK	APPD 5-10-93 D. DUPLER	PRODUCT SPEC	FINISH	-
APPLICATION SPEC	-	SIZE C	FSCH NO 00779	DRAWING NO	104890
WEIGHT	-	SCALE	4:1	SHEET	1 OF 1