

## **Excellent Integrated System Limited**

Stocking Distributor

Click to view price, real time Inventory, Delivery & Lifecycle Information:

[TE Connectivity AMP Connectors](#)  
[647055-2](#)

For any questions, you can email us directly:

[sales@integrated-circuit.com](mailto:sales@integrated-circuit.com)

DRAWING MADE IN THIRD ANGLE PROJECTION

THIS DRAWING IS UNPUBLISHED. RELEASED FOR PUBLICATION  
© COPYRIGHT 19 BY AMP INCORPORATED. ALL INTERNATIONAL RIGHTS RESERVED.

REV	DATE	BY	ZONE	LTR	REVISIONS	DATE	APPD
CM	54				B RLSD #2 PER EC 0L30-0171-97	9-8-97	JH/RS

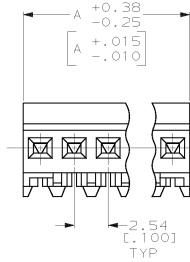
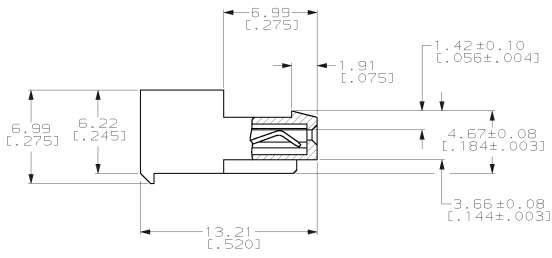
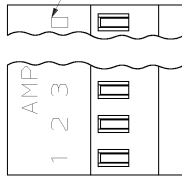

- △ MATERIAL: CONNECTOR - NYLON UL94V-2 (YELLOW).  
 CONTACTS - 0.30 [.012] THICK COPPER ALLOY  
 (BRIGHT-TIN 0.00203 [.000080] MIN THK)
- CONTACTS ACCEPT 26 AWG WIRE WITH 1.52 [.060] MAX INSULATION DIAMETER.
  - CONTACTS MUST ACCEPT 0.64±0.03 [.025±.001] SQUARE POST AND REMAIN LOCKED IN POSITION.
  - IDENTIFICATION NUMBER FOR LAST CIRCUIT MAY NOT APPEAR ON ALL ASSEMBLIES.
  - DIMENSIONS IN BRACKETS ARE IN INCHES.
  - HOUSING FEATURES ARE: CLOSED END WITH LOCKING RAMP.

DIM A	NO OF CIRCUITS	PART NO
15.24 [.600]	6	647055-6
10.16 [.400]	4	647055-4
5.08 [.200]	2	647055-2

DO NOT SCALE PRINT. UNLESS SPECIFIED DIMENSIONS IN mm [INCHES] TOLERANCES ON : 2 PLC DEC ± - 3 PLC DEC ± 0.13 (.005) ANGLES ± -		DR B. LEWIS 9-23-96 CHK R. SWING 9-23-96 APPD C. JONES 9-23-96 APPD C. JONES 9-23-96		<b>AMP</b> AMP Incorporated Harrisburg, PA 17105-3608	
MATERIAL △		PRODUCT SPEC 108-1050		NAME MTA-100 CONNECTOR ASSEMBLY, 26 AWG, SPECIAL	
FINISH △		APPLICATION SPEC 114-1019		SIZE C 00779	DRAWING NO 647055
WEIGHT -		SCALE 5:1	SHEET 1 OF 1		

**METRIC**

CUSTOMER DRAWING

T:\C\BUSINESS GROUP\333\177534\1105.DWG

AMP 1471-16 REV 0-99  
 08-SEP-97 14:43:05 amp18726 /hsw/amp18726/ac171-97