



Excellent Integrated System Limited

Stocking Distributor

Click to view price, real time Inventory, Delivery & Lifecycle Information:

[TE Connectivity AMP Connectors](#)
[63790-1](#)

For any questions, you can email us directly:

sales@integrated-circuit.com

4
DRAWING MADE IN THIRD ANGLE PROJECTION
THIS DRAWING IS UNPUBLISHED.
© COPYRIGHT 19 BY AMP INCORPORATED. ALL INTERNATIONAL RIGHTS RESERVED.

LOC		DIST		REV PER		DATE		APPRO	
P	F	ZONE	LTA	DESCRIPTION	DATE	APPRO	DATE	APPRO	
AF	50		B	REV PER 0L10-0054-96	11/13/96	JR/PD			

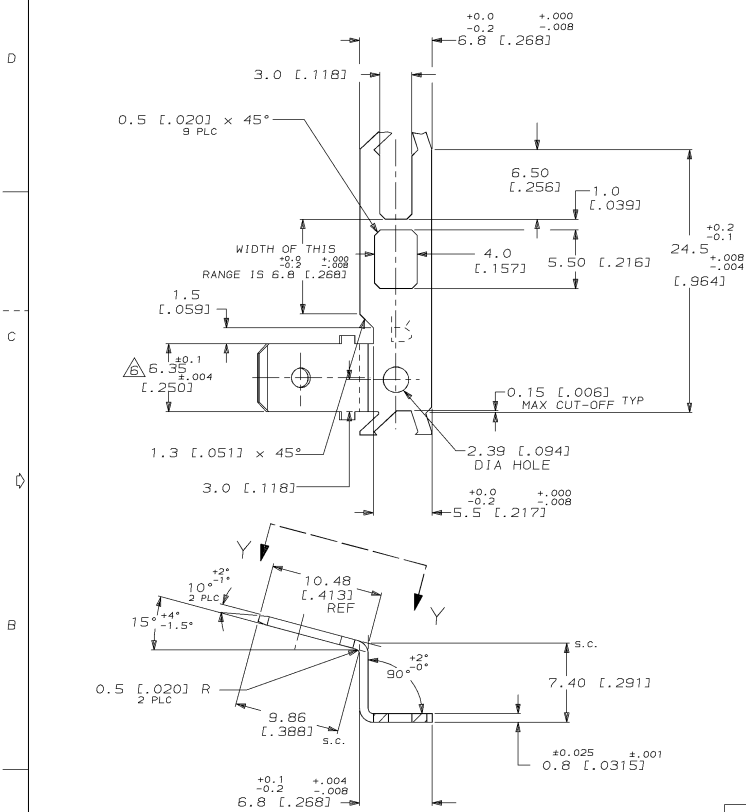

- 1 TIN PLATE 3um [0.00120] MIN OVER 1um [0.00040] MIN COPPER.
- 2 THE FLASH SHOULD BE LESS THAN 0.02mm [0.0008].
- 3 THE WARP SHOULD BE LESS THAN 0.2mm [0.008].
- 4 PLATED SURFACE SHOULD BE MATTE FINISH.
- 5 MASBAC P/N BLC26F00016.
- 6 6.35 DIMENSION MAY GROW A MAXIMUM OF 0.06 MM AT THE BEND.

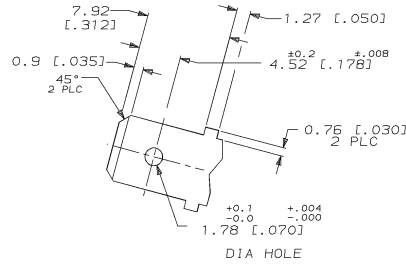

VIEW Y-Y

DO NOT SCALE PRINT. UNLESS SPECIFIED DIMENSIONS IN mm (INCHES) TOLERANCES ON : 2 PLC DEC ± 0.13 (0.005) 3 PLC DEC ± - ANGLES ± -		DR 6/6/94 JR RUTH CHK 6/6/94 MS FEHER APPD 6/6/94 P DESANTIS	63790-1 PART NO	
MATERIAL BRASS C2600 1/2H OR C2680 1/2H	FINISH △	APPD 6/6/94 R REINER PRODUCT SPEC -	AMP Incorporated Harrisburg, PA 17105-3608	
APPLICATION SPEC -		SIZE C	TAB, FASTON, 6.35 [0.250] SERIES RIGHT HAND	
WEIGHT -		SCALE 4:1	CAGE CODE 00779	DRAWING NO C=63790
			SHEET 1 OF 1	CUSTOMER DRAWING

THIS DRAWING IS A CONTROLLED DOCUMENT FOR AMP INCORPORATED. IT IS SUBJECT TO CHANGE AND THE CONTROLLING ENGINEERING ORGANIZATION SHOULD BE CONTACTED FOR THE LATEST REVISION.