



Distributor of TE Connectivity AMP Connectors: Excellent Integrated System Limited
Datasheet of 747020-1 - D-Sub Connector Receptacle, Female Sockets 9 Position Through
Hole, Right Angle Solder

Contact us: sales@integrated-circuit.com Website: www.integrated-circuit.com

Excellent Integrated System Limited

Stocking Distributor

Click to view price, real time Inventory, Delivery & Lifecycle Information:

[TE Connectivity AMP Connectors](#)
[747020-1](#)

For any questions, you can email us directly:

sales@integrated-circuit.com

MAKING MADE IN THIS AMERICAN PRODUCTION
 THIS DRAWING IS UNCLASSIFIED
 © COPYRIGHT 19 BY AMP INCORPORATED. ALL INTERNATIONAL RIGHTS RESERVED.

| REV | DATE | DESCRIPTION | BY | APPD |
|-----|---------------------------------------|-------------|----|------|
| D | REBRAM & OBS-3, -4 PER EC 0020-617-93 | | | CR |
| E | OBS -6 PER EC 0020-831-93 | | | SB |

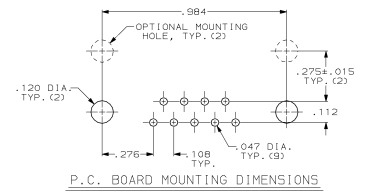
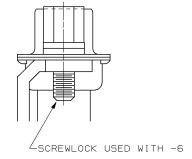
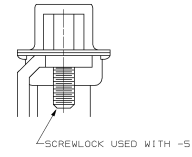
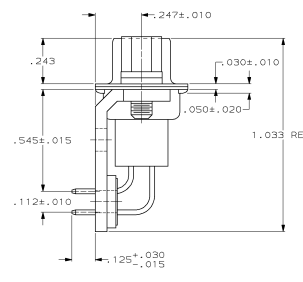
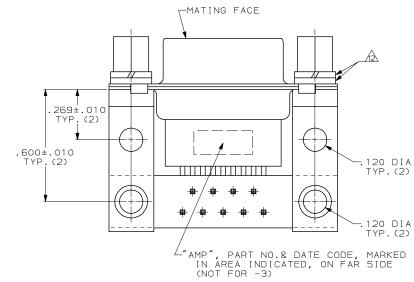
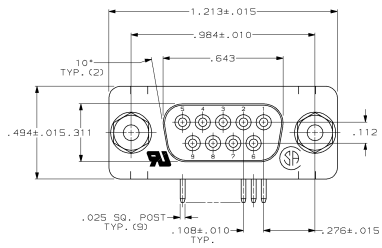

- CONNECTOR MATES WITH ANY 9 POS. PLUG IN AMPLIMITE SERIES & COMPLIES WITH AMP SPEC. 10B-40,005 WHERE APPLICABLE.
- FLAME RETARDANT 94V-0 RATED THERMOPLASTIC; COLOR: BLACK.
- STEEL PER ASTM A109.
- PHOS. BRONZE PER QQ-B-750.
- SCREWLOCKS; STEEL PER ASTM A109, WASHERS; STEEL PER ASTM A108.
- TIN PLATING PER MIL-T-10727, ZINC CLEAR CHROMATE PLATING PER ASTM B633; TYPE III, CLASS SC1, ZINC YELLOW CHROMATE PLATING PER ASTM B633; TYPE II, CLASS SC1, GOLD PLATING PER MIL-G-45204, NICKEL PLATING PER QQ-N-290.
- TIN PLATED.
- ZINC PLATED CLEAR CHROMATE.
- ZINC PLATED YELLOW CHROMATE.
- GOLD FLASH FOR A LENGTH OF .100 MINIMUM FROM MATING END, .000100 MINIMUM TIN-LEAD ON OPPOSITE END, BOTH OVER .000050 MINIMUM NICKEL.
- .000030 MINIMUM GOLD FOR A LENGTH OF .100 MINIMUM FROM MATING END, .000100 MINIMUM TIN-LEAD ON OPPOSITE END, BOTH OVER .000050 MINIMUM NICKEL.
- LOCK WASHERS ARE FOR -1, -2, -4 & -6, PLAIN WASHERS ARE FOR -1, -2 & -6.

| OBsolete | AMP | AMP | AMP | 747020-6 |
|----------|-----|-----|-----|----------|
| OBsolete | AMP | AMP | AMP | 747020-5 |
| OBsolete | AMP | AMP | AMP | 747020-4 |
| OBsolete | AMP | AMP | AMP | 747020-3 |
| OBsolete | AMP | AMP | AMP | 747020-2 |
| OBsolete | AMP | AMP | AMP | 747020-1 |

| | | |
|--|---|---|
| DO NOT SCALE PRINT. UNLESS SPECIFIED DIMENSIONS IN INCHES TOLERANCES ON 3 PLD DEC ± .005 ANGLES ± 2° UNLESS OTHERWISE SPECIFIED. SHELLS & BRACKETS, CONTACTS, INSULATORS, FINISH | OR 9-27-84 J. BRAMS CHK 9-27-84 J. SERVICE APPD 8-18-84 C. MARRIBES APPD 8-18-84 J. ASSINI PRODUCT SPEC - APPLICATION SPEC - SIZE - WEIGHT - | AMP Incorporated Harrisburg, PA 17105-3608 |
| NAME RECEPTACLE ASSEMBLY, SIZE 1, 9 POS., RIGHT ANGLE, .545 SERIES, .025 50. POSTS, W/ SCREWLOCKS, AMPLIMITE™ HDP | CASE CODE 00779 | DRAWING NO 747020 |
| SCALE NTS | SHEET 1 OF 1 | |