

Excellent Integrated System Limited

Stocking Distributor

Click to view price, real time Inventory, Delivery & Lifecycle Information:

[TE Connectivity AMP Connectors](#)
[555003-1](#)

For any questions, you can email us directly:

sales@integrated-circuit.com

THIS DRAWING IS UNCONTROLLED
 UNLESS INDICATED OTHERWISE
 ALL RIGHTS RESERVED

REV	DATE	REVISIONS
AA	22	REVISED
HT		ADDED -3 PER EC 0511-0048-03

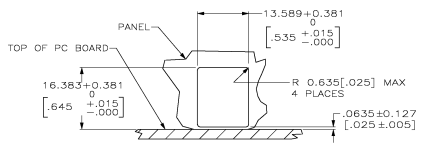
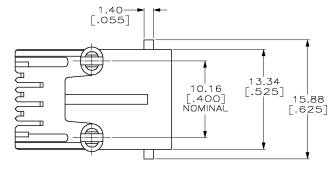
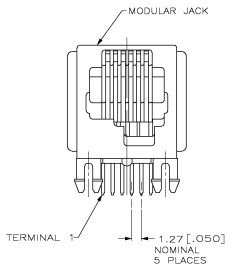
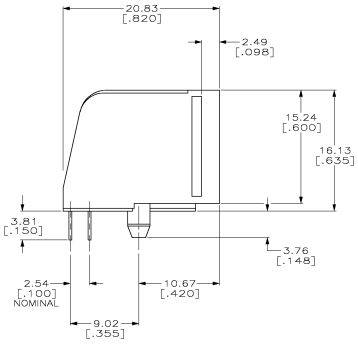

SUGGESTED PANEL CUTOUT
 SCALE 2:1

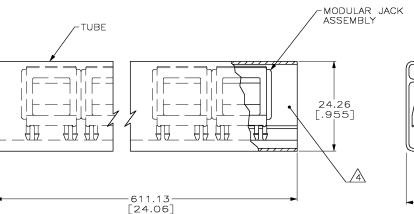

DETAIL B
 SCALE 2:1

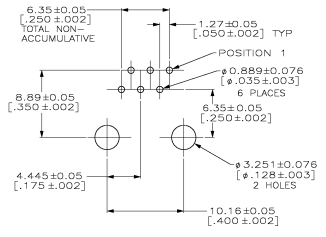

SUGGESTED PC BOARD LAYOUT
 CIRCUIT SIDE SHOWN

- ⚠ MATERIAL: HOUSING - PBT POLYESTER, SEE TABLE FOR COLOR.
- ⚠ TERMINAL - 0.35[0.138] THICK PHOS-BRONZE PLATED WITH 1.27µm[0.000050] THICK HARD GOLD IN LOCALIZED GOLD PLATE AREA AND 2.03µm[0.00080] THICK TIN-LEAD IN SOLDER AREA OVER 1.27µm[0.000050] THICK NICKEL UNDERPLATE.
- ⚠ ALL DIMENSIONS SHOWN ARE MAXIMUM UNLESS OTHERWISE SPECIFIED.
- ⚠ BULK PACKAGED IN A TRAY.
- ⚠ PACKAGED 36 ASSEMBLES PER TUBE WITH BOTH ENDS CLOSED. SEE DETAIL B.

PACKAGE	COLOR	TERMINALS	PART NUMBER
⚠	BLACK	6	555003-3
⚠	GRAY	6	555003-2
⚠	GRAY	6	555003-1

DATE	BY	CHKD	APP'D	REV	DESCRIPTION
10B-116.3				1	MODULAR JACK ASSEMBLY, SIDE ENTRY, WITH RIGHT HAND LATCH, 6 POSITION, FLANGELESS, WITH PANEL STOPS
114-2048				2	REVISED TO
				3	REVISED TO
				4	REVISED TO