

Excellent Integrated System Limited

Stocking Distributor

Click to view price, real time Inventory, Delivery & Lifecycle Information:

[TE Connectivity AMP Connectors](#)
[414414-1](#)

For any questions, you can email us directly:

sales@integrated-circuit.com

DRAWING MADE IN THIRD ANGLE PROJECTION

THIS DRAWING IS UNPUBLISHED. RELEASED FOR PUBLICATION. 19
 © COPYRIGHT 19 BY AMP INCORPORATED. ALL INTERNATIONAL RIGHTS RESERVED.

LOC	DIST	REVISIONS				
P	F	ZONE	LTR	DESCRIPTION	DATE	APPD
AJ	16			C OBS -2 PER 0U20-0072-01	16APR01	M0

- 1 PHOSPHOR BRONZE PER QQ-B-750
- 2 ZINC PER QQ-Z-363
- 3 POLYMETHYLPENTENE: GENERAL PURPOSE
- 4 NICKEL PLATE PER QQ-N-290, 3.81μm [.000150] MIN THICKNESS
- 5 GOLD PLATE PER MIL-G-45204, 0.38μm [.000015] MIN THICKNESS

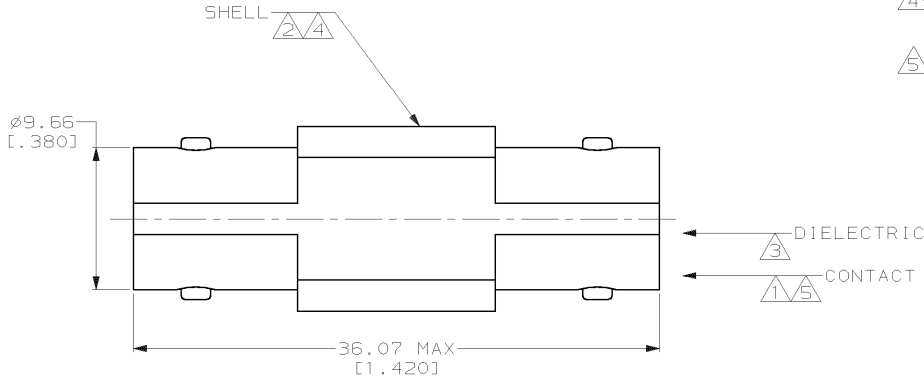

OBSELETE	414414-2
	414414-1
	PART NUMBER

DO NOT SCALE PRINT. UNLESS SPECIFIED DIMENSIONS IN mm (INCHES) TOLERANCES ON:		DR 9-8-92 M.E. COWHER	AMP AMP Incorporated Harrisburg, PA 17105-3608
1 PLC DEC ± 0.05 (±.002)		CHK 9-14-92 M. PHILLIPS	
2 PLC DEC ± 0.05 (±.002)		APPD 9-14-92 M. PHILLIPS	NAME
3 PLC DEC ± 0.05 (±.002)		APPD 9-14-92 M.E. COWHER	JACK ADAPTER ASSEMBLY, COML BNC
ANGLES ± -		PRODUCT SPEC	SIZE
FINISH		APPLICATION SPEC	CAGE CODE
MATERIAL		WEIGHT	DRAWING NO
1 2 3			B 00779 C-414414
4 5			SCALE
THIS DRAWING IS A CONTROLLED DOCUMENT FOR AMP INCORPORATED. IT IS SUBJECT TO CHANGE AND THE CONTROLLING ENGINEERING ORGANIZATION SHOULD BE CONTACTED FOR THE LATEST REVISION.			4:1
			SHEET
			1 OF 1