



**Distributor of Molex Connector Corporation: Excellent Integrated System Limited**  
Datasheet of 0357182110 - Connector Quick Connect Receptacle 16-20 AWG 0.187"  
(4.75mm) Crimp

Contact us: [sales@integrated-circuit.com](mailto:sales@integrated-circuit.com) Website: [www.integrated-circuit.com](http://www.integrated-circuit.com)

---

## **Excellent Integrated System Limited**

Stocking Distributor

Click to view price, real time Inventory, Delivery & Lifecycle Information:

[Molex Connector Corporation](#)  
[0357182110](#)

For any questions, you can email us directly:  
[sales@integrated-circuit.com](mailto:sales@integrated-circuit.com)

Contact us: sales@integrated-circuit.com Website: www.integrated-circuit.com

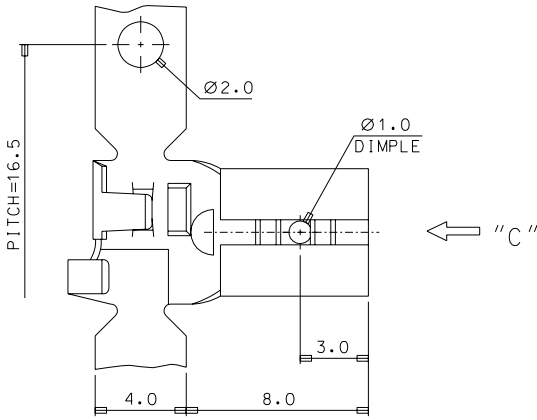

NOTES

1. MATERIAL : BRASS, 0.35mm THICKNESS
2. FINISH : 35718-2100 (UNPLATED)  
35718-2110 (POST PLATED TIN)
3. APPLICABLE WIRE RANGE : AWG #20 - #16

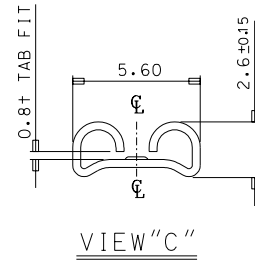
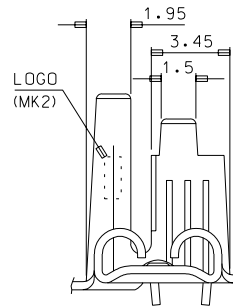
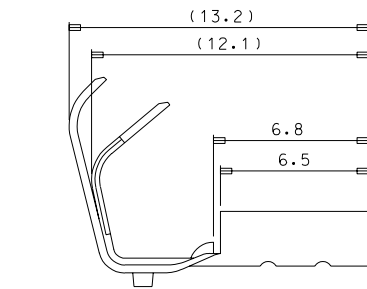

REDRAWN EC NO. KOR2004-0117 DRAWN: C.B.CHIN 04/02/12 CHK'S: W.Y. YANG APPR: C.W.LEE	QUALITY SYMBOLS MAJOR $\nabla$ = 0 CRITICAL $\sphericalangle$ = 0	GENERAL TOLERANCES: (UNLESS SPECIFIED)		SCALE 6:1	DESIGN UNITS <input checked="" type="checkbox"/> mm <input type="checkbox"/> INCH	THIRD ANGLE PROJECTION <input checked="" type="checkbox"/> THIRD ANGLE	DIMENSIONS: <input type="checkbox"/> mm <input type="checkbox"/> INCH <input checked="" type="checkbox"/> mm ONLY		SHT REV	
		4 PLACES $\pm 0.$ $\pm$	3 PLACES $\pm 0.$ $\pm$	2 PLACES $\pm 0.20$ $\pm$	1 PLACE $\pm 0.30$ $\pm$	DRAWN BY & DATE C.B.CHIN 04/02/12		TITLE: .187 FLAG RECEPTACE TERMINAL (0.8+ TAB)		
		ANGULAR: $\pm 1^\circ$				CHECKED BY & DATE W.Y. YANG 04/02/12		MOLEX INCORPORATED		
		DRAFT WHERE APPLICABLE MUST REMAIN WITHIN DIMENSIONS				APPROVED BY & DATE C.W.LEE 04/02/12		CAD FILENAME S7182110.DGN		MATERIAL NO. SEE NOTES
REV A				THIS DRAWING CONTAINS INFORMATION THAT IS PROPRIETARY TO MOLEX INCORPORATED AND SHOULD NOT BE USED WITHOUT WRITTEN PERMISSION.						SIZE B

DO NOT SCALE DRAWING DIMENSION IN METRIC

PROJECT NO. SD-35718-210  
SIMILAR ITEM  
C  
B

F  
E  
D  
C  
B  
A