

Excellent Integrated System Limited

Stocking Distributor

Click to view price, real time Inventory, Delivery & Lifecycle Information:

[Molex Connector Corporation](#)
[0476500001](#)

For any questions, you can email us directly:
sales@integrated-circuit.com

10 9 8 7 6 5 4 3 2 1

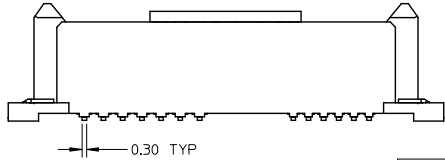
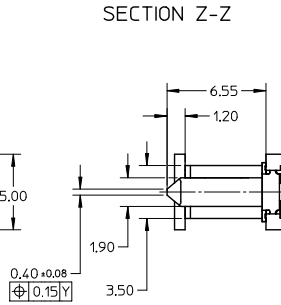
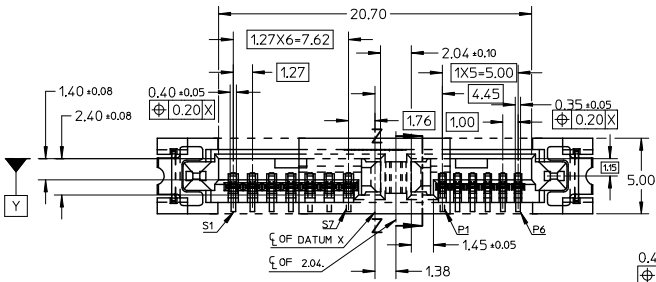
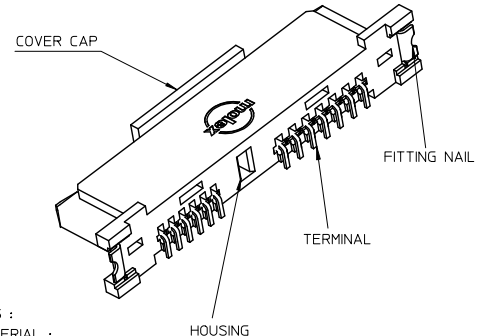
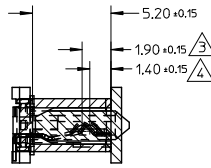
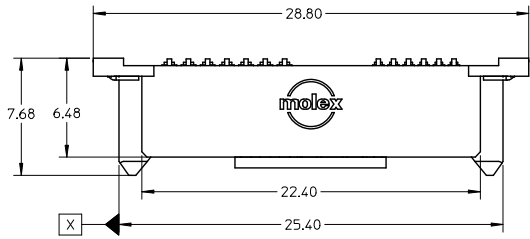

NOTES :

- MATERIAL :**
HOUSING : HIGH TEMPERATURE THERMOPLASTIC, UL94V-0, 30% G.F., BLACK.
TERMINAL : COPPER ALLOY
FITTING NAIL : COPPER ALLOY
COVER CAP:HIGH TEMPERATURE THERMOPLASTIC, UL94V-0, 30% G.F., BLACK.
 - PLATING :**
TERMINAL :
CONTACT AREA :SEE TABLE.
SOLDER AREA : TIN PLATING.
UNDERPLATING : NICKEL PLATING.
FITTING NAIL :
TIN PLATING 10 MICRONS MIN. OVER NICKEL PLATING 10 MICRONS MIN.
- \triangle FOR P1 PIN ONLY.
 \triangle FOR ALL OTHER PINS.
 5. PRODUCT SPECIFICATION:PER PS-47650-001.
 6. PRODUCT PACKAGE:PER PK-47650-001.
 7. TERMINAL AND NAIL COPLANARITY TO BE 0.15MAX.
 7. THE PRODUCT COMPLIANT TO RoHS DIRECTIVE 2002/95/EC AND 2000/53/EC.

TABLE

P/N	CONTACT AREA PLATING
47650-0001	0.1 MICRON MIN. GOLD
47650-0002	0.38 MICRON MIN. GOLD

UPDATE DRAWING EC NO: SH2009-0756 DRWN: X.SONG CHK: X.SONG APPR: H.WANG	QUALITY SYMBOLS $\nabla=0$ $\nabla=0$	GENERAL TOLERANCES (UNLESS SPECIFIED)		DIMENSION STYLE MM ONLY		SCALE 4:1	DESIGN UNITS METRIC	THIRD ANGLE PROJECTION
		4 PLACES ± --- ± --- 3 PLACES ± --- ± --- 2 PLACES ± 0.15 ± --- 1 PLACE ± 0.20 ± --- ANGULAR ± 2°	DRAWN BY L.SONG CHECKED BY J.TIAN APPROVED BY H.WANG	DATE 2008-2-16 DATE 2008-2-16 DATE 2008-2-16	TITLE SLIMLINE SATA RECEPTACLE CONNECTOR			
DRAFT WHERE APPLICABLE MUST REMAIN WITHIN DIMENSIONS	MATERIAL NO. SEE TABLE	DOCUMENT NO. SD-47650-001	MOLEX INCORPORATED			SHEET NO. 1 OF 2		

9 8 7 6 5 4 3 2 1

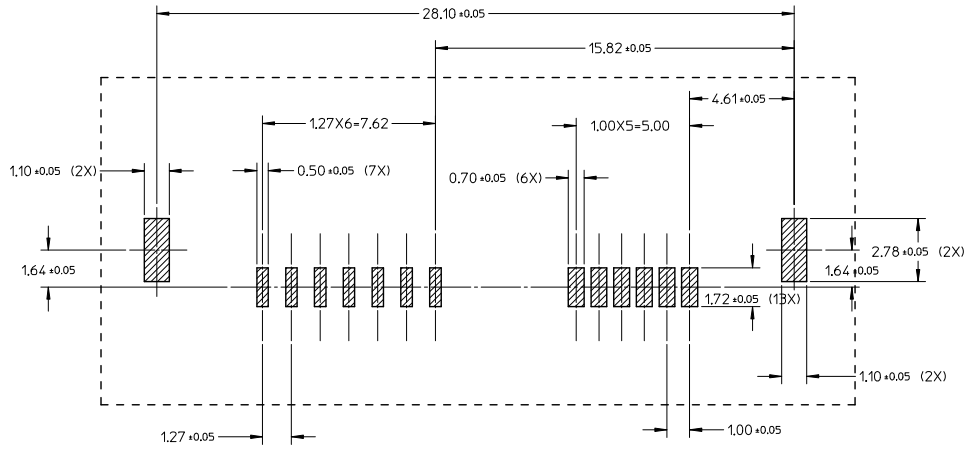

RECOMMENDED PCB LAYOUT DIMENSION

SEE SHEET 1 EC NO: SH2009-0756 DRAWN BY: LSONG CHKD BY: JSONG APPR: HWANG 2009/06/01 2009/06/02 2009/06/30	QUALITY SYMBOLS	GENERAL TOLERANCES (UNLESS SPECIFIED)		DIMENSION STYLE		SCALE	DESIGN UNITS	THIRD ANGLE PROJECTION
	▽=0	mm	INCH	MM ONLY		6:1	METRIC	☉
	▽=0	4 PLACES ± ---	± ---	DRAWN BY	DATE	TITLE		
		3 PLACES ± ---	± ---	LSONG	2008-2-16	SLIMLINE SATA RECEPTACLE CONNECTOR		
	2 PLACES ± 0.15	± ---	CHECKED BY	DATE	MATERIAL NO.			
	1 PLACE ± 0.20	± ---	JTIAN	2008-2-16	MOLEX INCORPORATED			
	ANGULAR ± 2 °		APPROVED BY	DATE	DOCUMENT NO.			
			HWANG	2008-2-16	SD-47650-001			
			DRAFT WHERE APPLICABLE MUST REMAIN WITHIN DIMENSIONS		SEE SHEET 1		SHEET NO.	
					SIZE: A3		2 OF 2	
			THIS DRAWING CONTAINS INFORMATION THAT IS PROPRIETARY TO MOLEX INCORPORATED AND SHOULD NOT BE USED WITHOUT WRITTEN PERMISSION					