

## Excellent Integrated System Limited

Stocking Distributor

Click to view price, real time Inventory, Delivery & Lifecycle Information:

[Molex Connector Corporation](#)

[0986581213](#)

For any questions, you can email us directly:

[sales@integrated-circuit.com](mailto:sales@integrated-circuit.com)

20 19 18 17 16 15 14 13 12 11 10 9 8 7 6 5 4 3 2 1

FORME ADMISE  
ALLOWED VERSION

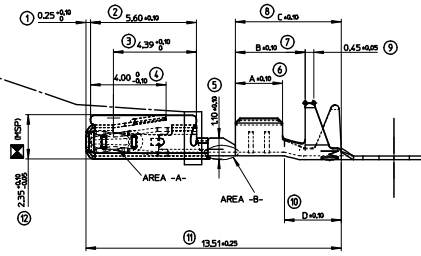

MOLEX REFERENCE	AREA -A- ( GAP AREA )	AREA -B-	CRIMPING AREA	Wire size range	Longueur Length	Serrisage Conductor Wire Crimp	Serrisage Isolation Insulation Crimp	Poids Weight
TIN PLATED VERSION 0986581211			HOT TIN DIP Sn = 1.0 to 3.0 Hk	0.22 to 0.60 mm <sup>2</sup>		A-2.50 E-190 F-2.40 Rc-0.50	G-2.90 H-2.80 Ri-0.80	0.1600 g
GOLD PLATED VERSION 0986581221	Au= 0.4 Hk MIN. Ni= 1.0 Hk MIN.		Sn = 1.0 to 5.0 Hk MIN. Ni = 1.0 Hk MIN.					
GOLD PLATED VERSION 0986581231	Au= 0.4 Hk MIN. Ni= 1.0 Hk MIN.	Au= 0.4 Hk MIN. Ni= 1.0 Hk MIN.	Sn = 1.0 to 5.0 Hk MIN. Ni = 1.0 Hk MIN.					
TIN PLATED VERSION 0986581212			HOT TIN DIP Sn = 1.0 to 3.0 Hk	0.75 mm <sup>2</sup>		A-2.80 E-2.25 F-2.25 Rc-0.50	G-2.90 H-2.80 Ri-0.80	
GOLD PLATED VERSION 0986581222	Au= 0.4 Hk MIN. Ni= 1.0 Hk MIN.		Sn = 1.0 to 5.0 Hk MIN. Ni = 1.0 Hk MIN.					
GOLD PLATED VERSION 0986581232	Au= 0.4 Hk MIN. Ni= 1.0 Hk MIN.	Au= 0.4 Hk MIN. Ni= 1.0 Hk MIN.	Sn = 1.0 to 5.0 Hk MIN. Ni = 1.0 Hk MIN.					
TIN PLATED VERSION 0986581213			HOT TIN DIP Sn = 1.0 to 3.0 Hk	0.22 to 0.50 mm <sup>2</sup>		A-2.50 E-180 F-180 Rc-0.40	G-2.30 H-2.30 Ri-0.70	
GOLD PLATED VERSION 0986581223	Au= 0.4 Hk MIN. Ni= 1.0 Hk MIN.		Sn = 1.0 to 5.0 Hk MIN. Ni = 1.0 Hk MIN.					
GOLD PLATED VERSION 0986581233	Au= 0.4 Hk MIN. Ni= 1.0 Hk MIN.	Au= 0.4 Hk MIN. Ni= 1.0 Hk MIN.	Sn = 1.0 to 5.0 Hk MIN. Ni = 1.0 Hk MIN.					

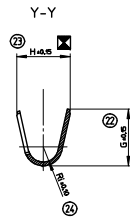
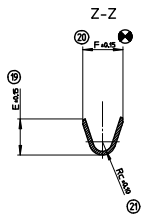
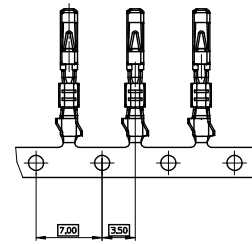
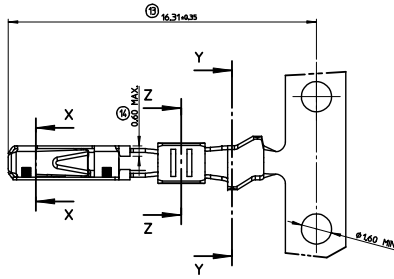
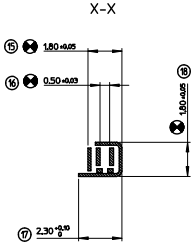

**NOTE:**

- MATERIAL: CONTACT BODY: HIGH CONDUCTIVE COPPER ALLOY.  
SLEEVE: STAINLESS STEEL.
- PACKAGING SPECIFICATION: PK-98658-006.
- CRIMPING PARAMETERS AND CRIMPING TOOL DEFINITION: SEE CS-98658-001.

INDICATION DIMENSIONS S.P.C DENOTES S.P.C DIMENSIONS  
 INDICATION DIMENSIONS DETERMINANT LES CAPABILITES MACHINE DENOTES DIMENSIONS DETERMINANT LES MACHINES ABILITIES  
 INDICATION DIMENSIONS FONCTIONNELLES DENOTES FUNCTIONAL DIMENSIONS  
 QUANTITE PAR FEUILLE INDIVIDUELLE QUANTITY PER INDIVIDUAL SHEET  
 ✖ = 2    ● = 4    ○ = 0

REVISION LOCATION SLEVE FINISHED REC NO. 0204-0357 2014/03/07 CHK'D BY DRINKWATER/PLESSIS 2014/03/07 APPR'D BY CHIKOMANDRE 2014/03/07 DESIGNED BY CHIKOMANDRE 2014/03/07	GENERAL TOLERANCES (UNLESS SPECIFIED) mm INCH 4 PLACES ±--- ±--- 3 PLACES ±--- ±--- 2 PLACES ±.0 ±--- 1 PLACE ±.0 ±--- 0 PLACE ±.0 ±		DIMENSION STYLE MM ONLY DRAWN BY JTAMSON 1993/06/01 CHECKED BY DATE MANDRE 1999/10/14 APPROVED BY DATE BOUCHAN 1999/10/14		SCALE 10:1 DESIGN UNITS METRIC FIRST ANGLE PROJECTION
	MATERIAL NO. ANGULAR ±1/2° DRAFT WHERE APPLICABLE MUST REMAIN WITHIN DIMENSIONS		SEE CHART THIS DRAWING CONTAINS INFORMATION THAT IS PROPRIETARY TO MOLEX INCORPORATED AND SHOULD NOT BE USED WITHOUT WRITTEN PERMISSION		TITLE MOX 0.63 TERMINAL RECEPTACLE TERMINAL GENERIC CONTROL DRAWING <b>molex</b> DOCUMENT NO. SD-98658-004 SHEET NO. 1 OF 1

19 18 17 16 15 14 13 12 11 10 9 8 7 6 5 4 3 2 1