

Excellent Integrated System Limited

Stocking Distributor

Click to view price, real time Inventory, Delivery & Lifecycle Information:

[Molex Connector Corporation](#)
[0003066062](#)

For any questions, you can email us directly:

sales@integrated-circuit.com

RECEPTACLE

PLUG

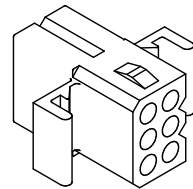
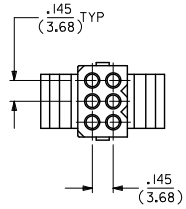
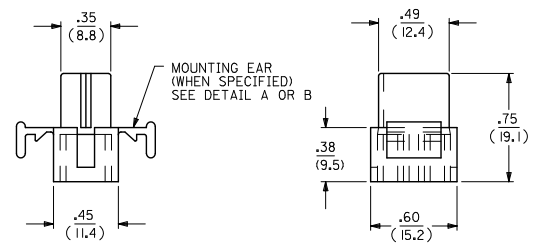
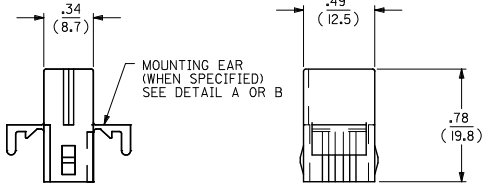
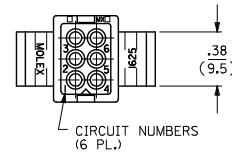
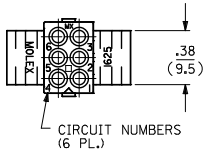

SHOWN WITH STANDARD EAR

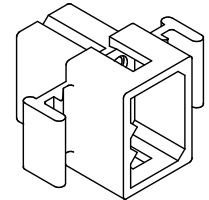
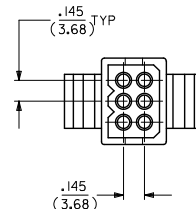

SHOWN WITH STANDARD EAR

UPDATE REV. LEVEL EC NO: UCP2072-2714 DRAWN BY: ZHANGHAG CHKD: BELL APPR: SMITH DATE: 2017/04/09 DATE: 2017/04/09 DATE: 2017/04/25	QUALITY SYMBOLS ▽=0 ▽=0	GENERAL TOLERANCES (UNLESS SPECIFIED)		DIMENSION STYLE IN/MM	SCALE ---	DESIGN UNITS INCH	THIRD ANGLE PROJECTION
		4 PLACES ± --- ± ---	DRAWN BY: KBW DATE: 7/22/88	TITLE: .062/(157) HOUSING PLUG & RECEPTACLE 6 CKT, .145/(3.68) C.L.			
		3 PLACES ± --- ± .010	CHECKED BY: RW DATE: 7/22/88	MOLEX INCORPORATED			
		2 PLACES ± 0.25 ± .014 1 PLACE ± 0.35 ± --- ANGULAR ± 1/2°	APPROVED BY: RAS DATE: 7/22/88	MATERIAL NO. SEE CHART DOCUMENT NO. SD-1625-6*	SHEET NO. 1 OF 2		
DRAFT WHERE APPLICABLE MUST REMAIN WITHIN DIMENSIONS		THIS DRAWING CONTAINS INFORMATION THAT IS PROPRIETARY TO MOLEX INCORPORATED AND SHOULD NOT BE USED WITHOUT WRITTEN PERMISSION					

PLUG		
ORDER NO	ENG NO	
03-06-2062	I625-6P	
03-06-2061	I625-6PI	
03-06-7062	I625-6PBK	
03-06-7061	I625-6PIBK	
03-06-7063	I625-6POR	OBSOLETE
-	-	

RECEPTACLE		
ORDER NO	ENG NO	
03-06-1061	I625-6R	
03-06-1062	I625-6RI	
03-06-6061	I625-6RBK	
03-06-6062	I625-6RIBK	
03-06-6063	I625-6ROR	OBSOLETE
03-06-6064	I625-6RBU	
NOT TOOLED	I625-6R2	

LEGEND:
1625-6****

CIRCUIT SIZE
P = PLUG
R = RECEPTACLE

BLANK = WITH STANDARD EARS
1 = WITHOUT EARS
2 = WITH PREBENT EARS

COLOR:
BLANK = NATURAL COLOR
AM = AMBER BK = BLACK BU = BLUE
BN = BROWN GY = GRAY GN = GREEN
OR = ORANGE RD = RED YW = YELLOW

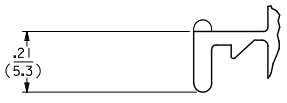

DETAIL A
.062/(1.57) STANDARD MOUNTING EAR
(SCALE 4:1)

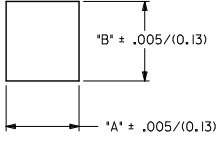
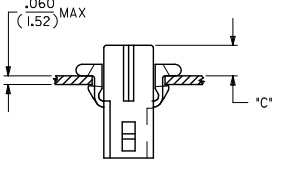

HOUSING	DIM. 'A'	DIM. 'B'	'C' PREBENT EAR	'C' STANDARD EAR
PLUG	.607/(15.42)	.615/(15.62)	.22/(5.6)	.18/(4.6)
RECEPT.	.505/(12.83)	.552/(14.02)	.23/(5.8)	.19/(4.8)

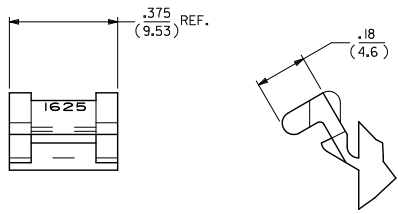

DETAIL B
.062/(1.57) PREBENT MOUNTING EAR
(SCALE 4:1)

- NOTES:-
1. MATERIAL NYLON TYPE 6/6, 94-2.
2. FINISH: NONE.
3. PRODUCT SPECS: MOLEX PRODUCT SPECS 02-06 APPLIES.
4. PACKAGING SPECS: BULK PACK PER PK-1625-003.

REVISE PKG NOTE #4 EC NO: UCP2072-2714 DRWING: HMG 2017/04/09 CHKD: JELL 2017/04/09 APPR: SMTH 2017/04/25 J2 REV	QUALITY SYMBOLS ▽=0 ▽=0	GENERAL TOLERANCES (UNLESS SPECIFIED)		DIMENSION STYLE IN/MM		SCALE ---	DESIGN UNITS INCH	THIRD ANGLE PROJECTION
		4 PLACES ± --- ± ---	DRAWN BY KBW DATE 7/22/88	TITLE .062 / (1.57) HOUSINGS PLUG & RECEPTACLE 6 CKT., 145/(3.683) C.L.				
		3 PLACES ± --- ± .010	CHECKED BY RW DATE 7/22/88	MOLEX MOLEX INCORPORATED				
		2 PLACES ± 0.25 ± .014 1 PLACE ± 0.35 ± --- ANGULAR ± 1/2°	APPROVED BY RAS DATE 7/22/88	MATERIAL NO. SEE CHART	DOCUMENT NO. SD-1625-6*	SHEET NO. 2 OF 2		
DRAFT WHERE APPLICABLE MUST REMAIN WITHIN DIMENSIONS		THIS DRAWING CONTAINS INFORMATION THAT IS PROPRIETARY TO MOLEX INCORPORATED AND SHOULD NOT BE USED WITHOUT WRITTEN PERMISSION						