

Excellent Integrated System Limited

Stocking Distributor

Click to view price, real time Inventory, Delivery & Lifecycle Information:

[Molex Connector Corporation](#)
[0009508090](#)

For any questions, you can email us directly:

sales@integrated-circuit.com

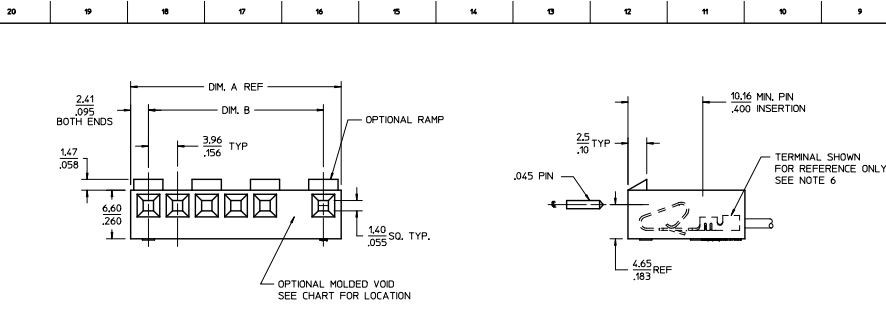

- NOTES:
1. MATERIAL: N - GLASS FILLED POLYESTER, UL94V-0, MOLDED NATURAL
 2. FINISH: SEE TERMINAL DRAWINGS
 3. PRODUCT SPECIFICATION: PS-08-50, PS-40-02, AND PS-45570-001
 4. PACKAGING INFORMATION: SEE LEGEND
 5. MATES WITH (3.96)/.156 CENTER HEADERS AND (1.14)/.045 SQUARE OR ROUND PINS
 6. HOUSING ACCEPTS STANDARD TERMINAL NOS.:
2478 (18-24 AWG) WITH (2.79)/.110 MAX. INSULATION DIA.
2578 (22-26 AWG) WITH (1.65)/.065 MAX. INSULATION DIA.
OR TRIFURCON TERMINAL NOS.:
6838 (18-24 AWG) WITH (2.79)/.110 MAX. INSULATION DIA.
7258 (22-26 AWG) WITH (1.65)/.065 MAX. INSULATION DIA.
OR MARK: TERMINAL NO.
45570 (18-20 AWG) WITH (3.12)/.123 MAX. INSULATION DIA.
 7. BOW (0.06 MM MAX) / .006 IN MAX.
 8. (0.13)/.005 MAX. FLASH ALLOWED ALONG DIMENSION B AND IN LOCKING WINDOW.
 9. THIS PART CONFORMS TO CLASS B REQUIREMENTS OF COSMETIC SPECIFICATION PS-45499-002.
 10. ALL 7-14 CIRCUIT PARTS AND 2-6 CIRCUIT PARTS MANUFACTURED BEFORE 9/21/2013 HAVE GEOMETRY ON THIS SHEET. SEE SHEET 2 FOR 2-6 CIRCUIT PARTS MANUFACTURED AFTER 9/21/2013.

NO. OF CKTS	DIM. A	DIM. B
2	(8.79) (.346)	(3.96) (.156)
3	(12.75) (.502)	(7.92) (.312)
4	(16.71) (.658)	(11.89) (.468)
5	(20.67) (.814)	(15.86) (.625)
6	(24.64) (.970)	(19.81) (.780)
7	(28.60) (.1128)	(23.77) (.938)
8	(32.56) (.128)	(27.74) (.108)
9	(36.53) (.1438)	(31.70) (.1248)
10	(40.49) (.1594)	(35.66) (.1404)
11	(44.45) (.1750)	(39.62) (.1560)
12	(48.41) (.1906)	(43.59) (.1716)
13	(52.37) (.2062)	(47.55) (.1872)
14	(56.34) (.2218)	(51.51) (.2028)

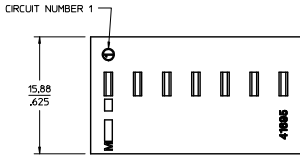

OPTION CODE D

RAMP WITH POLARIZING RIBS

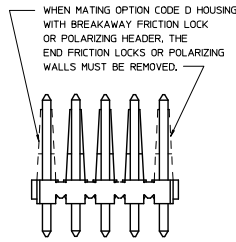
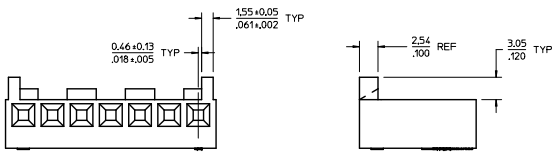

CODE	RAMP	POLARIZING RIBS	PACKAGING
A	NO	NO	BULK PER PK-41695-001
B	YES	NO	BULK PER PK-41695-001
D	YES	YES	BULK PER PK-41695-001

41695 - * - * N - ##
MATERIAL CODE
N = MOLDED NATURAL

VOID CODE
BLANK-NO VOIDS
NO-NO, CORRESPONDS TO CKT. NO. VOIDED
MULT. VOIDS-START WITH 51
NO. OF CKTS.

LOREXIT ENGRAVING EC NO. LEP27015-04-20 KZ DOWNLOAD: 20/07/19 CHROMIUM PER: 28/07/19 APPROVAL: 28/07/19 DATE: 28/07/19	QUALITY SYMBOLS ∇=0 ∇=0 ∇=0	GENERAL TOLERANCES (UNLESS SPECIFIED) mm INCH 4 PLACES ± .13 ± .005 3 PLACES ± .13 ± .005 2 PLACES ± .25 ± .010 1 PLACE ± .25 ± .010 0 PLACE ± .25 ± .010	DIMENSION STYLE MM ONLY DRAWN BY: MK HPPER DATE: 2012/10/25 CHECKED BY: BANDERSON DATE: 2012/10/26 APPROVED BY: FSMITH DATE: 2013/10/04	SCALE: 4:1 DESIGN UNITS: METRIC THIRD ANGLE PROJECTION	TITLE: KK (3.96)/.156 CRIMP TERMINAL HOUSING molex DOCUMENT NO. SD-41695 SHEET NO. 1 OF 2
	DRAFT WHERE APPLICABLE SEE CHART SIZE D THIS DRAWING CONTAINS INFORMATION THAT IS PROPRIETARY TO MOLEX INCORPORATED AND SHOULD NOT BE USED WITHOUT WRITTEN PERMISSION				
	WHEN MATING WITH BREAKAWAY HEADERS THE FRICTION LOCK WALL MUST BE REMOVED				
	R:\frame_01.ppt - Akt.1 Rev. 5 2009/07/11				

OPTION CODE A

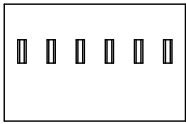
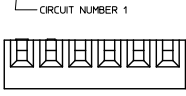
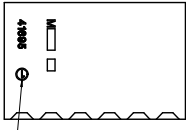

OPTION CODE B

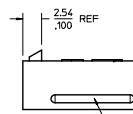
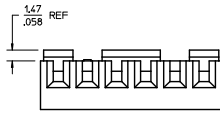

GROOVE MAY BE PRESENT (BOTH SIDES)



GROOVE MAY BE PRESENT (BOTH SIDES)

OPTION CODE D

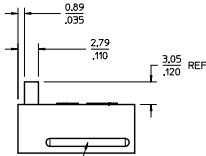
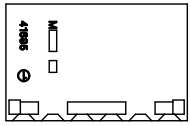

GROOVE MAY BE PRESENT (BOTH SIDES)

41695-N-AN**			
PART NO.	ENG. NO.	NOT AVAILABLE	VOIDS
09-50-8020	41695-N-A2		
09-50-8030	41695-N-A3		
09-50-8040	41695-N-A4		
09-50-8050	41695-N-A5		
09-50-8060	41695-N-A6		
09-50-8070	41695-N-A7		
09-50-8080	41695-N-A8		
09-50-8090	41695-N-A9		
09-50-8100	41695-N-A10		
09-50-8110	41695-N-A11		
09-50-8120	41695-N-A12		
09-50-9085	41695-N-A8-2	2	
41695-0001	41695-N-A6-3	3	
41695-0002	41695-N-A5-4	4	

41695-N-BN**			
PART NO.	ENG. NO.	NOT AVAILABLE	VOIDS
09-50-8021	41695-N-B2		
09-50-8031	41695-N-B3		
09-50-8041	41695-N-B4		
09-50-8051	41695-N-B5		
09-50-8061	41695-N-B6		
09-50-8071	41695-N-B7		
09-50-8081	41695-N-B8		
09-50-8091	41695-N-B9		
09-50-8101	41695-N-B10		
09-50-8111	41695-N-B11		
09-50-8121	41695-N-B12		
09-50-8131	41695-N-B13		
09-50-8141	41695-N-B14		
09-50-9030	41695-N-B3-2	2	
	41695-N-B4-2	2	
	41695-N-B5-2	2	
	41695-N-B6-2	2	
	41695-N-B7-2	2	
	41695-N-B8-2	2	
	41695-N-B9-2	2	
	41695-N-B10-2	2	
09-50-9121	41695-N-B12-2	2	
	41695-N-B14-2	2	
09-50-9060	41695-N-B6-5	5	
09-50-9070	41695-N-B7-6	6	
09-50-9071	41695-N-B7-2	2	
09-50-9040	41695-N-B4-3	3	
09-50-9090	41695-N-B9-7	7	
	41695-N-B14-13	13	
09-50-9136	41695-N-B15-5	5	
09-50-9137	41695-N-B13-8	8	
09-50-9050	41695-N-B5-51	2,4	
09-50-9061	41695-N-B6-3	3	
09-50-9080	41695-N-B8-2	2	
41695-0005	41695-N-B7-3	3	
41695-0006	41695-N-B14-51	5,9	

41695-N-DN**			
PART NO.	ENG. NO.	NOT AVAILABLE	VOIDS
09-50-8023	41695-N-D2		
09-50-8033	41695-N-D3		
09-50-8043	41695-N-D4		
09-50-8053	41695-N-D5		
09-50-8063	41695-N-D6		
09-50-8073	41695-N-D7		
09-50-8083	41695-N-D8		
09-50-8093	41695-N-D9		
09-50-8103	41695-N-D10		
09-50-8113	41695-N-D11		
09-50-8123	41695-N-D12		
09-50-8133	41695-N-D13		
09-50-8143	41695-N-D14		
09-50-9053	41695-N-D5-2	2	
09-50-9094	41695-N-D9-2	2	
09-50-9033	41695-N-D3-2	2	
09-50-9043	41695-N-D4-2	2	
09-50-9063	41695-N-D6-2	2	
09-50-9073	41695-N-D7-2	2	
09-50-9044	41695-N-D4-3	3	
41695-0003	41695-N-D07-5	5	

NOTES:
1. 2-6. CIRCUIT PARTS MANUFACTURED AFTER 9/21/2013
HAVE GEOMETRY ON THIS SHEET. SEE SHEET 1
FOR 7-14. CIRCUIT PARTS AND 2-4. CIRCUIT PARTS
MANUFACTURED PRIOR TO 9/21/2013.

SEE SHEET 1 EC NO. 0009508090-04-30 DRAWN BY: MK IPPER 20/10/13 CHECKED BY: BANDERSON 20/10/13 APPROVED BY: FSMITH 20/10/13 DESIGNED BY: KZ	QUALITY SYMBOLS ∇=0 ∇=0 ∇=0	GENERAL TOLERANCES (UNLESS SPECIFIED) 4 PLACES ±.005 3 PLACES ±.010 2 PLACES ±.015 1 PLACE ±.025 0 PLACES ±.050 ANGULAR ±1/2° DRAFT WHERE APPLICABLE MUST REMAIN WITHIN DIMENSIONS	DIMENSION STYLE MM ONLY DRAWN BY: MK IPPER 20/10/13 CHECKED BY: BANDERSON 20/10/13 APPROVED BY: FSMITH 20/10/13 MATERIAL NO. SEE CHART THIS DRAWING CONTAINS INFORMATION THAT IS PROPRIETARY TO MOLEX INCORPORATED AND SHOULD NOT BE USED WITHOUT WRITTEN PERMISSION	SCALE: 4:1 DESIGN UNITS: METRIC THIRD ANGLE PROJECTION TITLE: KK (3.96)/156 CRIMP TERMINAL HOUSING DOCUMENT NO.: SD-41695 SHEET NO.: 2 OF 2
--	--------------------------------------	---	---	--