



Distributor of Molex Connector Corporation: Excellent Integrated System Limited
Datasheet of 0010101023 - Connector Receptacle 2 Position 0.200" (5.08mm) Tin Through Hole

Contact us: sales@integrated-circuit.com Website: www.integrated-circuit.com

Excellent Integrated System Limited

Stocking Distributor

Click to view price, real time Inventory, Delivery & Lifecycle Information:

[Molex Connector Corporation](#)
[0010101023](#)

For any questions, you can email us directly:
sales@integrated-circuit.com

Contact us: sales@integrated-circuit.com Website: www.integrated-circuit.com

CIRCUIT 1
SEE NOTE 8

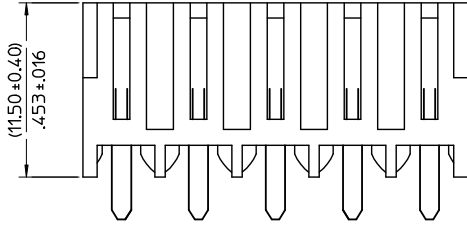
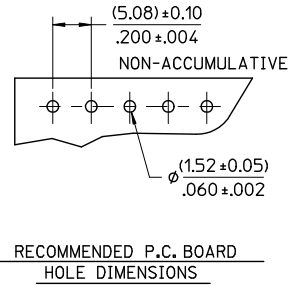
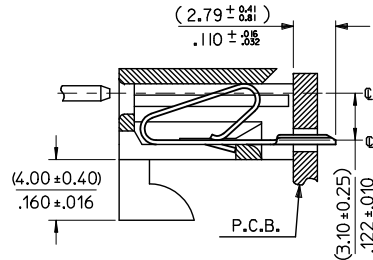
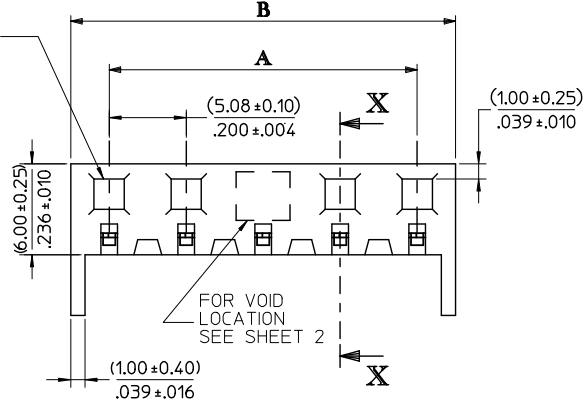

OPTIONAL CORE

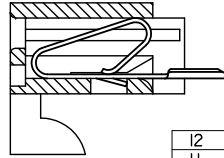

No of CIRCUITS	PART No.	ENG. No.	ENGLISH		METRIC	
			A	B	A	B
12	10-10-1123	AE-3002-12C	2.200 ± .010	2.400 ^{+0.008} _{-0.006}	55.88 ± .25	60.96 ± .2
11	-1113	-11C	2.000 ± .008	2.200 ^{+0.008} _{-0.006}	50.80 ± .20	55.88 ± .2
10	-1103	-10C	1.800 ± .008	2.000 ^{+0.008} _{-0.006}	45.72 ± .20	50.80 ± .2
9	-1093	-9C	1.600 ± .008	1.800 ^{+0.008} _{-0.006}	40.64 ± .20	45.72 ± .2
8	-1083	-8C	1.400 ± .008	1.600 ^{+0.008} _{-0.006}	35.56 ± .20	40.64 ± .2
7	-1073	-7C	1.200 ± .008	1.400 ^{+0.008} _{-0.006}	30.48 ± .20	35.56 ± .2
6	-1063	-6C	1.000 ± .004	1.200 ^{+0.008} _{-0.006}	25.40 ± .10	30.48 ± .15
5	-1053	-5C	.800 ± .004	1.000 ^{+0.008} _{-0.006}	20.32 ± .10	25.40 ± .15
4	-1043	-4C	.600 ± .004	.800 ^{+0.008} _{-0.006}	15.24 ± .10	20.32 ± .15
3	-1033	-3C	.400 ± .004	.600 ^{+0.008} _{-0.006}	10.16 ± .10	15.24 ± .15
2	10-10-1023	AE-3002-2C	.200 ± .004	.400 ^{+0.008} _{-0.006}	5.08 ± .10	10.16 ± .15

- NOTES:
 1. HOUSING : NYLON, UL94V-2, COLOR: NATURAL
 TERMINAL : PHOSPHOR BRONZE
 2. FINISH: HOT TIN DIP, (0.00254)/.000100 MIN
 3. PRODUCT SPECIFICATION : PS-99020-0087
 4. PACKAGING SPECIFICATION : PK-3002-002
 5. HOUSING SUITABLE FOR (1.14±0.15)/.045±.006 RD OR SQ. PINS
 6. HOOKS AVAILABLE ON ENDS ONLY
 7. THIS PART CONFORMS TO CLASS B REQUIREMENTS OF COSMETIC SPECIFICATION PS-45499-002
 8. CIRCUIT 1 ID. USED TO DEFINE VOID LOCATION.
 CIRCUIT 1 MAY OR MAY NOT LINE UP WITH CIRCUIT 1 OF MATING PART

ADD PK SPEC	QUALITY SYMBOLS
EC NO: UCP2015-2965	∇=0
DRW:MKPPER 2015/01/22	∇=0
CHKD:JBELL 2015/01/22	∇=0
APPR:SMITH 2015/01/22	
REV	

GENERAL TOLERANCES (UNLESS SPECIFIED)	
mm	INCH
4 PLACES ± .---	± .---
3 PLACES ± 0.25	± .010
2 PLACES ± 0.35	± .014
1 PLACE ± .---	± .---
0 PLACE ±	±
ANGULAR ± 1/2°	
DRAFT WHERE APPLICABLE MUST REMAIN WITHIN DIMENSIONS	

DIMENSION STYLE		SCALE	DESIGN UNITS	THIRD ANGLE PROJECTION
MM/IN		5:1	METRIC	⊙ □
DRAWN BY	DATE	TITLE		
P MOORE	1998/09/14	KONEKTCON & P.C. TAIL TERMINAL ASSEMBLY (5.08)/.200 PITCH		
CHECKED BY	DATE	molex		
MGOONEY	1999/03/08			
APPROVED BY	DATE	MATERIAL NO.	DOCUMENT NO.	SHEET NO.
MWILHITE	1999/03/08	SEE CHART	SDAE-3002-NC-*	1 OF 2

DRAWN BY		DATE	TITLE	
P MOORE		1998/09/14	KONEKTCON & P.C. TAIL TERMINAL ASSEMBLY (5.08)/.200 PITCH	
CHECKED BY		DATE	molex	
MGOONEY		1999/03/08		
APPROVED BY		DATE	MATERIAL NO.	DOCUMENT NO.
MWILHITE		1999/03/08	SEE CHART	SDAE-3002-NC-*
MATERIAL NO.		DOCUMENT NO.	SHEET NO.	
SEE CHART		SDAE-3002-NC-*	1 OF 2	